

DC SPUR GEAR MOTOR DM-25RS385

典型应用/Typical applications :
 自动快锁门、装订机、自动电视架、点钞机、聚光灯、卫生纸机、
 办公设备、家用电器、自动执行机构
 Auto shutter, binding machine, automatic TV rack, money counter,
 spotlight, tissue machine, office equipments, household appliances,
 automatic actuator

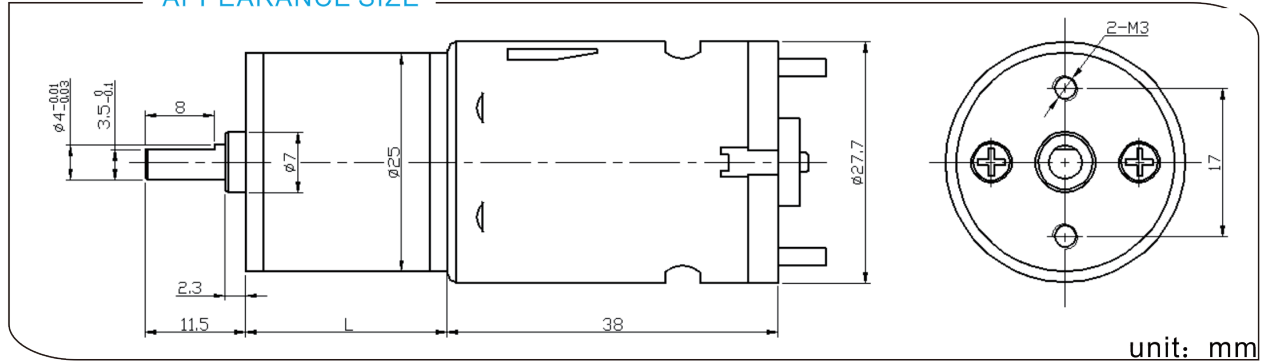

APPEARANCE SIZE



齿轮箱参数/Gearbox Data:

级数 Number of stages	3	4	5	6	7	8
减数比 Reduction Ratio i	9.3、10、11.5	20.4、21、23、25、28	45、55.4、62、69	86、99、110、122、135.5	217、241、268、409	478、531、590、656、729
齿轮箱长度 Gearbox Length L (mm)	17	19	21	23	25	27
破坏扭力 Breaking Torque(kgf.cm)	6	8	10	12	14	14
齿轮箱效率 Gearbox Efficiency η	73%	65%	59%	53%	48%	43%

电机参数/Driving Motor Data:

DC Motor Model	Rated	No Load		Max Efficiency Load			Stall		
	电压	电流	转速	电流	转速 (nm)	扭矩 (tm)	功率	扭矩	电流
	Volt.	Current	Speed	Current	Speed	Torque	P.out	Torque	Current
	V	mA	r/min	mA	r/min	gf.cm	W	gf.cm	mA
DM-385-012-3000	12	≤60	3000	≤150	2200	35	0.8	≥110	≥360
DM-385-012-4500	12	≤70	4500	≤300	3300	55	1.9	≥210	≥960
DM-385-012-6000	12	≤100	6000	≤600	4500	80	3.7	≥280	≥1600
DM-385-024-3000	24	≤28	3000	≤70	2200	35	0.8	≥110	≥160
DM-385-024-4500	24	≤50	4500	≤150	4500	55	1.9	≥180	≥380

减数电机参数/Geared Motor Data :

Gear Motor Model	额定电压 Rated voltage	No load		Max Efficiency Load			Stall		
		电流	转速	电流	转速 (nm)	扭矩 (tm)	功率	扭矩	电流
		Current	Speed	Current	Speed	Torque	P.out	Torque	Current
	V	A	r/min	A	r/min	kgf.cm	W	kgf.cm	A
DM-25RS385-4.54500-122K	4.5	0.21	39.9	0.79	31.4	3.0	0.96	14	2.92
DM-25RS385-7.49000-20.4K	7.4	0.29	427.9	1.05	345.0	0.7	2.49	3.62	4.21
DM-25RS385-0129000-20.4K	12	0.14	432	0.67	351.2	0.94	3.38	5.01	2.94
DM-25RS385-01210500-35.8K	12	0.18	287.8	0.92	233.0	1.9	4.45	9.8	4.09

电机参数仅供参考, 请以实际样板为准; 可以依据客户要求定制参数。
 The motor parameters are for reference only, please refer to real measured data;
 We can customize parameters according to customer requirements.
 减数电机输出转速=直流电机输出转速/齿轮箱减数比; 减数电机输出扭矩=直流电机输出扭矩*齿轮箱减数比*齿轮箱传动效率。
 Gear Motor Output Speed=DC Motor Speed/Gear Ratio (n=n_m/i)
 Gear Motor Output Torque=DC Motor Torque*Gear Ratio*Gearbox Efficiency. (t=t_m*i*η)