

**特性**

- 40A触点切换能力
- 触点与线圈间介质耐压2.5KV, T型4KV
- 塑封型和防尘型可供选择
- 印制板式引出脚和快连接引出脚
- UL绝缘等级: F级绝缘等级可供选择
- 外形尺寸: (32.4×27.3×27.8)mm

**触点参数**

|          |                           |
|----------|---------------------------|
| 触点形式     | 1A,1B or 1C               |
| 接触电阻     | ≤100mΩ ( 1A 6VDC )        |
| 触点材料     | 银合金                       |
| 触点负载(阻性) | 30A/40A 250VAC 40A 277VAC |
| 最大切换额定电压 | 277VAC                    |
| 最大切换额定电流 | 40A                       |
| 最大切换额定功率 | 11080VA                   |
| 机械耐久性    | 1,000,000次                |
| 电耐久性(阻性) | 100,000次(1s通9s断)          |

**性能参数**

|             |                |                      |
|-------------|----------------|----------------------|
| 绝缘电阻        | 1000MΩ(500VDC) |                      |
| 介质耐压        | 线圈与触点间         | 2500VAC/4000VAC 1min |
|             | 断开触点间          | 1500VAC 1min         |
| 动作时间(额定电压下) | ≤15ms          |                      |
| 释放时间(额定电压下) | ≤10ms          |                      |
| 抗振动         | 稳定性            | 10Hz ~ 55Hz 1.5mm    |
|             | 强度             | 10Hz ~ 55Hz 1.5mm    |
| 抗冲击         | 稳定性            | 10G Min              |
|             | 强度             | 100G Min             |
| 湿度          | 5% ~ 85%Rh     |                      |
| 温度范围        | -40°C ~ 85°C   |                      |
| 引出端形式       | PCB            |                      |
| 重量          | 约25g           |                      |

**线圈规格表**

温度：23°C

| 额定电压 (VDC) | 额定电流 ±%(mA) | 线圈电阻 ±10%(Ω) | 最大连续外加电压  | 吸合电压 (Max) | 释放电压 (Min) | 线圈额定功率 (W) |
|------------|-------------|--------------|-----------|------------|------------|------------|
| 5          | 180         | 27.78        | 额定电压的130% | 额定电压的75%   | 额定电压的10%   | 0.9        |
| 6          | 150         | 40           |           |            |            |            |
| 9          | 100         | 90           |           |            |            |            |
| 12         | 75          | 160          |           |            |            |            |
| 18         | 50          | 360          |           |            |            |            |
| 24         | 37.5        | 640          |           |            |            |            |
| 48         | 18.75       | 2560         |           |            |            |            |
| 110        | 8.19        | 13444.45     |           |            |            |            |
| 5          | 280         | 17.86        | 额定电压的130% | 额定电压的75%   | 额定电压的10%   | 1.4        |
| 6          | 233.34      | 25.72        |           |            |            |            |
| 9          | 155.56      | 57.86        |           |            |            |            |
| 12         | 116.67      | 102.86       |           |            |            |            |
| 18         | 77.78       | 231.43       |           |            |            |            |
| 24         | 58.34       | 411.43       |           |            |            |            |
| 48         | 29.17       | 1645.72      |           |            |            |            |
| 110        | 12.73       | 8642.86      |           |            |            |            |

**安规认证**

| 认证类别 | CQC                                    | TUV  | UL   |
|------|--|--|--|
| 证书号  | CQC09002029470                         | R 50163611   | E321783  |
| 负载要求 | 30A 250VAC<br>2HP 250VAC<br>40A 250VAC | 40A 240VAC cos phi=1(A型)<br>40A 14VDC L/R=0ms(A型)<br>30A 240VAC cos phi=1(B型)<br>30A 14VDC L/R=0ms(B型)<br>NO/NC:40A/30A 240VAC cos phi=1<br>NO/NC:40/30A 14VDC L/R=0ms | 40A 277VAC(1form A)<br>1.5HP 277VAC(1form A)<br>2HP 240VAC(1form A)<br>30A 277VAC(1form B,1form C,NC)<br>30A 125/250/277VAC(1formA,1formC,NO)<br>TV-5 120VAC(1formC,NC,1formB)<br>TV-10 120VAC(1formC,NO,1formA) |

**GK-D 命名规则**

GK-D -1C -12 D H G A D C F XXX

特殊说明：字母或数字--特殊说明,  
T--环境温度105°C

绝缘等级：无--Class B ; F-- Class F

密封方式：无--塑封防尘型 ; C--全密封型 ; S--防爆型

IP/OP耐压强度：无--≥2500V ; D--≥4000VAC

端脚吊孔形式：无--标准吊孔 ; A--大吊孔 ; B--无吊孔

触点间隙 ( GAP) : 无--标准型 ; G--GAP≥1.5mm(适用于1.4W)

触点负载：无--30A ; H--40A

线圈功率：D--0.9W ; D3--1.4W

线圈额定电压 ( VDC ) : 5 , 6 , 9 , 12 , 18 , 24 , 48 , 110

触点形式：1A--1组常开型 ; 1B--1组常闭型 ; 1C--1组转换型

型号：GK-D

**外形图**

**单位:mm**

**常规吊孔**

**大吊孔**

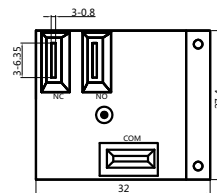
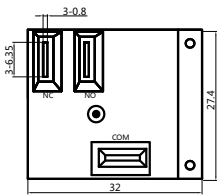
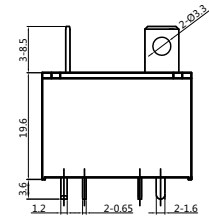
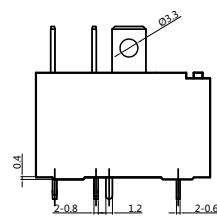
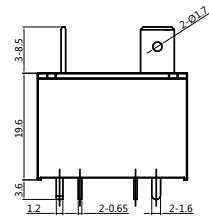
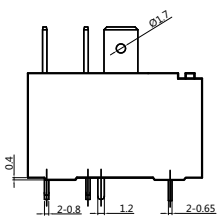

**高壳**

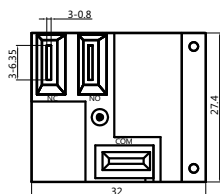
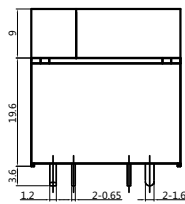
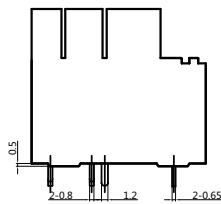

注：产品部分外形尺寸未注尺寸公差，  
当外形尺寸 < 1mm，公差为±0.2mm；  
当外形尺寸在1~5mm之间时，公差为±0.3mm；  
当外形尺寸 > 5mm，公差为±0.4mm。

接线图

单位:mm

GK-D-1A

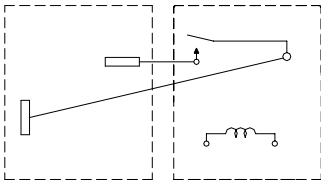

顶视图 底视图

GK-D-1B

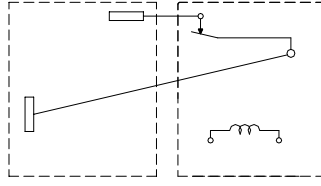

顶视图 底视图

GK-D-1C

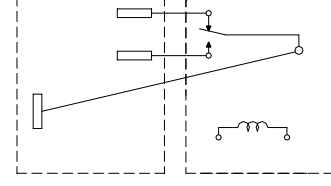

顶视图 底视图

安装孔尺寸图 (底视图)

单位:mm

GK-D-1A

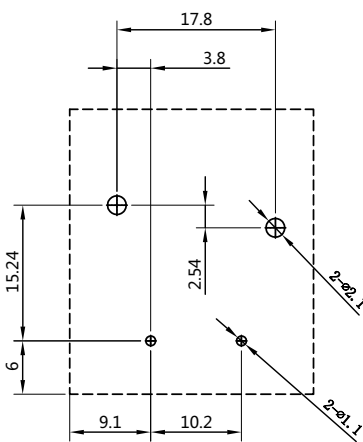

GK-D-1B

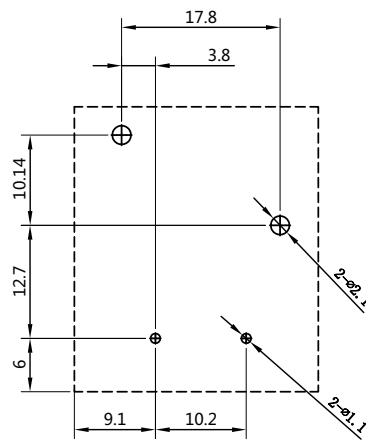

GK-D-1C

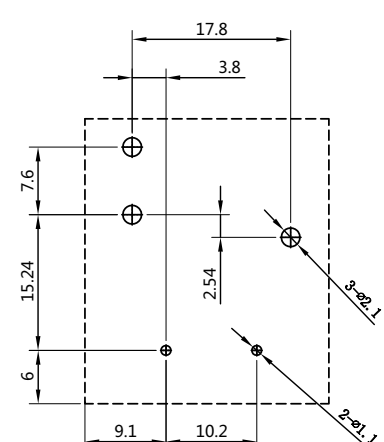

注：引出端子尺寸为预焊前尺寸；安装孔尺寸公差：±0.1mm。

性能曲线图

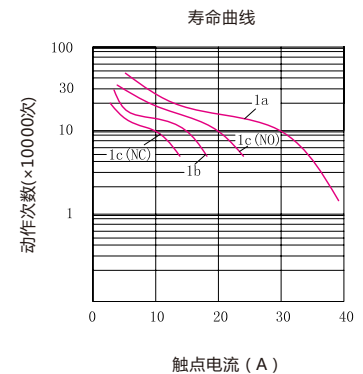
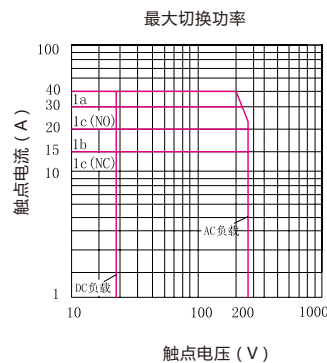
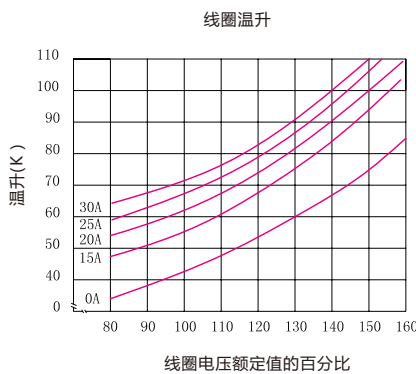

声明:

本产品规格书仅供客户使用时参考,若有更改,恕不另行通知。

对高登而言,不可能评定继电器在每个具体应用领域的所有性能参数要求,因而客户应该根据具体的使用条件选择与之相配的产品,若有疑问,请与高登联系获取更多的技术支持,但是产品选型责任由客户负责。

©深圳高登电科股份有限公司版权所有,本公司保留所有权利。



### Characteristics

- 40A contact switching capability
- The dielectric withstand voltage between contact and coil is 2.5KV, T-type 4KV
- Printed board-type lead-out pins and quick-connect lead-out pins
- Dimensions: (32.4× 27.3× 27.8) mm

### Contact parameter

|                                  |                                 |
|----------------------------------|---------------------------------|
| Contact form                     | 1A,1B or 1C                     |
| Contact resistance               | ≤100mΩ(1A 6VDC)                 |
| Contact material                 | Silver alloy                    |
| Contact load (resistance)        | 30A/40A 250VAC 40A 277VAC       |
| Maximum switching rated voltage  | 277VAC                          |
| Maximum switching current rating | 40A                             |
| Maximum switching power rating   | 11080VA                         |
| Mechanical durability            | 1,000,000 times                 |
| Electrical durability(resistive) | 100,000次 times ( 1s on 9s off ) |

### Performance parameter

|                                   |                         |                      |
|-----------------------------------|-------------------------|----------------------|
| Insulation resistance             | 1000MΩ(500VDC)          |                      |
| Dielectric withstand voltage      | Coil and contact        | 2500VAC/4000VAC 1min |
|                                   | Disconnect the contacts | 1500VAC 1min         |
| Operating time (at rated voltage) | ≤15ms                   |                      |
| Release time (at rated voltage)   | ≤10ms                   |                      |
| Vibration resistant               | Malfunction             | 10Hz~55Hz 1.5mm      |
|                                   | Durability              | 10Hz~55Hz 1.5mm      |
| Impact resistance                 | Malfunction             | 10G Min              |
|                                   | Durability              | 100G Min             |
| humidity                          | 5%~85%Rh                |                      |
| temperature range                 | -40°C~85°C              |                      |
| Terminal form                     | PCB                     |                      |
| weight                            | About 25g               |                      |

| Coil parameter        |                      |                         | Temperature: 23°C                  |                       |                       |                      |
|-----------------------|----------------------|-------------------------|------------------------------------|-----------------------|-----------------------|----------------------|
| Nominal Voltage (VDC) | Rated current ±%(mA) | Coil resistance ±10%(Ω) | Maximum continuous applied voltage | Pull-in voltage (Max) | Release voltage (Min) | Coil rated power (W) |
| 5                     | 180                  | 27.78                   | 130% of rated voltage              | 75% of rated voltage  | 10% of rated voltage  | 0.9                  |
| 6                     | 150                  | 40                      |                                    |                       |                       |                      |
| 9                     | 100                  | 90                      |                                    |                       |                       |                      |
| 12                    | 75                   | 160                     |                                    |                       |                       |                      |
| 18                    | 50                   | 360                     |                                    |                       |                       |                      |
| 24                    | 37.5                 | 640                     |                                    |                       |                       |                      |
| 48                    | 18.75                | 2560                    |                                    |                       |                       |                      |
| 110                   | 8.19                 | 13444.45                |                                    |                       |                       |                      |
| 5                     | 280                  | 17.86                   | 130% of rated voltage              | 75% of rated voltage  | 10% of rated voltage  | 1.4                  |
| 6                     | 233.34               | 25.72                   |                                    |                       |                       |                      |
| 9                     | 155.56               | 57.86                   |                                    |                       |                       |                      |
| 12                    | 116.67               | 102.86                  |                                    |                       |                       |                      |
| 18                    | 77.78                | 231.43                  |                                    |                       |                       |                      |
| 24                    | 58.34                | 411.43                  |                                    |                       |                       |                      |
| 48                    | 29.17                | 1645.72                 |                                    |                       |                       |                      |
| 110                   | 12.73                | 8642.86                 |                                    |                       |                       |                      |

| Safety certification   |  |  |  |
|------------------------|--|--|--|
| Certification category | CQC                                    | TUV  | UL   |
| Certificate No         | CQC09002029470                         | R 50163611   | E321783  |
| Load requirement       | 30A 250VAC<br>2HP 250VAC<br>40A 250VAC | 40A 240VAC cos phi=1(A型)<br>40A 14VDC L/R=0ms(A型)<br>30A 240VAC cos phi=1(B型)<br>30A 14VDC L/R=0ms(B型)<br>NO/NC:40A/30A 240VAC cos phi=1<br>NO/NC:40/30A 14VDC L/R=0ms | 40A 277VAC(1form A)<br>1.5HP 277VAC(1form A)<br>2HP 240VAC(1form A)<br>30A 277VAC(1form B,1form C,NC)<br>30A 125/250/277VAC(1formA,1formC,NO)<br>TV-5 120VAC(1formC,NC/1formB)<br>TV-10 120VAC(1formC,NO,1formA) |

**GK-D naming rules**

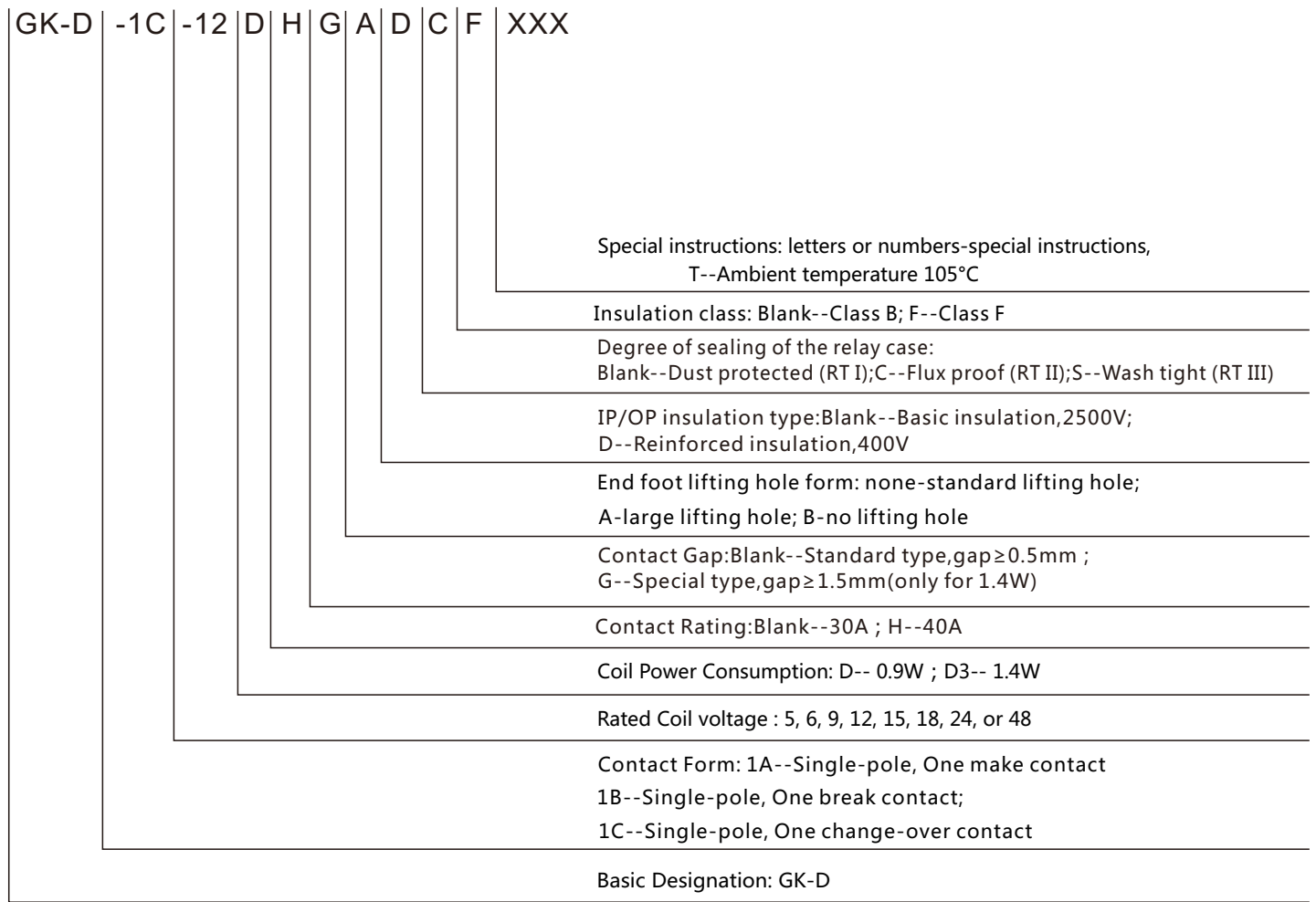

**Outline drawing**

**Unit: mm**

High shell

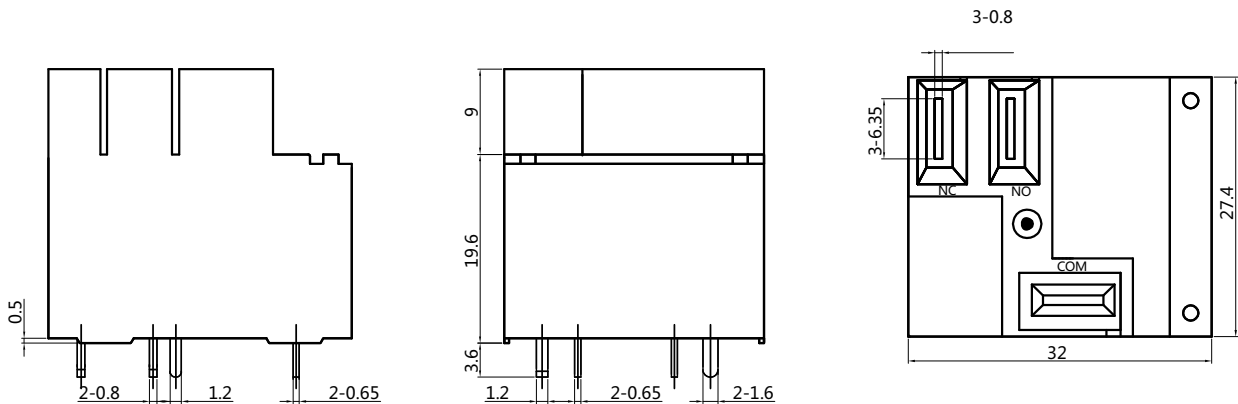

Outline drawing

Unit: mm

Standard lifting hole

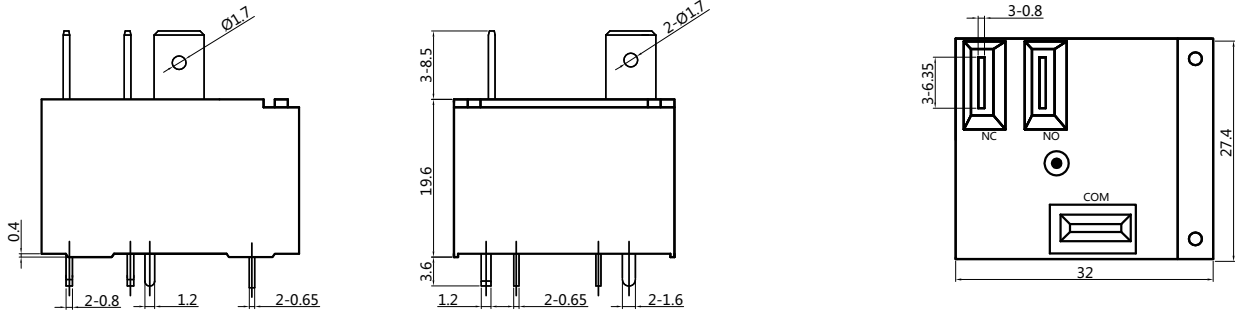

Big hanging hole

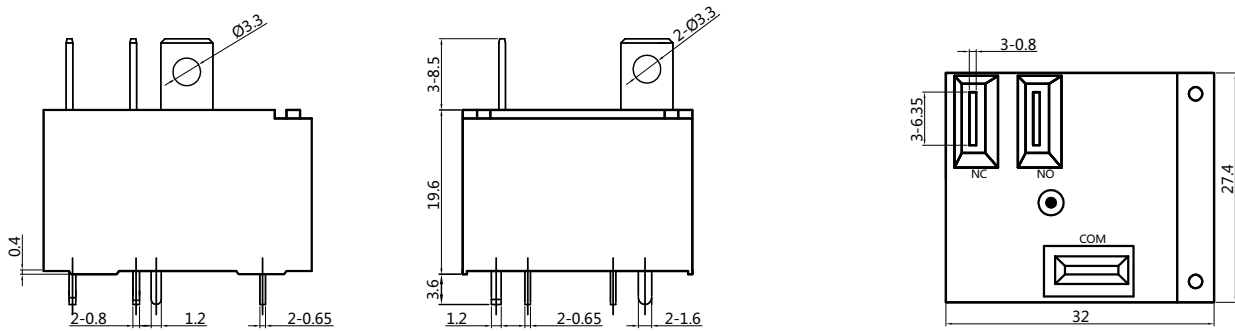

Note: Part of the product has no tolerances on the external dimensions.

When the external dimensions are less than 1mm, the tolerance is  $\pm 0.2\text{mm}$ ;

When the external dimension is between 1~5mm, the tolerance is  $\pm 0.3\text{mm}$ ;

When the external dimension  $> 5\text{mm}$ , the tolerance is  $\pm 0.4\text{mm}$ .

Wiring diagram

Unit: mm

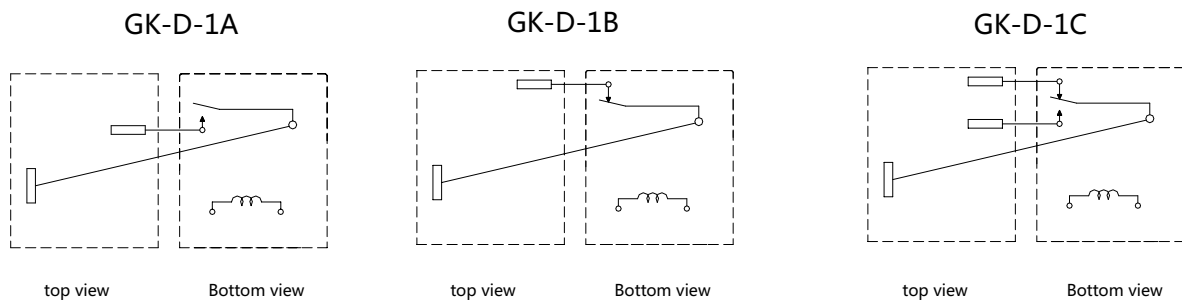



Mounting hole size (bottom view)

Unit: mm

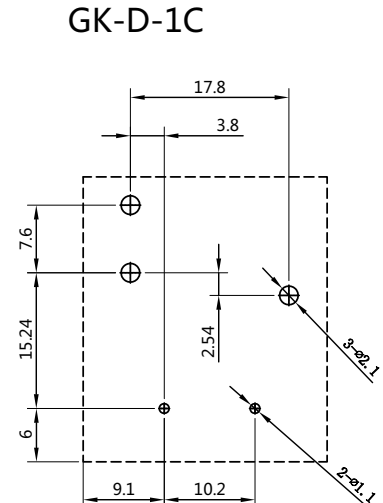
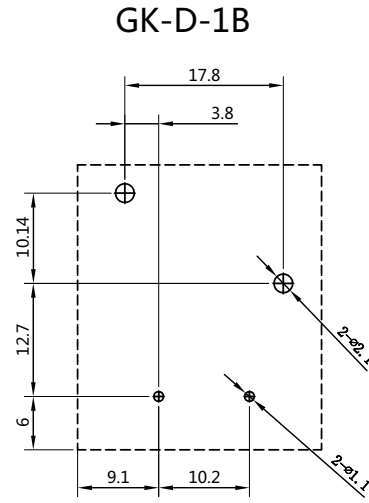
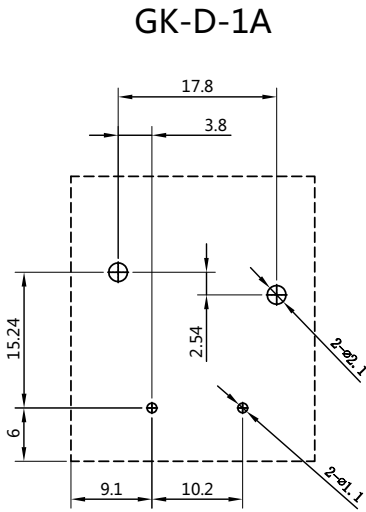

Note: The size of the lead terminal is the size before pre-welding; the size tolerance of the mounting hole:  $\pm 0.1\text{mm}$ .

Performance graph

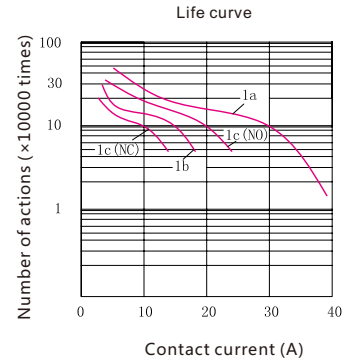
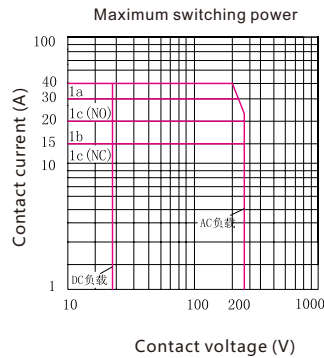
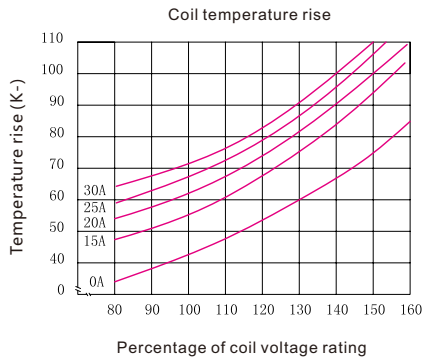

statement:

This product specification is only for reference when customers use it, and subject to change without notice.

For Gordon, it is impossible to evaluate all the performance parameter requirements of the relay in each specific application field. Therefore, the customer should choose the product that matches it according to the specific use conditions. If you have questions, please contact Gordon for more technical support, but the customer is responsible for product selection.

©Shenzhen Gordon Electronics Co., Ltd. All rights reserved. All rights are reserved by the company.