



## S12

### Applications

- Dining bar
- Meeting room
- Classroom

### Feature

- Use a high efficiency 12" ferrite bass unit
- Excellent sound performance
- 2 PIN WP PLUG

### Technical specification

- FREQUENCY RESPONSE: 65Hz - 200Hz ( ± 3dB) 50Hz - 150Hz ( -10 dB)
- NOMINAL COVERAGE<sup>(±dB)</sup>: Omnidirectional
- SENSITIVITY(@1w/1m) 94 dB SPL
- POWER RATING(AES): 450W
- NOMINAL IMPEDANCE 8 ohm
- MAXIMUM SPL: 120 dB SPL, 126 dB SPL peak
- DRIVERS: 1 x 12" ferrite bass(75mm voice coil)

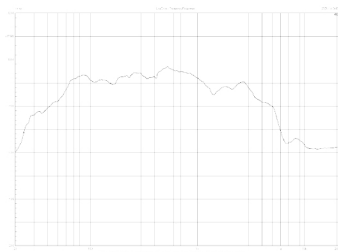

Frequency response

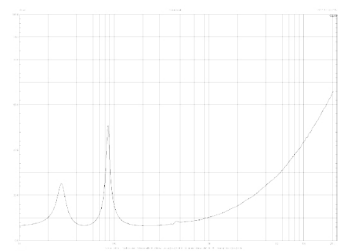

Impedance

### Physical data

- DIMENSIONS(HxWxD) 365 x 365 x 400mm
- WEIGHT: 15 kg
- CONNECTORS: 2 pin WP plug
- MATERIALS: 15mm Aluminum
- FINISH: Black Polyurea paintings
- GRILLE: Black epoxy mesh grille with acoustically reticulated cloth

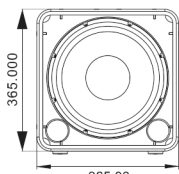

Front

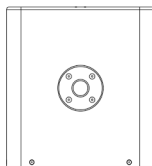

Top

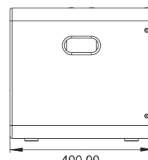

Side