



天津飞敏机械有限公司
TIANJIN FEIMIN MECHANICAL CO.,LTD.

地址:天津市武清区汉沽港镇
自行车王国产业园区兴国路19号
Tel:0086-22-59621696
Fox:0086-22-59621698
Mobile:(0)-1502252240(李)

飞敏深圳办事处
FEIMIN SHENZHEN OFFICE

地址:深圳市光明新区新湖街道楼明路207号
飞黄达科技后栋7H-1
Tel:0086-0755-29090302
Fox:0086-0755-29090302
Mobile:(0)-13823667100(欧阳)

飞敏上海办事处
FEIMIN SHANGHAI OFFICE

地址:昆山市陆家镇南木瓜路木瓜小区东区68号
Tel:0086-512-57286032
Fox:0086-21-51079560
Mobile:(0)-13867835923(卢)

宁波巨隆机械股份有限公司
NINGBO JULONG MACHINERY CO.,LTD.

地址:中国宁波市江北区振甬路89号南门
Add: NO.89 Zhenyong Road, Jiangbei, Ningbo, China
Tel:0086-57487633188
Fox:0086-57487633388
E-mail: feimin@chinafeimin.com
Http://www.cn-jialong.com

FEIMIN
www.cn-jialong.com



飞敏美国服务中心
FEIMIN SERVICE CENTER(USA)

地址:2477 Gablewood Drive NE, Marietta, GA 30062
Tel:+1-(678)907-3228(Mathew Zhou)

飞敏日本服务中心
FEIMIN SERVICE CENTER(JAPAN)

地址:〒590-0960大阪府堺市堺区少林寺町西2丁1-28
Tel:+81-072-222-1132 (株式会社)
Fox:+81-072-221-0809
E-mail: info@chinos.jp

飞敏欧洲服务中心
FEIM SERVICE CENTER(EUROPE)

地址:Al.Solidarnosci 117 lok.20700-140Warszawa
Tel:+48 577 012511(Thomsz Zawadzki)
E-mail: t.zawadzki@runtobike.com

JULONG 2022 Catalogue

MACHINERY

PEDALS | HEADSETS | BOTTOM BRACKETS

ISO9001:2015



ABOUT US

Ningbo Jialong Industrial Co.,Ltd. is made up of three companies, Feimin Bicycle Parts, Ningbo Jialong Industrial Co., Ltd, and Technology Service Co., Ltd. Among them, Feimin Bicycle Parts is the professional manufacture of bicycle pedals, headsets, B.B axles and B.B parts.

In 2012, China Feimin celebrated the opening of a updated factory, where we have bigger manufacturing area, so that if can conbute to diversified products as to customers needs. Our products are produced and inspected according to the intemational standards, and our products have met K MARK certificate of Gemany and passed JIS test of Japan.

We moved forward with desire to offer the best service and

会社概要

寧波巨隆機械株式会社は、1996年に設立され、ペダル、ヘッドセット、BBとBBパーツの専門メーカーです。会社はすでに国際品質体系標準的なISO9001-2015、TS16949の認定を獲得おり、製品はドイツのK-MARK、TUV、EN フランスのTPL、オーストラリアのASと日本のJISの規格に通した。

嘉隆は「中国の飛敏は着実だ」という企業精神の指導で、精密な生産設備、堅実な管理体制と高品質管理のポロプログラムを結び付けて、製品のデザインは良く、多種多様が揃っています、品質安定、

customerized products. We are always on the way to improve ourselves, so that we can satisfy our great customers needs. Meanwhile, we wi try our best to develop more innovative products for our great customers.

We exert the advanced intemational technique. Our products are not only on hot sales in domestic markets, but also sold around the world, including the United States, Germany, Netheriands, totally 35 countries and regions With the increasing needs from the customer, our manufacturing scale also develops steadily. Nowadays, in order to adapt to the development tendency, we have set some branches, and our branches cover all the motherland and some branches abroad are in the plan. We are always here for you.

顧客広範な信頼と支持を勝ち取つて、しかも海外、国内の30余国家と地域に良く売られ、特に米国、日本とヨーロッパに優れております「お客様の要求、私達の追求」という事をもつとよいやり遂げた為、嘉隆は寧波の寧海、寧波鎮海、深圳、上海、天津とヨーロッパにすでに支社を設立し、活動の拠点を広げ事業展開を行つています。飛敏は自転車専門を受けてその通りにし、開拓革新し、顧客に安心、安全で心地良い製品を供給する為に弛まず頑張りぬく奮闘。



Enjoy Work
Enjoy Learning
Enjoy Life



Contents

PEDALS

- 01-02 ZP-SYSTEM
- 03-05 ZU-SYSTEM
- 06 FOLDING
- 07-08 MTB
- 09 BMX
- 10 PEDALS
- 11-12 COMFORT
- 13-14 EXERCISE
- 15-16 CHILDREN`S

HEADSETS

- 17-18 ENGINEERING PLASTIC TOP WASHER
- 19 LOCK HEADSETS
- 20-21 1-1/8" & 1-1/2"
- 22-23 1-1/8" & 1-1/4"
- 24-28 1-1/8"
- 29-30 1"
- 31-36 **BOTTOM BRACKETS**
- 37-38 **ACCESSORIES**

Icon Element Corresponding To The Table

- MTB
- COMFORT
- BMX
- EXERCISE
- BEARING STRUCTRE
- ZU STRUCTURE
- ROAD
- FOLDING
- CHILDREN`S





PEDALS ZP-SYSTEM

※ High end OEM case strategic system

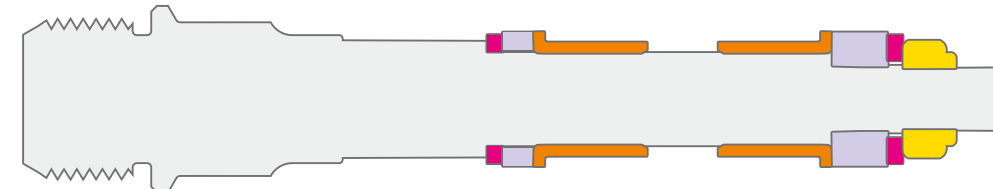

- 01** Better rotation feeling comes from the unique structure design.
- 02** 500 000 rotation lifetime refreshed the definition of the OEM case.

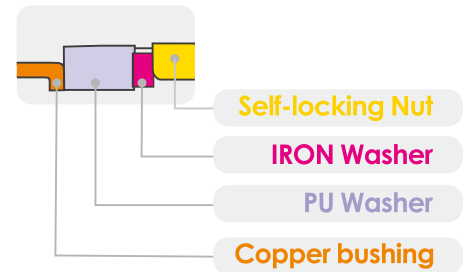

FP-212ZP

Body: ZP-02 body w/inlaid non-slip
Spindle: Boron
Bearing: ZP bearing
Seal: 1Rubber
Size: 105.7×78.4mm
Weight: 264g
Body: A B C D E F G
Non-sip: B F



FP-203ZP

Body: Aluminum
Spindle: Boron
Bearing: ZP bearing
Size: 111.3x101mm
Weight: 359g/pr
Pin: Replaceable straight pins



FP-923ZP

Body: Aluminum/inlaid PP
Spindle: Boron
Bearing: ZP bearing
Size: 107x92mm
Weight: 335g/pr



FP-870ZP

Body: ZP-02
Spindle: Boron
Bearing: ZP bearing
Size: 104×93mm
Weight: 278.5g/pr
Pin: Replaceable straight pins



FP-897ZP

Body: ZP-02
Spindle: Boron
Bearing: ZP bearing
Size: 116×105mm
Weight: 250g/pr



FP-930ZP

Body: Aluminum body w/PP cage & inlaid non-slip
Spindle: Boron
Bearing: ZP bearing
Size: 104x73mm
Weight: 311g/pr



FP-975ZP

Body: Aluminum
Cage: Aluminum
Spindle: Boron
Bearing: ZP bearing
Size: 108×79mm
Weight: 316g/pr



FP-953ZP

Body: Aluminum
Cage: Aluminum/<Steel>
Spindle: Boron
Bearing: ZP bearing
Size: 107.3×95.2mm
Weight: 385g/pr/<465g/pr>



FP-877ZP

Body: ZP-02
Spindle: Boron
Bearing: ZP bearing
Size: 104.7×108mm
Weight: 279g/pr



PEDALS ZU-SYSTEM

※ High end OEM case strategic system

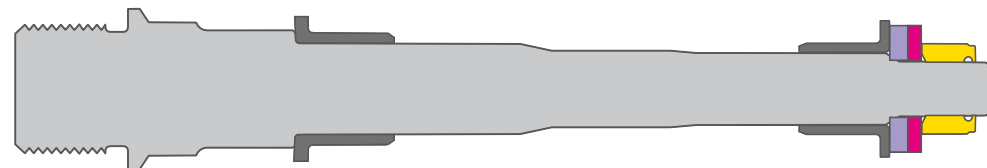

01 Better rotation riding feeling based on patent rotation system.

02 100% improved lifetime than industry standard.

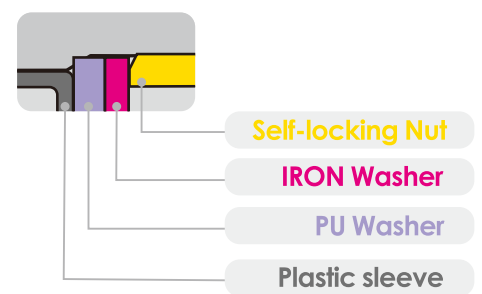

FP-837ZU  

Body: One-piece pp
Spindle: Boron
Bearing: ZU bearing
Size: 99×88mm
Weight: 235.6g/pr



FP-896ZU  

Body: ZP-02
Spindle: Boron
Bearing: ZU bearing
Size: 108.5×98.1mm
Weight: 355g/pr



FP-872BZU  

Body: One-piece pp
Spindle: Boron
Bearing: ZU bearing
Size: 110×85mm
Weight: 232g/pr

FP-893ZU  

Body: One-piece pp
Spindle: Boron
Size: 111×89mm
Weight: 275g/pr



Human Mechanism Pedal.

-  **Ergonomics**
Based on the foot pressure analyst and on riding, the best solution to the city riding.
-  **Riding Guiding System**
Inner Concave stop design adjust riding function will provide new guide for riding.
-  **Concave riding design**
Concave design provide the more comfortable riding flat.
-  **Combination Non-Slip**
Unique texture design and High functional sand paper combination to provide the amazing anti-slippery performance.



FP-831ZU  

Body: One-piece pp w/ inlaid non-slip
Spindle: Boron
Bearing: ZU bearing
Size: 105×80mm
Weight: 250.2g/pr



FP-872ZU  

Body: One-piece PP w/inlaid non-slip
Spindle: Boron
Bearing: ZU bearing
Size: 107.8×81mm
Weight: 238g/pr



FP-972ZU  

Body: One-piece aluminum w/inlaid non-slip
Spindle: Boron
Bearing: ZU bearing
Size: 109×83.2mm
Weight: 348.5g/pr



FP-883ZU  

Body: One-piece PP w/inlaid non-slip
Spindle: Boron
Bearing: ZU bearing
Size: 111.1×97mm
Weight: 317.7g/pr



FP-873ZU  

Body: One-piece PP
Spindle: Boron
Bearing: ZU bearing
Size: 104×95.5mm
Weight: 245g/pr



FP-803ZU 

Body: One-piece PP
Spindle: Boron
Bearing: ZU bearing
Size: 108.8×104mm
Weight: 380g/pr



NEW!

FP-869ZU 

Body: One-piece PP
Spindle: Boron
Bearing: ZU bearing
Size: 101×89.6mm
Weight: 236.8g/pr



FP-913ZU 

Body: Aluminum
Spindle: Boron
Bearing: ZU bearing
Size: 105.5×98mm
Weight: 352.8g/pr

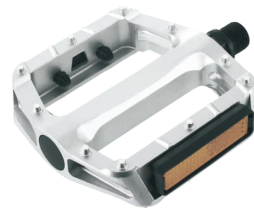

FP-969ZU 

Body: Aluminum
Spindle: Boron
Bearing: ZU bearing
Size: 100×93mm
Weight: 347.6g/pr



NEW!

FP-989ZU 

Body: Aluminum
Spindle: Boron
Bearing: ZU bearing
Size: 109×110mm
Weight: 423.6g/pr



FP-980AZU 

Body: Aluminum
Cage: Steel
Spindle: Boron
Bearing: ZU bearing
Size: 99×77.5mm
Weight: 330g/pr



FP-988ZU 

Body: Aluminum
Cage: Aluminum
Spindle: Boron
Bearing: ZU bearing
Size: 97.5×78mm
Weight: 281g/pr



FP-982ZU 

Body: Aluminum
Cage: Aluminum
Spindle: Boron
Bearing: ZU bearing
Size: 89.6×78.5mm
Weight: 265g/pr



FP-878ZU 

Body: One-piece pp
Spindle: Boron
Bearing: ZU bearing
Size: 99.5×116.5mm
Weight: 243.9g/pr

THE FIRST FOLDING PEDAL PASS THE ISO 4210 STANDARD



FP-871ZU 

Body: One-piece PA
Cage: One-piece PA
Spindle: Boron
Bearing: ZU bearing
Size: 101.5×73.5mm
Weight: 294g/pr



FP-875AZU 

Body: Aluminum
Cage: ZP-02
Spindle: Boron
Bearing: ZU bearing
Size: 103.5×73.5mm
Weight: 339.4g/pr



FP-907ZU 

Body: Aluminum
Cage: Aluminum
Spindle: Boron
Bearing: ZU bearing
Size: 109.5×80.6mm
Weight: 352g/pr

Produkte Products		TÜVRheinland®	
Prüfbericht-Nr.: Test Report No.:	15092469 001	Auftrags-Nr.: Order No.:	1200300497
Kunden-Referenz-Nr.: Client Reference No.:	632762	Auftragsdatum: Order date:	14.01.2016
Auftraggeber: Client:	Ningbo Julong Machinery Co., Ltd South Gate No.89 Zhen Yong Road, JiangBei District, Ningbo zhejiang P.R. China		
Prüfgegenstand: Test item:	Bicycle pedal		
Bezeichnung / Typ-Nr.: Identification / Type No.:	871		
Auftrags-Inhalt: Order content:	Test of selected parameters		
Prüfungslage: Test specification:	ISO 4210-2:2015 Clause 4.13.3&4.13.4&4.13.5 Cycles - Safety requirements for bicycles - Part 2: Requirements for city and trekking, young adult, mountain and racing bicycles		
Wareneingangdatum: Date of receipt:	11.01.2016		
Prüfmuster-Nr.: Test sample No.:	1200300497-1		
Prüfzeitraum: Testing period:	11.01.2016 – 14.01.2016		
Ort der Prüfung: Place of testing:	Bicycle lab		
Prüflaboratorium: Testing laboratory:	TÜV Rheinland Antaeon (Kunshan) Co., Ltd.		
Prüfergebnis: Test result:	Pass		
geprüft von / tested by:	14.01.2016 Nan Jiang/ PE		kontrolliert von / reviewed by:
Datum Date	Name / Stellung Name / Position	Unterschrift Signature	Datum Date
Sonstiges / Other:			
Zustand des Prüfgegenstandes bei Anlieferung: Condition of the test item at delivery:	Prüfmuster vollständig und unbeschädigt Test item complete and undamaged		
<p>* Legende: 1 = sehr gut 2 = gut 3 = befriedigend 4 = ausreichend 5 = mangelhaft (Pass) = entspricht o.g. Prüfgrundlage(n) (Fail) = entspricht nicht o.g. Prüfgrundlage(n) N/A = nicht anwendbar NT = nicht getestet Legend: 1 = very good 2 = good 3 = satisfactory 4 = sufficient 5 = poor (Pass) = passed a.m. test specification(s) (Fail) = failed a.m. test specification(s) N/A = not applicable NT = not tested</p>			
<p>Dieser Prüfbericht bezieht sich nur auf das o.g. Prüfmuster und darf ohne Genehmigung der Prüfstelle nicht auszusweise vervielfältigt werden. Dieser Bericht berechtigt nicht zur Verwendung eines Prüfzeichens. This test report only relates to the a. m. test sample. Without permission of the test center this report is not permitted to be duplicated in extracts. This test report does not entitle to carry any test mark.</p>			
<p>TÜV Rheinland Antaeon (Kunshan) Co., Ltd. - Building 4, No. 38, Jingfan Road, Baoheng Town - Kunshan City - 215311 P.R. China Tel.: +86 512 8616 0058 - Fax: +86 512 8616 0078 - Mail: service-gc@tuv.com - Web: www.tuv.com</p>			



FP-922



Body: Aluminum
Spindle: Boron
Bearing: Ball bearing
Size: 102×96mm
Weight: 434g/pr



FP-925



Body: Aluminum
Spindle: Boron
Bearing: Ball bearing
Size: 107×89mm
Weight: 404g/pr



FP-960



Body: Aluminum
Spindle: Boron
Bearing: Ball bearing
Size: 101.5×81mm
Weight: 390g/pr



FP-961



Body: Aluminum
Spindle: Boron
Bearing: Ball bearing
Size: 106×77mm
Weight: 377g/pr



FP-976



Body: Aluminum
Cage: Aluminum/<Steel>
Bearing: Ball bearing
Size: 104×81mm
Weight: 383g/pr/<443g/pr>



FP-979



Body: Aluminum
Cage: Aluminum/<Steel>
Spindle: Boron
Bearing: Ball bearing
Size: 115.5×84mm
Weight: 322g/pr/<405g/pr>



FP-973



Body: One-piece PP
Cage: Aluminum/<Steel>
Spindle: Boron
Bearing: Ball bearing
Size: 116.5×83.6mm
Weight: 307g/pr/<391g/pr>



FP-950



Body: One-piece PP
Cage: Steel
Spindle: Boron
Bearing: Ball bearing
Size: 106.3×99mm
Weight: 411.6g/pr



FP-916



Body: One-piece PP
Cage: Aluminum/<Steel>
Spindle: Boron
Bearing: Ball bearing
Size: 105×84mm
Weight: 361g/pr/<386g/pr>



FP-915



Body: One-piece PP
Cage: Steel
Spindle: Boron
Bearing: Ball bearing
Size: 102×77mm
Weight: 380g/pr



FP-906



Body: One-piece PP
Cage: Aluminum/<Steel>
Spindle: Boron
Bearing: Ball bearing
Size: 105×81mm
Weight: 306g/pr/<385g/pr>



FP-917N



Body: One-piece PP
Cage: <Steel>/Aluminum
Spindle: Boron
Bearing: Ball bearing
Size: 101.8×78mm
Weight: 384g/pr/<303g/pr>



FP-803B



Body: One-piece PP
Spindle: Boron
Bearing: Ball bearing/<Ball-less>
Size: 111×96mm
Weight: 330g/pr/<300g/pr>



FP-806B



Body: One-piece PP
Spindle: Boron
Bearing: Ball bearing/<Ball-less>
Size: 106.1×81mm
Weight: 309g/pr/<256g/pr>



FP-808



Body: One-piece PP
Spindle: Boron
Bearing: Ball bearing/<Ball-less>
Size: 109×83mm
Weight: 349g/pr/<296g/pr>



FP-818



Body: One-piece PP
Spindle: Boron
Bearing: Ball bearing/<Ball-less>
Size: 113×82mm
Weight: 333g/pr/<318g/pr>



FP-825A



Body: One-piece PP
Spindle: Boron
Bearing: Ball bearing/<Ball-less>
Size: 109.6×85mm
Weight: 328g/pr/<280g/pr>



FP-801

Body: One-piece PC
Spindle: Boron
Bearing: Ball bearing
Size: 109.3×100mm
Weight: 344g/pr



FP-803

Body: One-piece PP
Spindle: Boron
Bearing: Ball bearing/<Ball-less>
Size: 110.4×104mm
Weight: 317g/pr/<285g/pr>



FP-851

Body: One-piece PA
Bearing: Ball bearing
Size: 109.3×105mm
Weight: 432g/pr



FP-963

Body: Aluminum
Spindle: Boron
Bearing: Ball bearing
Size: 113×112mm
Weight: 461g/pr



FP-965A

Body: Aluminum
Spindle: Boron
Bearing: Ball bearing
Size: 108×100mm
Weight: 438.9g/pr



FP-807B

Body: One-piece PP
Spindle: Boron
Bearing: Ball bearing/<Ball-less>
Size: 108×97mm
Weight: 368g/pr/<292g/pr>



FP-836

Body: One-piece PP
Spindle: Boron
Bearing: Ball bearing/<Ball-less>
Size: 110.5×97.5mm
Weight: 364g/pr/<314g/pr>



FP-853

Body: One-piece PP
Spindle: Boron
Bearing: Ball bearing/<Ball-less>
Size: 110.1×98mm
Weight: 341g/pr/<298g/pr>



FP-850B

Body: One-piece PP
Spindle: Boron
Bearing: Ball bearing/<Ball-less>
Size: 108.9×96mm
Weight: 344g/pr/<324g/pr>



FP-881J

Body: One-piece PP
Spindle: Boron
Bearing: Ball bearing
Size: 111.3×71mm
Weight: 301.2g/pr



FP-882J

Body: One-piece PP
Spindle: Boron
Bearing: Ball bearing
Size: 110.3×77.4mm
Weight: 303.4g/pr

THE SAFER RIDING
 EXPERIENCE FOR TREKKING.

PEDALS

SPECIALLY FOR JAPANESE MARKET

01 VIA approved. Reliable Solution for Japan Market.

02 30% material strength improvement and 20% stronger structure make



NEW!

FP-919



Body: Aluminum w/inlaid non-slip
Spindle: Boron
Bearing: Ball bearing
Size: 106.4×69.5mm
Weight: 407g/pr



FP-920B



Body: Aluminum w/inlaid non-slip
Spindle: Boron
Bearing: Ball bearing
Size: 101×72mm
Weight: 449g/pr



FP-910



Body: Aluminum w/inlaid non-slip
Spindle: Boron
Bearing: Ball bearing
Size: 111×72mm
Weight: 488g/pr



FP-821



Body: One-piece PP w/inlaid non-slip
Spindle: Boron
Bearing: Ball bearing
Size: 110×80mm
Weight: 359g/pr



FP-833



Body: One-piece PP w/inlaid non-slip
Spindle: Boron
Bearing: Ball bearing/<Ball-less>
Size: 109×75mm
Weight: 378g/pr/<351g/pr>



FP-823



Body: One-piece PP w/inlaid non-slip
Spindle: Boron
Bearing: Ball bearing
Size: 108×85mm
Weight: 313g/pr



FP-820



Body: One-piece PP w/inlaid non-slip
Spindle: Boron
Bearing: Ball bearing/<Ball-less>
Size: 111.7×84mm
Weight: 391g/pr/<364g/pr>



FP-830



Body: One-piece PP w/inlaid non-slip
Spindle: Boron
Bearing: Ball bearing/<Ball-less>
Size: 109×70mm
Weight: 366g/pr/<344g/pr>



NEW!

FP-832



Body: One-piece PP
Spindle: Boron
Bearing: Ball bearing
Size: 110.6×104mm
Weight: 332.6g/pr



FP-816



Body: One-piece PP
Spindle: Boron
Bearing: Ball bearing/<Ball-less>
Size: 112×73mm
Weight: 330g/pr/<294g/pr>



FP-820B



Body: One-piece PP
Spindle: Boron
Bearing: Ball bearing/<Ball-less>
Size: 112.1×80mm
Weight: 347g/pr/<266g/pr>



FP-826



Body: One-piece PP
Spindle: Boron
Bearing: Ball bearing/<Ball-less>
Size: 109×72mm
Weight: 337g/pr/<314g/pr>



FP-830C



Body: One-piece PP
Spindle: Boron
Bearing: Ball bearing/<Ball-less>
Size: 110×68mm
Weight: 337g/pr/<313g/pr>



FP-866



Body: One-piece PP
Spindle: Boron
Bearing: Ball bearing/<Ball-less>
Size: 106×102mm
Weight: 348g/pr/<324g/pr>



FP-804



Body: One-piece PP
Spindle: Boron
Bearing: Ball bearing/<Ball-less>
Size: 113×78mm
Weight: 341g/pr/<288g/pr>



FP-810



Body: One-piece PP
Spindle: Boron
Bearing: Ball bearing/<Ball-less>
Size: 108×71mm
Weight: 331g/pr/<295g/pr>

PEDALS EXERCISE

FP-107L

Body: Aluminum
Cage: Nylon
Bearing: Tri-sleeve bearing
Size: 113×102mm
Weight: Ball typr 628g/pr



FP-J965A

Body: Aluminum
Cage: Nylon
Bearing: Ball bearing
Size: 109×152mm
Weight: Ball typr 611g/pr



FP-J008

Body: One-piece PP
Cage: PVC strap
Bearing: Ball bearing
Size: 124×125mm
Weight: Ball typr 880g/pr



FP-J003

Body: One-piece PP w/inlaid non-slip
Cage: PVC strap
Bearing: Ball bearing
Size: 155×143mm
Weight: Ball type 1002g/pr



FP-J022

Body: One-piece PP
Cage: PVC strap
Bearing: Ball bearing
Size: 147×144mm
Weight: Ball type 1024g/pr



FP-J028B

Body: One-piece PP /inlaid non-slip
Cage: PVC strap
Bearing: Ball bearing
Size: 130×148.3mm
Weight: Ball type 970g/pr



FP-J005B

Body: One-piece PP
Cage: PVC strap
Bearing: Ball bearing
Size: 111×52mm
Weight: Ball type 425.4g/pr



FP-J027

Body: One-piece PP w/inlaid non-slip
Cage: PVC strap
Bearing: Ball bearing
Size: 132×160mm
Weight: Ball type 1055g/pr



FP-J029

Body: One-piece PP /inlaid non-slip
Cage: PVC strap
Bearing: Ball bearing
Size: 136.5×144.9mm
Weight: Ball type 934g/pr



FP-J018

Body: One-piece PP
Cage: PVC strap
Bearing: Ball bearing
Size: 124×126mm
Weight: Ball type 918g/pr



FP-J028

Body: One-piece PP /inlaid non-slip
Cage: PVC strap
Bearing: Ball bearing
Size: 131.3×48.3mm
Weight: Ball type 967g/pr



FP-J030

Body: One-piece PP /inlaid non-slip
Cage: Nylon
Bearing: Ball bearing
Size: 106×145mm
Weight: Ball type 436g/pr





FP-607

Body: One-piece PP
Spindle: Boron
Bearing: Ball-less
Size: 81×58mm
Weight: 198g/pr



FP-607B

Body: One-piece PP
Spindle: Boron
Bearing: Ball bearing
Size: 79.9×58mm
Weight: 262.1g/pr



FP-608

Body: One-piece pp/
 inlaid non-slip
Spindle: Boron
Bearing: Ball-less
Size: 98.7×85mm
Weight: 267.2g/pr



FP-605A

Body: One-piece PP /inlaid
 non-slip
Spindle: Boron
Bearing: Ball bearing
Size: 97.6×65mm
Weight: 335.4g/pr



FP-611

Body: One-piece pp/
 inlaid non-slip
Spindle: Boron
Bearing: Ball-less
Size: 100*85mm
Weight: 239.6g/pr



FP-622

Body: One-piece PP
Spindle: Boron
Bearing: Ball-less
Size: 88.1×60mm
Weight: 193g/pr



FP-629

Body: One-piece PP
Spindle: Boron
Bearing: Ball-less
Size: 86.2×81mm
Weight: 275.74g/pr



FP-609

Body: One-piece PP
Spindle: Boron
Bearing: Ball-less
Size: 89.5×81.2mm
Weight: 206g/pr



FP-617

Body: One-piece PP
Spindle: Boron
Bearing: Ball bearing/<Ball-less>
Size: 87×77mm
Weight: 244g/pr/<222g/pr>



FP-602B

Body: One-piece PP /inlaid
 non-slip
Spindle: Boron
Bearing: Ball bearing
Size: 95×79mm
Weight: 288g/pr



FP-623

Body: One-piece PP
Spindle: Boron
Bearing: Ball bearing/<Ball-less>
Size: 102.5×72mm
Weight: 299g/pr/<269g/pr>



FP-651

Body: One-piece PP
Spindle: Boron
Bearing: Ball bearing/<Ball-less>
Size: 95×82mm
Weight: 309g/pr/<269g/pr>



FP-630

Body: One-piece PP
 w/inlaid non-slip
Spindle: Boron
Bearing: Ball-less
Size: 95×65mm
Weight: 272g/pr



FP-631

Body: One-piece PP
Spindle: Boron
Bearing: Ball-less
Size: 98.6×76.5mm
Weight: 206g/pr



FP-628

Body: One-piece PP
Spindle: Boron
Bearing: Ball bearing/<Ball-less>
Size: 96×75mm
Weight: 254g/pr/<220g/pr>



FP-650

Body: One-piece PP
Spindle: Boron
Bearing: Ball bearing/<Ball-less>
Size: 90×84mm
Weight: 299g/pr/<264g/pr>



FP-650W

Body: One-piece PP
Spindle: Boron
Bearing: Ball-less
Size: 91.5×82.5mm
Weight: 196.4g/pr



FP-627

Body: One-piece PP
Spindle: Boron
Bearing: Ball bearing/<Ball-less>
Size: 95×86mm
Weight: 284g/pr/<259g/pr>



HEADSETS EXERCISE



FP-H891 HEADSETS

Set: 2pcs
Thread: 1-1/8"
Diameter: 28.6/44/30
Stack Height: 8.6+6.5=15.1
Bearings: 1/8"ball
Material: Engineering Plastic+steel
Finish: BK
Weight: 54.2g

17

01 Fast assembly

02 Lightweight, Compared with similar products, the weight is reduced by 50%

03 Stable and reliable quality

PEDALS | HEADSETS | BOTTOM BRACKETS



HEADSETS

ENGINEERING PLASTIC TOP WASHER:

01 Color coating finish make the same touch feeling with alloy.

02 60% weight reduction and keep same function level with alloy.



FP-H863 Top Cover



FP-H863J Top Cover



FP-H801P Top Cover



FP-H863 HEADSETS

Set: 9pcs
Thread: 1-1/8"
Diameter: 28.6/44/30
Stack Height: 17.5+4.5=22
Bearings: Caged(5/32"x22)
Material: Steel
Finish: ED black or CP
Weight: 109.9g



FP-H868J HEADSETS

Set: 10pcs
Thread: 1-1/8"&1-1/2"
Diameter: 28.6/44-56/39.8
Stack Height: 10.5+2.5=13
Bearings: Caged(5/32"x22) & (3/16"x20)
Material: Steel
Finish: ED black or CP
Weight: 138.69g
Option: 28.6/44-56/30 167.19g



FP-H801P HEADSETS

Set: 10pcs
Thread: 1-1/8"
Diameter: 28.6/34/30
Stack Height: 21+11.1=32.1
Bearings: Caged(5/32"x22)
Material: Steel
Finish: ED black or CP
Weight: 125.69g

18

FLUMIN

HEADSETS



LOCK HEADSET A



FP-HS08 HEADSETS

Set: 15pcs
Thread: BC1-1/8"×26tpi
Diameter: 25.4/44/30
Stack Height: 48.9+4.5=53.4
Bearings: Caged(5/32"×22)
Material: Steel
Finish: ED black or CP
Weight: 214g



FP-HS09 HEADSETS

Set: 15pcs
Thread: BC1-1/8"×26tpi
Diameter: 25.4/34/30
Stack Height: 55.5+11.1=66.6
Bearings: Caged(5/32"×22)
Material: Steel
Finish: ED black or CP
Weight: 227g



01 Easy and quick assembly from the simplified structure and light weight design.

02 25% weight holding than similar products in the market.



FP-H858B LOCATION HEADSETS

Set: 7pcs
Thread: 1-1/8" & 1-1/2"
Diameter: 28.6/41-52/39.8
Stack Height: 4+0.7=4.7
Bearings: Sealed
Material: Aluminum
Finish: Anodized Color
Weight: 75.03g



FP-H521 LOCATION HEADSETS

Set: 8pcs
Thread: BC1"×24tpi
Diameter: 22.2/30/27
Stack Height: 24.5+10.5=35
Bearings: Caged(5/32"×16)
Material: Steel
Finish: ED black or CP
Weight: 129.6g



FP-HC821 LOCATION HEADSETS

Set: 8pcs
Thread: BC1-1/8"×26tpi
Diameter: 25.4/34/31
Stack Height: 21.9+10.6=32.5
Bearings Caged: Caged(5/32"×22) & (5/32"×21)
Material: Steel
Finish: ED black or CP
Weight: 152.5g



FP-H809E LOCATION HEADSETS

Set: 7pcs
Thread: 1-1/8"
Diameter: 28.6/44/30
Stack Height: 10.5+4.6=15.1
Bearings: Sealed
Material: Aluminum
Finish: Anodized Color
Weight: 83.5g



FP-H521C LOCATION HEADSETS

Set: 9pcs
Thread: 1"
Diameter: 25.4/30/27
Stack Height: 20.5+10.5=31
Bearings: Caged(5/32"×16)
Material: Aluminum
Finish: Anodized Color
Weight: 87.65g



FP-H876 LOCATION HEADSETS

Set: 8pcs
Thread: 1-1/8"
Diameter: 28.6/44/30
Stack Height: 6.7+2.5=9.2
Bearings: Caged(5/32"×22)
Material: Steel
Finish: ED black or CP
Weight: 131g



FP-H869T HEADSETS

Set: 6pcs
Thread: 1-1/8" & 1-1/2"
Diameter: 28.6/41.8-52/39.8
Stack Height: 10.5+0.7=11.2
Bearings: Sealed
Material: Aluminum
Finish: Anodized color
Weight: 74.3g
Option: 28.6/41.8-52/30, 79.2g

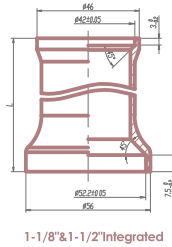

FP-H889T HEADSETS

Set: 7pcs
Thread: 1-1/8" & 1-1/2"
Diameter: 28.6/41.8-52/39.8
Stack Height: 15.5+0.7=16.2
Bearings: Sealed
Material: Aluminum
Finish: Anodized color
Weight: 94.3g



FP-H856 HEADSETS

Set: 7pcs
Thread: 1-1/8" & 1-1/2"
Diameter: 28.6/44-56/39.8
Stack Height: 10.5+2.7=13.2
Bearings: Sealed
Material: Aluminum
Finish: Anodized color
Weight: 80.4g
Option: FP-H856B Aluminum washer 15mm, SH 17.7, 86.2g

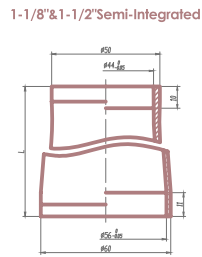

FP-H885D HEADSETS

Set: 5pcs
Thread: 1-1/8" & 1-1/2"
Diameter: 28.6/44-56/30
Stack Height: 5.4+2.7=8.1
Bearings: Sealed
Material: Aluminum
Finish: Anodized Color
Weight: 127.6g



FP-H868P HEADSETS

Set: 9pcs
Thread: 1-1/8" & 1-1/2"
Diameter: 28.6/44-56/39.8
Stack Height: 17.5+2.5=20
Bearings: Caged(5/32"x22) & Cage(3/16"x20)
Material: Steel
Finish: ED black or CP
Weight: 139.85g
Option: 28.6/44-56/30, 168.35g



FP-H885C HEADSETS

Set: 5pcs
Thread: 1-1/2"
Diameter: 28.6/56/30
Stack Height: 8.4+2.7=11.1
Bearings: Sealed
Material: Aluminum
Finish: Anodized Color
Weight: 174.8g



FP-H868Y HEADSETS

Set: 10pcs
Thread: BC1-1/8"x26T & 1-1/2"
Diameter: 25.4/44-56/30
Stack Height: 21.4+2.5=23.9
Bearings Caged: Caged(5/32"x22) & (3/16"x20)
Material: Aluminum
Finish: Anodized Color
Weight: 223.1g



FP-H899 HEADSETS

Set: 8pcs
Thread: 1-1/8" & 1-1/4"
Diameter: 28.6/41.8-46.9
Stack Height: 40.8
Bearings Caged: Sealed
Material: GCr15
Finish: BK
Weight: 75.5g



FP-H836DX HEADSETS

Set: 6pcs
Thread: 1-1/8" & 1-1/4"
Diameter: 28.6/41.8-46.9/30
Stack Height: 15.8+0.5=16.3
Bearings: Sealed
Material: Aluminum
Finish: ED black or CP
Weight: 66.4g

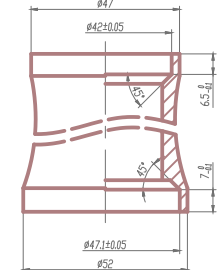

FP-H836D7 HEADSETS

Set: 6pcs
Thread: 1-1/4"
Diameter: 32/47/33
Stack Height: 0.6+2.5=3.1
Bearings Caged: Sealed
Material: Aluminum
Finish: Anodized Color
Weight: 69.7g



FP-H838 HEADSETS

Set: 6pcs
Thread: 1-1/8" & 1-1/4"
Diameter: 28.6/44-50.6/33
Stack Height: 20.4+2.5=22.9
Bearings: Sealed
Material: Aluminum
Finish: Anodized Color
Weight: 162.2g
Option: FP-H838B 28.6/44-50.6/30, 164.8g

NEW!

NEW!

NEW!

1-1/8"&1-1/4" Semi-Integrated

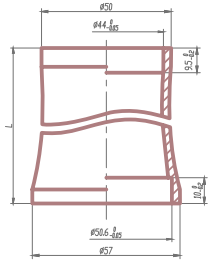

FP-H870P HEADSETS

Set: 9pcs
Thread: 1-1/8" & 1-1/4"
Diameter: 28.6/44-50.6/33
Stack Height: 17.5+2.5=20
Bearings: Caged (5/32"×22) & (5/32"×27)
Material: Steel
Finish: ED Black or CP
Weight: 118.75g
Option: 28.6/44-50.6/30, 126.65g

1-1/4" semi-Integrated

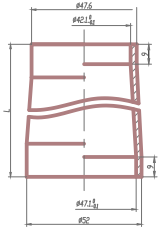

FP-H837 HEADSETS

Set: 8pcs
Thread: 1-1/4"
Diameter: 28.6/42.1-47.1/30
Stack Height: 17.6+3=20.6
Bearings: Caged (1/8"×26) & (1/8"×24)
Material: Aluminum
Finish: Anodized Color
Weight: 118.2g

1-1/8"&1-1/4" Semi-Integrated

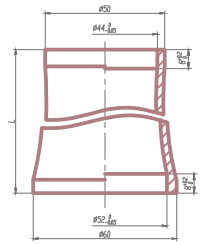

FP-H871 HEADSETS

Set: 9pcs
Thread: 1-1/8" & 1-1/4"
Diameter: 28.6/44-52/30
Stack Height: 5+3=8
Bearings: Caged (5/32"×22)
Material: Steel
Finish: ED black or CP
Weight: 146.1g



FP-H809B1 HEADSETS

Set: 7pcs
Thread: 1-1/8"
Diameter: 28.6/44/30
Stack Height: 15+2.6=17.6
Bearings: Sealed
Material: Aluminum
Finish: Anodized color
Weight: 85.7g
Option: **FP-H809B**
 Aluminum cover 7.3mm, SH 13.1, 79.5g

1-1/8" Semi-Integrated

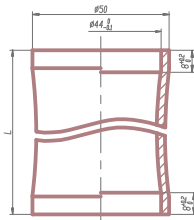

FP-H809H HEADSETS

Set: 8pcs
Thread: BC 1-1/8"×26tpi
Diameter: 25.4/44/30
Stack Height: 21.2+2.6=23.8
Bearings: Sealed
Material: Aluminum
Finish: Anodized color
Weight: 93.05g



FP-H809D1 HEADSETS

Set: 7pcs
Thread: 1-1/8"
Diameter: 28.6/34/30
Stack Height: 19.5+11.5=31
Bearings: Sealed
Material: Aluminum
Finish: Anodize color
Weight: 76.7g

NEW!



1-1/8" Integrated

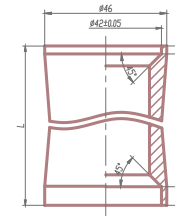

FP-H819 HEADSETS

Set: 7pcs
Thread: 1-1/8"
Diameter: 28.6/41.8/30
Stack Height: 10.5+0.5=11
Bearings: Sealed
Material: Aluminum
Finish: Anodized Color
Weight: 91.6g



FP-HC819 HEADSETS

Set: 6pcs
Thread: 1-1/8"
Diameter: 28.6/41.8/30
Stack Height: 10.5+0.7=11.2
Bearings: Sealed
Material: Aluminum
Finish: Anodized Color
Weight: 67.15g



1-1/8" Integrated

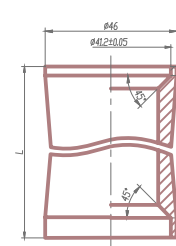

FP-H865 HEADSETS

Set: 6pcs
Thread: 1-1/8"
Diameter: 28.6/41/30
Stack Height: 9.3+1=10.3
Bearings: Sealed
Material: Aluminum
Finish: Anodized Color
Weight: 60.4g



FP-H835B HEADSETS

Set: 5pcs
Thread: 1-1/8"
Diameter: 28.6/44/30
Stack Height: 20.4+5.7=26.1
Bearings: Sealed
Material: Aluminum
Finish: Anodized Color
Weight: 155.4g



FP-H813PL HEADSETS

Set: 6pcs
Thread: 1-1/8"
Diameter: 28.6/44/30
Stack Height: 20+2.3=22.3
Bearings: Caged (5/32"×22)
Material: Aluminum
Finish: Anodized Color
Weight: 151.9g



FP-H813D1 HEADSETS

Set: 6pcs
Thread: 1-1/8"
Diameter: 28.6/44/30
Stack Height: 10.3+2.3=12.6
Bearings: Caged (5/32"×22)
Material: Aluminum
Finish: Anodized Color
Weight: 140.59g

NEW!



FP-H813Q HEADSETS

Set: 5pcs
Thread: 1-1/8"
Diameter: 28.6/44/30
Stack Height: 8+2.5=10.5
Bearings: Caged(5/32"x22)
Material: Aluminum
Finish: Anodized Color
Weight: 115.6g



FP-H821PL HEADSETS

Set: 6pcs
Thread: 1-1/8"
Diameter: 28.6/41.4-44/30
Stack Height: 23+2.5=25.5
Bearings: Caged(1/8"x25) & (5/32"x22)
Material: Aluminum
Finish: Anodized Color
Weight: 138.7g



FP-H808N HEADSETS

Set: 10pcs
Thread: 1-1/8"
Diameter: 28.6/34-44/30
Stack Height: 18.6+4.5=23.1
Bearings: Caged(5/32"x22)
Material: Aluminum
Finish: Anodized Color
Weight: 146.95g



FP-H807 HEADSETS

Set: 9pcs
Thread: 1-1/8"
Diameter: 28.6/44/30
Stack Height: 5+4.5=9.5
Bearings: Caged(5/32"x22)
Material: Steel
Finish: ED black or CP
Weight: 102.7g
Option:
FP-H807B 10pcs, Aluminum washer 12.9mm, SH21.9, 120.4g
FP-H807B1 10pcs, Aluminum washer 25mm, SH34, 142.9g
FP-H807B2 10pcs, Aluminum washer 10mm, SH19, 115.2g



FP-H826PL HEADSETS

Set: 6pcs
Thread: 1-1/8"
Diameter: 28.6/41.4/30
Stack Height: 22+2.5=24.5
Bearings: Caged(1/8"x25)
Material: Aluminum
Finish: Anodized Color
Weight: 125.9g

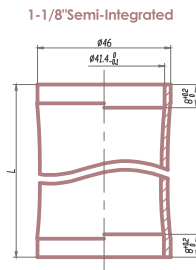

FP-H811PL HEADSETS

Set: 5pcs
Thread: 1-1/8"
Diameter: 28.6/34/30
Stack Height: 22+10.5=32.5
Bearings: Caged(1/8"x25)
Material: Aluminum
Finish: Anodized Color
Weight: 96.6g



FP-H807D HEADSETS

Set: 9pcs
Thread: 1-1/8"
Diameter: 28.6/44/30
Stack Height: 10.5+3.5=14
Bearings: Caged(5/32"x22)
Material: Aluminum
Finish: Anodized Color
Weight: 116.7g



FP-H817B HEADSETS

Set: 9pcs
Thread: 1-1/8"
Diameter: 28.6/44/30
Stack Height: 20.5+4.5=25
Bearings: Caged(5/32"x22)
Material: Aluminum
Finish: Anodized Color
Weight: 154.8g
FP-H817C: 10pcs, Aluminum cover 7mm, SH18, 147.7g



FP-H822PL HEADSETS

Set: 5pcs
Thread: 1-1/8"
Diameter: 28.6/34/30
Stack Height: 26+10.2=36.2
Bearings: Caged(1/8"x25)
Material: Aluminum
Finish: Anodized Color
Weight: 105.4g

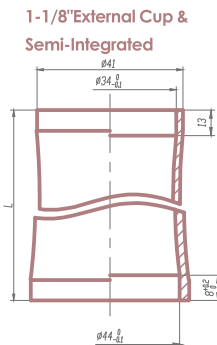

FP-H825PL HEADSETS

Set: 5pcs
Thread: 1-1/8"
Diameter: 28.6/34-44/30
Stack Height: 26+2.3=28.3
Bearings: Caged(1/8"x25) & (5/32"x22)
Material: Aluminum
Finish: Anodized Color
Weight: 107.9g



FP-H801S HEADSETS

Set: 9pcs
Thread: 1-1/8"
Diameter: 28.6/34/30
Stack Height: 11.6+11.1=22.7
Bearings: Caged(5/32"x22)
Material: Steel
Finish: ED black or Cp
Weight: 135.6g
FP-H808F 10pcs, Aluminum cover 6mm, SH 28.1, 140.9g
FP-H808 10pcs, Aluminum cover 10mm, SH 32.1, 146.5g
FP-H808G 10pcs, Aluminum cover 15mm, SH 37.1, 148.3g

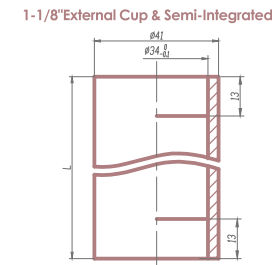

FP-H802 HEADSETS

Set: 9pcs
Thread: 1-1/8"
Diameter: 28.6/34/30
Stack Height: 11.6+11.1=22.7
Bearings: Caged(5/32"x22)
Material: Steel
Finish: ED black or Cp
Weight: 148g



FP-H803C HEADSETS

Set: 9pcs
Thread: BC1-1/8"×26tpi
Diameter: 25.4/34-44/30
Stack Height: 27.6+4.5=32.1
Bearings: Caged(5/32"×22)
Material: Steel
Finish: ED black or CP
Weight: 164.9g



FP-H803P(H803) HEADSETS

Set: 12pcs<9pcs>
Thread: BC1-1/8"×26tpi
Diameter: 25.4/34/30
Stack Height: 33.5+11.1=44.6/<27.6+11.1=38.7>
Bearings: Caged(5/32"×22)
Material: Steel
Finish: ED black or CP
Weight: 195.1g/<165.6g>



FP-H803A-03 HEADSETS

Set: 9pcs
Thread: BC1-1/8"×26tpi
Diameter: 25.4/34/30
Stack Height: 25.5+11.1=36.6
Bearings: Caged(5/32"×22)
Material: Aluminum
Finish: Anodized Color
Weight: 176.8g
Option: FP-H803A-05
 26.6+11=37.7, 202.9g



FP-H804B HEADSETS

Set: 9pcs
Thread: BC1-1/8"×26tpi
Diameter: 25.4/34/30
Stack Height: 23.5+11.1=34.6
Bearings: Caged(5/32"×22)
Material: Steel
Finish: ED Black Or CP
Weight: 172.2g



FP-H805 HEADSETS

Set: 9pcs
Thread: BC1-1/8"×26tpi
Diameter: 25.4/44/30
Stack Height: 21.5+4.5=26
Bearings: Caged(5/32"×22)
Material: Steel
Finish: ED black or CP
Weight: 156.9g



FP-H805A HEADSETS

Set: 10pcs
Thread: BC1-1/8"×26tpi
Diameter: 25.4/44/30
Stack Height: 21.4+4.5=25.9
Bearings: Caged(5/32"×22)
Material: Aluminum
Finish: Anodized Color
Weight: 165.6g



FP-H805P HEADSETS

Set: 10pcs
Thread: BC1-1/8"×26tpi
Diameter: 25.4/44/30
Stack Height: 21.4+4.5=25.9
Bearings: Caged(5/32"×22)
Material: Steel
Finish: ED black or CP
Weight: 157.7g



FP-H815A HEADSETS

Set: 10pcs
Thread: BC1-1/8"×26tpi
Diameter: 25.4/44/30
Stack Height: 17.7+3=20.7
Bearings: Caged(5/32"×22)
Material: Aluminum
Finish: Anodized Color
Weight: 174.2g



FP-H815T HEADSETS

Set: 10pcs
Thread: BC1-1/8"×26tpi
Diameter: 25.4/44/30
Stack Height: 17.7+3=20.7
Bearings: Caged(5/32"×22)
Material: Aluminum
Finish: Anodized Color
Weight: 187g



FP-H825G HEADSETS

Set: 6pcs
Thread: BC1-1/8"×26tpi
Diameter: 25.4/34-44/30
Stack Height: 38.7+2.3=41
Bearings: Caged(1/8"×25)&(5/32"×22)
Material: Aluminum
Finish: Anodized Color
Weight: 121.5g



FP-H860D HEADSETS

Set: 9pcs
Thread: BC1-1/8"×26tpi
Diameter: 25.4/34/30
Stack Height: 19+11.1=30.1
Bearings: Caged(5/32"×22)
Material: Steel
Finish: ED black or CP
Weight: 186.7g



FP-H820PL HEADSETS

Set: 6pcs
Thread: BC1-1/8"×26tpi
Diameter: 25.4/34/30
Stack Height: 29.8+10.2=40
Bearings: Caged(1/8"×25)
Material: Steel
Finish: ED black or CP
Weight: 161.4g



FP-H828PL HEADSETS

Set: 6pcs
Thread: BC1-1/8"×26tpi
Diameter: 25.4/44/30
Stack Height: 32.7+2.3=35
Bearings: Caged(5/32"×22)
Material: Aluminum
Finish: Anodized Color
Weight: 138.8g



FP-H862B HEADSETS

Set: 9pcs
Thread: BC1-1/8"×26tpi
Diameter: 25.4/44/30
Stack Height: 18+2.5=20.5
Bearings: Caged(5/32"×22)
Material: Steel
Finish: ED black or CP
Weight: 143g



FP-H529 HEADSETS

Set: 6pcs
Thread: 1"
Diameter: 25.4/38/26.4
Stack Height: 8.7+0.8=9.5
Bearings: Sealed
Material: Aluminum
Finish: Anodized Color
Weight: 81.2g

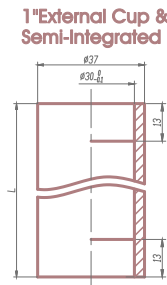
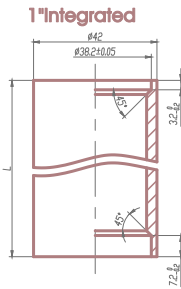

FP-H550B HEADSETS

Set: 8pcs
Thread: BC1"x24tpi
Diameter: 22.2/30/27
Stack Height: 27.7+11.5=39.2
Bearings: Sealed
Material: Aluminum
Finish: Anodized color
Weight: 81.65g



FP-H509 HEADSETS

Set: 8pcs
Thread: BC1"x24tpi
Diameter: 22.2/30/27
Stack Height: 27+10.5=37.5
Bearings: Caged(5/32"x16)
Material: Steel
Finish: ED black or CP
Weight: 145.85g



FP-H509P HEADSETS

Set: 9pcs
Thread: BC1"x24tpi
Diameter: 22.2/30/27
Stack Height: 27+10.5=37.5
Bearings: Caged(5/32"x16)
Material: Steel
Finish: ED black or CP
Weight: 154.8g



FP-H532 HEADSETS

Set: 9pcs
Thread: 1"
Diameter: 25.4/30/27
Stack Height: 20.5+10.5=31
Bearings: Caged(5/32"x16)
Material: Aluminum
Finish: Anodized Color
Weight: 132.3g



FP-H501 HEADSETS

Set: 8pcs
Thread: BC1"x24tpi
Diameter: 22.2/30/27
Stack Height: 24.5+10.5=35
Bearings: Caged(5/32"x16)
Material: Steel
Finish: ED black or CP
Weight: 132g



FP-H501P HEADSETS

Set: 7pcs
Thread: BC1"x24tpi
Diameter: 22.2/30/27
Stack Height: 15.3+10.5=25.8
Bearings: Caged(5/32"x16)
Material: Steel
Finish: ED black or CP
Weight: 92.4g



FP-H512 HEADSETS

Set: 8pcs
Thread: BC1"x24tpi
Diameter: 22.2/30/27
Stack Height: 24+10.5=34.5
Bearings: Caged(5/32"x16)
Material: Steel
Finish: ED black or CP
Weight: 153.5g



FP-H520 HEADSETS

Set: 8pcs
Thread: BC1"x24tpi
Diameter: 22.2/30/27
Stack Height: 24.5+10.5=35
Bearings: Caged(5/32"x16)
Material: Steel
Finish: ED black or CP
Weight: 141.9g



FP-H502 HEADSETS

Set: 8pcs
Thread: BC1"x24tpi
Diameter: 22.2/30/27
Stack Height: 25.5+10.5=36
Bearings: Caged(5/32"x16)
Material: Steel
Finish: ED black or CP
Weight: 148.65g



FP-H506 HEADSETS

Set: 8pcs
Thread: BC1"x24tpi
Diameter: 22.2/30/27
Stack Height: 24+10.5=34.5
Bearings: Caged(5/32"x16)
Material: Steel
Finish: ED black or CP
Weight: 152.7g



FP-H507 HEADSETS

Set: 8pcs
Thread: BC1"x24tpi
Diameter: 22.2/30/27
Stack Height: 23+10.5=33.5
Bearings: Caged(5/32"x16)
Material: Steel
Finish: ED black or CP
Weight: 138.4g

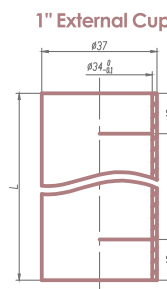
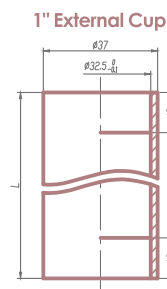

FP-H516 HEADSETS

Set: 8pcs
Thread: BC1"x24tpi
Diameter: 21.2/32.5/27
Stack Height: 26+11=37
Bearings: Caged(3/16"x15)
Material: Steel
Finish: ED black or CP
Weight: 141g

FP-H522 HEADSETS

Set: 8pcs
Thread: BC1"x24tpi
Diameter: 22.2/34/27
Stack Height: 27+10.5=37.5
Bearings: Caged(5/32"x16)
Material: Steel
Finish: ED black or CP
Weight: 149.4g

BOTTOM BRACKETS



FP-B900

ROAD

Set: 3pcs
Thread: BC1.37"×24T
Axle: Boron
Material: Aluminum sheath
Finish: Black treatment



FP-B902

ATB

Set: 2pcs
Thread: BC1.37"×24T
Axle: Boron
Material: Aluminum sheath/steel cups
Finish: Barrel polished sheath/Phosphated cups



FP-B912ZU

ATB

Set: 3pcs
Thread: BC1.37"×24T
Axle: Boron
Material: Nylon cup&sheath
Finish: Black treatment



FP-B927

ATB

Set: 2pcs
Thread: M47×P1.0
Axle: Boron
Material: Nylon cup&sheath
Finish: Black treatment



FP-B902CT

ATB

Set: 3pcs
Thread: BC1.37"×24T
Axle: Boron
Material: Aluminum sheath/
steel cups
Finish: Phosphated cups



FP-B902W

ATB

Set: 2pcs
Thread: BC1.37"×24T
Axle: Boron
Material: Aluminum sheath/
steel cups
Finish: Barrel polished sheath/
Phosphated cups



FP-B908N

CITY ATB

Set: 2pcs
Thread: BC1.37"×24T
Axle: Boron
Material: Nylon cup&sheath
Finish: Black treatment



FP-B908NT

CITY ATB

Set: 3pcs
Thread: BC1.37"×24T
Axle: Boron
Material: Nylon cup&sheath
Finish: Black treatment



FP-B908L

CITY ATB

Set: 2pcs
Thread: BC1.37"×24T
Axle: Boron
Material: Nylon cup&sheath
Finish: Black treatment



FP-B908LW

CITY ATB

Set: 2pcs
Thread: BC1.37"×24T
Axle: Boron
Material: Nylon cup&sheath
Finish: Black treatment



FP-B917

E-BIKE

Set: 2pcs
Thread: BC1.37"×24T
Axle: Boron
Material: Aluminum sheath/
steel cups
Finish: Phosphated cups



FP-B921

Set: 2pcs
Thread: BC1.37"×24T
Axle: Boron
Material: Aluminum sheath/
 steel cups
Finish: Phosphated cups



FP-B909

Set: 2pcs
Threadless: Φ30mm
Axle: Boron
Material: Nylon cup&sheath
Finish: Black treatment



FP-B910

Set: 2pcs
Thread: BC1.37"×24T
Axle: Boron
Material: Nylon cup&sheath
Finish: Black treatment

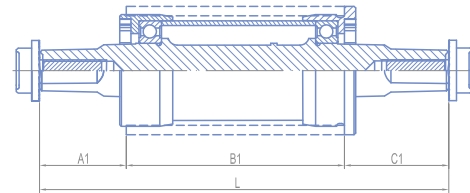

FP-B903

E-BIKE

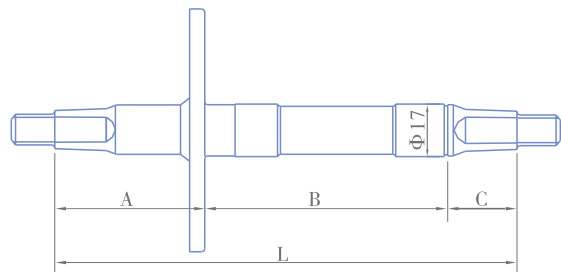

Axle No	Bracket Width	Left A1	Center B1	Right C1	Length L
2MM	68	17	68	18	103
2M	68	21	68	21	110
2J	68	22.5	68	22.5	113
2JB	68	23.5	68	23.5	115
2L	68	24	68	24	116
2LB	68	23	68	25	116
2A	68	24	68	25.5	117.5
2P	68	24	68	27	119
2N	68	24	68	28	120
2PL	68	26	68	27	121
2PS	68	24	68	30	122
2NL	68	26.5	68	28	122.5
2NN	68	28	68	28	124
2S	68	27	68	29.5	124.5
2T	68	27	68	31	126
2U	68	27	68	32.5	127.5
8JD	73	24	73	21	118
8LB	73	22.5	73	24.5	120
8TB	73	24.5	73	27	124.5
8H	73	22.5	73	22.5	118
B917-9H	84	27	84	27	138
B917-9T	84	25	84	31	140
B917-9N	84	22.5	84	30.5	137
B917-10M	82	34	82	32.5	148.5
B917-9NA	84	22.5	84	27	133.5
B921-9X	103	32.5	103	22.5	158
B921-9S	103	32.5	103	28.5	164
B921-9SC	103	32.5	103	23.5	159
B921-9SS	103	32.5	103	24.5	160
B920-9W	100	28.5	100	35.5	164
B925-9D	123	25	123	22	170
B925-9DA	123	23	123	21	167



Nut Type

BOTTOM BRACKETS

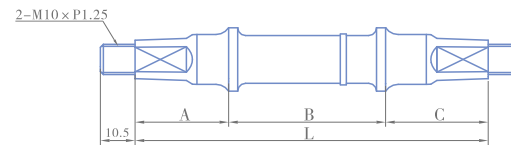

Bolt Type

BOTTOM BRACKETS

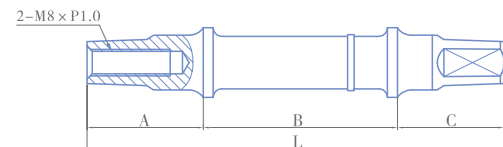

Electric Bicycle B.B

Axle No	Bracket Width	Left A1	Center B1	Right C1	Length L
3L	68	32	52	32	116
3A	68	32	52	33.5	117.5
3P	68	32	52	35	119
3N	68	32	52	36	120
3PL	68	34	52	35	121
3SS	68	32	52	37.5	121.5
3NN	68	36	52	36	124
3S	68	35	52	37.5	124.5
3T	68	35	52	39	126
3MC	68	32	52	43.5	127.5
3U	68	35	52	40.5	127.5
3R	68	35	52	42	129
3Z	68	33.5	52	33.5	119
5P	70	32	54	35	121
5S	70	35	54	37.5	126.5
5T	70	35	54	39	128
5U	70	35	54	40.5	129.5
5A	70	32	54	33.5	119.5
7N	73	32	57	35	124
7SL	73	35	57	33.5	125.5
7T	73	35	57	39	131
7R	73	35	57	42	134
1620		37.5	84	40.5	162
1715		52.5	94	51	171.5
1765		52.5	94	56	176.5
2660		85	96	85	266
2620		83	96	83	262
2700D		87	81	102	270
2560		80.2	93.7	82.1	256
2040		76	52	76	204
2350		77.7	76.5	80.8	235
2700		87	96	87	270

BOTTOM BRACKETS



FP-B601

Set: 6pcs
Thread: BC1.37"×24T
Ball rethainer: Caged(1/4"×9)
Finish: ED black or CP



FP-B601W

Set: 6pcs
Thread: BC1.37"×24T
Ball rethainer: Caged(1/4"×9)
Finish: ED black or CP



FP-B602

Set: 5pcs
Thread: BC1.37"×24T
Ball rethainer: Caged(1/4"×9)
Finish: ED black or CP



FP-B602W

Set: 5pcs
Thread: BC1.37"×24T
Ball rethainer: Caged(1/4"×9)
Finish: ED black or CP



FP-B603

Set: 5pcs
Thread: BC1.37"×24T
Ball rethainer: Caged(1/4"×9)
Finish: ED black or CP



FP-B603W

Set: 5pcs
Thread: BC1.37"×24T
Ball rethainer: Caged(1/4"×9)
Finish: ED black or CP



FP-B603PL

Set: 3pcs
Thread: BC1.37"×24T
Ball rethainer: Caged(1/4"×9)
Finish: ED black or CP



FP-B607

Set: 5pcs
Thread: BC1.37"×24T
Ball rethainer: Caged(1/4"×9)
Finish: ED black or CP



FP-B607A

Set: 4pcs
Thread: BC1.37"×24T
Ball rethainer: Caged(1/4"×9)
Finish: ED black or CP



FP-B607PL

Set: 4pcs
Thread: BC1.37"×24T
Ball rethainer: Caged(1/4"×9)
Finish: Phosphated cups



FP-B609W

Set: 5pcs
Thread: BC1.37"×24T
Ball rethainer: Caged(1/4"×9)
Finish: Phosphated cups



FP-B609PL

Set: 3pcs
Thread: BC1.37"×24T
Ball rethainer: Caged(1/4"×9)
Finish: Phosphated cups



FP-B701

Set: 9pcs
Thread: UNS 15/16"×24T
 UNS 7/8"×24TL
Ball rethainer: Caged(5/16"×9)
Finish: ED black or CP



FP-B703

Set: 9pcs
Thread: UNS 15/16"×24T
 UNS 7/8"×24TL
Ball rethainer: Caged(5/16"×9)
Finish: ED black or CP



ACCESSORIES



Pedal-reflector options

Screw-in reflectors can be assembled on pedals before shipment if required components encourages the use of reflectors night cycling is 15-20 times more dangerous than daylight cycling. All pedals except exercise models should be equipped with relectors.Standards apply to the folowing countries:AS(Australia),BS(UK),CPSC(USA).



FP-S01

TOE-STRAP
12×450mm woven nylon strap.Chromeplated steel fastener 50g/pr



FP-T02

TOE-CLIP
Black durable nylon 52g/pr



FP-T03

TOE-CLIP
Black durable nylon 38.4g/pr

Surface treatment



Polishing



Exact Polishing



CP



ED



Coating

Packing

Headset



Pedal



HW-21 (1-1/8")



FP-HW-01 (1-1/8")

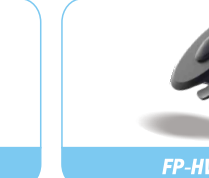

FP-HW-02 (1-1/8")

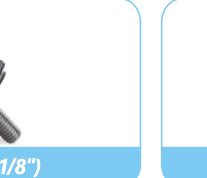

FP-HW-03 (1")



FP-HW-18 (1-1/8")



FP-HW-20 (1-1/8")



FP-HW-28 (1-1/8")



×Alloy cap for threadless headset

WASHER				
Material:	Engineering plastics	Carbon fibre	Aluminum	Aluminum
Size:	φ34×φ28.6×10mm φ34×φ28.6×5mm	φ34×φ28.6×10mm	φ50×φ28.6×10mm φ36.5×φ28.6×10mm	φ34×φ28.6×10mm φ30.5×φ26×10mm
Weight:	3.01g 1.52g	4.3g	14.79g 8.74g	6.63g 5.16g
Remarks:	/	The height of the gasket can be customized.		

The standard color of Pedals

STANDARD COLOR

PT-186 C	PT-Orange 021 C	PT-Yellow 012C
PT-2925 C	PT-266 C	PT-Cool Gray 1C
PT-375 C	PT-344 C	PT-white C

PT-7595 c
Production cycle/day 7
MOQ/pr 300

MAINSTREA COLOR

PT-729C	PT-7543C	PT-7499C	PT-2348C	PT-225C
PT-230C	PT-3125C	PT-730 C	PT-2333 C	PT-382 C
PT-187 C	PT-226 C	PT-264 C	PT-273 C	PT-7465 C

PT-Reflex Blue C
Production cycle/day 10
MOQ/pr 500

OTHER

* Please refer to the standard color book for the actual color.

Production cycle/day 15
MOQ/pr 1000