

SBH可调式双刃粗镗刀系列 《镗孔范围 ϕ 25- ϕ 204mm》
Twin-bit Rough Boring Head SBH<Boring Range Form ϕ 25- ϕ 204mm>

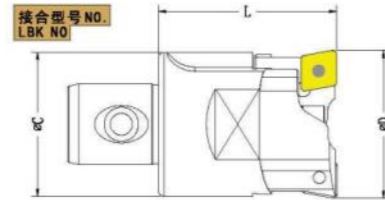

特色

- 1、刀体整体缩短，刚性增强。
- 2、内藏式水孔，直接冷却，刀片寿命长。
- 3、排屑槽设计，增加深孔排屑功能。
- 4、刀片座降低高度，刚性增强。
- 5、独特高低段差设计，平刃或高低刃均可采用。

Features

1. Shortened boring head, with strengthened rigidity
2. Inner coolant nozzle directly cools the inserts and prolongs the working life.
3. Design of chip pocket increases the chipping function on deep holes.
4. The lowered height of insert holder strengthens the rigidity.
5. Unique design of height difference, Suitable for level boring and step boring..

镗头型号 Boring Head Type	接合型号 LBK No.	镗孔范围 ϕ Dmm Boring Range	L mm	C mm	刀片规格 Insert	重量 kg Weight	
	SBH25-35-C	LBK2	25 ~ 33	32	24	CCMT060204	0.1
	SBH32-45-C	LBK3	32 ~ 42	39	31	CCMT09T304	0.2
	SBH40-55-C	LBK4	40 ~ 55	48	39		0.4
	SBH52-75-C	LBK5	52 ~ 75	54	50		0.7
	SBH68-100-C	LBK6	68 ~ 100	68	63	CCMTI 20408	1.6
SBH90-130-C	90 ~ 130		78	88	2.6		
	SBH120-164-C	BST Series	120 ~ 164	100	100	CCMTI 20408	4.1
	SBH160-204-C		160 ~ 204	100	128	CCMTI 20408	5.2

SBH双刃粗镗刀+LBK刀柄 (MAS 403BT)
SBH Twin-bit Rough Boring Head+LBK Shank(MAS 403BT)

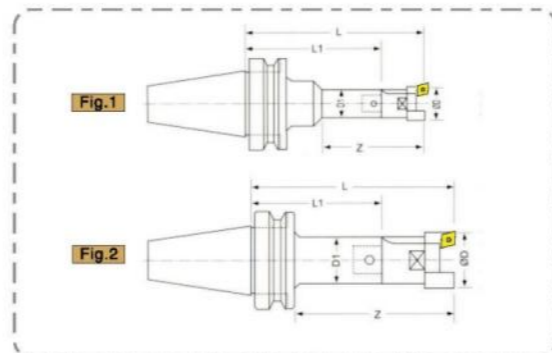

SBH双刃粗镗刀组合系列 SBH Finish Boring Head

型号 Tape	样式 Fig.	镗孔范围 ϕ (Dmm)	有效长 Z	组合内容 Tool Connection		接合型号 LBK No	全长 L	刀杆长 L1	刀杆外径 D1	重量 KG
				LBK刀杆 LBK shank	SBH刀头 SBH boring head					
BT30-SBH25-112	2	25-35	82	BT30-LBK2-80	SBH25	2	112	80	24	0.8
BT30-SBH32-119		32-45	89	BT30-LBK3-80	SBH32	3	119		31	1.0
BT30-SBH40-118		40-55	75	BT30-LBK4-70	SBH40	4	118	70	39	1.3
BT30-SBH52-114		52-75	84	BT30-LBK5-60	SBH52	5	114	60	50	1.8
BT30-SBH68-128		68-100	98	BT30-LBK6-60	SBH68	6	128		64	3.0
BT30-SBH90-138		90-130	108		SBH90		6	138	3.9	
BT40-SBH25-117	2	25-35	82	BT40-LBK2-85	SBH25	2	117	85	24	1.3
BT40-SBH25-147			112	BT40-LBK2-115	SBH32	3	147	115	31	1.6
BT40-SBH32-134		32-45	99	BT40-LBK3-95		3	134	95	1.5	
BT40-SBH32-164			129	BT40-LBK3-125		3	164	125	1.8	
BT40-SBH32-194			159	BT40-LBK3-155	3	194	155	2.0		
BT40-SBH40-133		40-55	85	BT40-LBK4-85	SBH40	4	133	85	39	1.8
BT40-SBH40-178			130	BT40-LBK4-130		4	178	130	2.4	
BT40-SBH40-223			175	BT40-LBK4-175		4	223	175	2.7	
BT40-SBH52-129			94	BT40-LBK5-75		SBH52	5	129	75	2.3
BT40-SBH52-179		144	BT40-LBK5-125	5	179		125	3.3		
BT40-SBH52-229		194	BT40-LBK5-175	5	229		175	4.0		
BT40-SBH68-133		68-100	98	BT40-LBK6-65	SBH68	6	133	65	64	3.3
BT40-SBH68-183			148	BT40-LBK6-115			6	183	115	4.7
BT40-SBH68-233			198	BT40-LBK6-165			6	233	165	5.9
BT40-SBH90-143			108	BT40-LBK6-65			SBH90	6	143	65
BT40-SBH90-193		158	BT40-LBK6-115	6	193	115			5.6	
BT40-SBH90-243		208	BT40-LBK6-165	6	243	165			6.8	
BT40-SBH120-172		120-164	137	BT40-BST-70	SBH120	BST	172	70	95	7.0
BT40-SBH160-170	160-204	135	SBH160		170		8.0			
BT50-SBH25-142	2	25-35	92	BT50-LBK2-110	SBH25	2	142	110	24	4.1
BT50-SBH25-172			122	BT50-LBK2-140	2	172	140	4.2		
BT50-SBH32-164		32-45	114	BT50-LBK3-125	SBH32	3	164	125	31	4.4
BT50-SBH32-194			144	BT50-LBK3-155			3	194	155	4.5
BT50-SBH40-163			40-55	100			BT50-LBK4-115	SBH40	4	163
BT50-SBH40-193		130		BT50-LBK4-145	4	193	145			4.9
BT50-SBH40-223		160		BT50-LBK4-175	4	223	175			5.3
BT50-SBH40-253		190		BT50-LBK4-205	4	253	205			5.4
BT50-SBH52-159		52-75	109	BT50-LBK5-105	SBH52	5	159	105	50	5.5
BT50-SBH52-234			184	BT50-LBK5-180			5	234	180	6.5
BT50-SBH52-294			244	BT50-LBK5-240			5	294	240	7.2
BT50-SBH52-354			1	244			BT50-LBK5-300	5	354	300
BT50-SBH68-163		68-100	113	BT50-LBK6-95	SBH68	6	163	95	64	6.5
BT50-SBH68-238			188	BT50-LBK6-170			6	238	170	8.3
BT50-SBH68-298			248	BT50-LBK6-230			6	298	230	9.6
BT50-SBH68-358			308	BT50-LBK6-290			6	358	290	11.0
BT50-SBH68-418			1	368			BT50-LBK6-350	6	418	350
IBT50-SBH68-418		1	368	IBT50-LBK6-350	6	368	350	64	13.2	
BT50-SBH90-173		90-130	123	BT50-LBK6-95	SBH90	6	173	95	64	7.4
BT50-SBH90-248			198	BT50-LBK6-170			6	248	170	9.2
BT50-SBH90-308			258	BT50-LBK6-230			6	308	230	10.5
BT50-SBH90-368			318	BT50-LBK6-290			6	368	290	11.9
BT50-SBH90-428		1	378	BT50-LBK6-350	6	428	350	90/64	16.4	
IBT50-SBH90-428		1	378	IBT50-LBK6-350	6	378	350	64	14.1	
BT50-SBH120-202	120-164	157	BT50-BST-100	SBH120	BST	202	100	95	8.9	
BT50-SBH120-252		207	BT50-BST-150			202	150		10.6	
BT50-SBH120-302		257	BT50-BST-200			252	200		13.3	
BT50-SBH120-352		307	BT50-BST-250			302	250		15.3	
BT50-SBH120-402		357	BT50-BST-300			352	300		17.3	
BT50-SBH120-452		407	BT50-BST-350			402	350		19.3	
BT50-SBH120-502		457	BT50-BST-400			452	400		21.3	
BT50-SBH120-502		2	457			BT50-BST-400	452		400	21.3
BT50-SBH160-200	160-204	155	BT50-BST-100	SBH160	BST	200	100	95	13.3	
BT50-SBH160-250		205	BT50-BST-150			200	150		13.8	
BT50-SBH160-300		255	BT50-BST-200			250	200		14.3	
BT50-SBH160-350		305	BT50-BST-250			300	250		16.3	
BT50-SBH160-400		355	BT50-BST-300			350	300		18.3	
BT50-SBH160-450		405	BT50-BST-350			400	350		20.3	
BT50-SBH160-500		455	BT50-BST-400			450	400		22.3	
BT50-SBH160-500		2	455			BT50-BST-400	450		400	22.3

▲ IBT是专为抑制镗孔共振而改良的专用刀杆 IBT is the improved type dedicated to resonance in boring

φ200以上SBH组合式大径粗镗刀系列

Indexable Twin-bit Rough Boring Head SBH<Boring Rang Form φ25-φ204mm>

特色

- 1、通用φ200-φ1250mm大型孔径加工使用。
- 2、粗、精镗刀使用同基础组件，且可另选配附件搭配使用。加工调整范围为φ110mm。SBH600与SBH900调整范围为350mm。
- 3、粗镗刀，具有多种刀片选择，可适用于多种材质及加工方式。
- 4、精镗刀另有铝合金横向滑板，可选用来降低刀具重量。
- 5、另有外圆镗孔组件可选用，加工范围φ20-φ300mm。



Features

1. This type is suitable for large diameter boring with ranges from φ200mm to φ1250mm.
2. The structure includes common flange and extension slide for both rough and finish boring heads. Available can be optional accessories for different works. Adjustment range is within 110mm on diameter. The adjustment rang for bother SBH600 and SBH900 is 350mm.
3. Options of various inserts fou rough boring of different materials and boring styles.
4. Available is the horizontal slide made of Aluminum alloy to reduce total weight.
5. Option of external boring kit with boring range from φ20mm to φ300mm.

规格 Specifications

镗头型号 Boring Head Type	型号 Type		SBH 200	SBH 300	SBH 400	SBH 500	SBH 600	SBH 900
	长度 Length(mm)		130	130	130	130	150	150
整组重量 Total Weight(kg)	合金钢 Alloy Steel	9.5	11.5	13.5	15.5	33	43	
	铝合金 Aluminum Alloy	7.2	8.0	8.8	9.6	16.0	20.7	
加工直径 D(mm) Boring Diameter		200-310	300-410	400-510	500-610	600-910	900-1250	
组合型式 Module	接合刀杆 Taper Shank		BT50-BST/NT50-BST系列 BT50-BST/NT50-BST Series				BT50-FMA-47.625	
	连接器 Flange		BR200				BR600	BR900
	重量(kg) Weight	合金钢 Alloy Steel 铝合金 Aluminum Alloy	合金钢 Alloy Steel 2.7kg				19	29
	重量(kg) Weight	合金钢 Alloy Steel 铝合金 Aluminum Alloy	8.8				8.8	13.5
	横向滑板 Extension Slide		RST200	RST300	RST400	RST500	RST300X2件(pieces)	
	重量(kg) Weight	合金钢 Alloy Steel 铝合金 Aluminum Alloy	3.4	5.4	7.4	9.4	10.8	
	重量(kg) Weight	合金钢 Alloy Steel 铝合金 Aluminum Alloy	1.1	1.9	2.7	3.5	3.8	
	滑块 Clamp Base		RS200					
	重量(kg) Weight		0.98kg					
	刀片座垫片 Height Setting Shin		RS201					
重量(kg) Weight		0.05kg						
刀片座 Insert Holder		RB200C12	RB200T16	RB200T22	RB200S12			
适合刀片 Applicable Insert		CCMT120404	TCMT16T304	TCMT220404	SCMT120404			
重量(kg) Weight		0.68kg						

φ200以上SBH组合式大径双刃粗镗刀+BST刀柄 (MAS 403BT)

SBH Indexable Twin-bit Rough Boring Head For Large Hole Boring+BST Shank <MAS 403BT>

《镗孔范围 φ200-φ1250mm》
《Boring Range From φ200-φ1250mm》

镗头型号 Boring Head Type	接合型号 LBK No.	镗孔范围 φ Dmm Boring Range	镗头长度mm Length	刀片规格 Insert	重量 KG	
					合金钢 Alloy Steel	铝合金 Aluminum Alloy
	BST series	200-310	130	(适配刀片座) Optional Inserts CCMT120408	9.5	7.2
		300-410			11.5	8.0
		400-510			13.5	8.8
		500-610			15.5	9.6
		600-910			33.0	16.0
SBH900-1250	FMA-47.625	900-1250	150		43.0	20.7

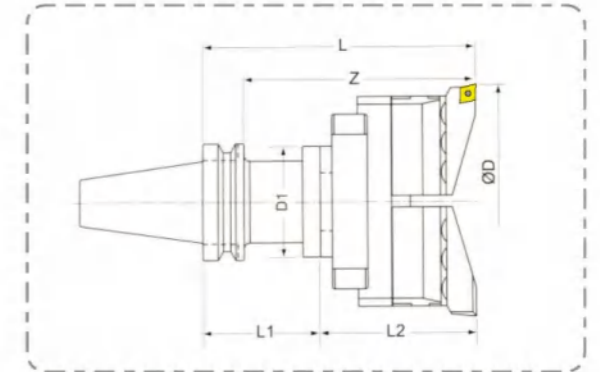

规格 Specifications

型号 Type	镗孔范围 φ (Dmm)	有效长 Z	组合内容 Tool Connection		接合型号 LBK No	全长 L	刀杆长 L1	刀杆外径 D1	重量 KG	
			LBK刀杆 LBK shank	SBH刀座 SBH boring head					合金钢 Alloy Steel	铝合金 Aluminum Alloy
BT50-SBH200-230	200-310	185	BT50-BST-100	SBH200	BST	230	100	95	14.6	12.3
BT50-SBH200-280		235	BT50-BST-150			280	150		16.3	14
BT50-SBH200-330		285	BT50-BST-200			330	200		19	16.7
BT50-SBH200-380		335	BT50-BST-250			380	250		21	18.7
BT50-SBH200-430		385	BT50-BST-300			430	300		23	20.7
BT50-SBH200-480		435	BT50-BST-350			480	350		25	22.7
BT50-SBH200-530		485	BT50-BST-400			530	400	27	24.7	
BT50-SBH300-230	300-410	185	BT50-BST-100	SBH300	BST	230	100	95	16.6	13.1
BT50-SBH300-280		235	BT50-BST-150			280	150		18.3	14.8
BT50-SBH300-330		285	BT50-BST-200			330	200		21	17.5
BT50-SBH300-380		335	BT50-BST-250			380	250		23	19.5
BT50-SBH300-430		385	BT50-BST-300			430	300		25	21.5
BT50-SBH300-480		435	BT50-BST-350			480	350		27	23.5
BT50-SBH300-530		485	BT50-BST-400			530	400	29	25.5	
BT50-SBH400-230	400-510	185	BT50-BST-100	SBH400	BST	230	100	95	18.6	13.9
BT50-SBH400-280		235	BT50-BST-150			280	150		20.3	15.6
BT50-SBH400-330		285	BT50-BST-200			330	200		23	18.3
BT50-SBH400-380		335	BT50-BST-250			380	250		25	20.3
BT50-SBH400-430		385	BT50-BST-300			430	300		27	22.3
BT50-SBH400-480		435	BT50-BST-350			480	350		29	24.3
BT50-SBH400-530		485	BT50-BST-400			530	400	31	26.3	
BT50-SBH500-230	500-610	185	BT50-BST-100	SBH500	BST	230	100	95	20.6	14.7
BT50-SBH500-280		235	BT50-BST-150			280	150		22.3	16.4
BT50-SBH500-330		285	BT50-BST-200			330	200		25	19.1
BT50-SBH500-380		335	BT50-BST-250			380	250		27	21.1
BT50-SBH500-430		385	BT50-BST-300			430	300		29	23.1
BT50-SBH500-480		435	BT50-BST-350			480	350		31	25.1
BT50-SBH500-530		485	BT50-BST-400			530	400	33	27.1	
BT50-SBH600-230	600-910	185	BT50-	SBH600	FMA	230	75	128	40	23
BT50-SBH900-230	900-1250		FMA47.625-75	SBH900	47.625				50	27.7

SBH非标类粗镗刀

微调结构



特色

1. 采用独特高低差形式，1个刀座采用微调结构设计。
2. 适用于余量适中，精度要求低的零件。
3. 粗精镗一次完成加工，效率要求低的零件。

Features

1. Adopt the unique shape of height difference, the insert holder use the fine-tune structure.
2. Suitable for workpiece of moderate margin and low accuracy.
3. Finish the rough boring and fine boring in one time, with high efficiency, low cost.



特色

1. 自主研发刀粒经济实用成本低效率高。
2. 采用SN型刀粒，每个刀粒可更换8次使用。
3. 适用于200以上的大径切削镗孔。

Features

1. Originally created and independently researched and developed by LPK, economical and practical, with low cost and high efficiency.
2. Use SN type inserts, every insert is replaceable for 8 times when using.
3. Suitable for boring holes of large diameter above $\phi 200\text{mm}$

WBH微调式精镗刀系列
WBH adjustable fine boring knife

有预平衡设计，可获得稳定的加工精度。
There are pre-balanced design, availability and stability of the machining accuracy.

标准对应反镗工加工，适用范围广，增大附加价值。
Standard corresponding to the anti-boring work processing, using a wide range of increasing added value.

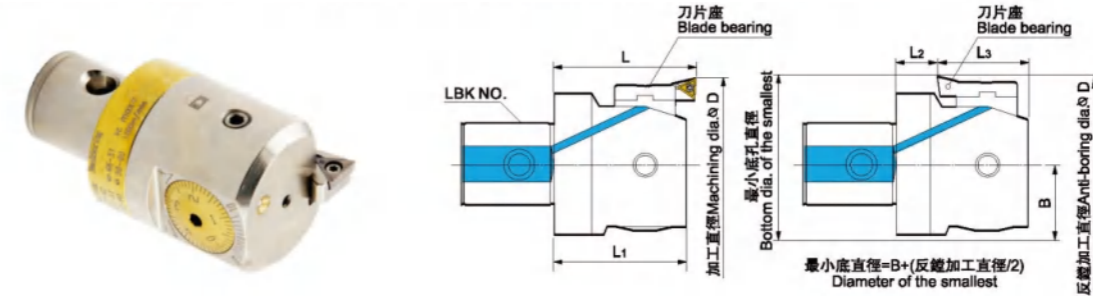

规格 Specifications

型号 Type	接口型号 LBK NO	刀片座 Blade Block	正镗 Is boring		反镗 Anti-boring			重量 KG	适用刀片 Blade		
			加工范围	L L1	加工范围	L2 L3 B					
WBH20-36 LBK1	LBK1	WBH1-1	20-26	32	29.5	---	10.5	19	10	0.07	TP08/M2.2/T7
		WBH1-2	25-31			30-31					
		WBH1-3	30-36			30-36					
WBH25-47 LBK2	LBK2	WBH2-1	25-33	32	29.5	---	11.5	21	12.5	0.12	
		WBH2-2	32-40			36-40					
		WBH2-3	39-47			39-47					
WBH32-60 LBK3	LBK3	WBH3-1	32-42	38	35	---	10	25	16	0.21	
		WBH3-2	41-51			46-51					
		WBH3-3	50-60			50-60					
WBH41-74 LBK4	LBK4	WBH4-1	41-54	46	43	---	14	29	20	0.40	
		WBH4-2	50-63			53-63					
		WBH4-3	61-74			61-74					
WBH53-95 LBK5	LBK5	WBH5-1	53-70	56	53	62-70	19	34	25.5	1.10	
		WBH5-2	65-82			65-82					
		WBH5-3	78-95			78-95					
WBH68-150 LBK6	LBK6	WBH6-1	68-100	71	67.2	80-100	22	45.2	32.5	1.74	TP11/M3/T8 TC11/M2.5/T8
		WBH6-2	94-126			94-126					
		WBH6-3	118-150			118-150					
WBH100-203 LBK6	LBK6	WBH6-1	100-153	78	67.2	112-153	22	45.2	45.5	2.46	
		WBH6-2	126-179			126-179					
		WBH6-3	150-203			150-203					
WBH150-253 LBK6	LBK6	WBH6-1	150-203	88	67.2	162-203	22	45.2	70.5	4.20	
		WBH6-2	176-229			176-229					
		WBH6-3	200-253			200-253					

刀片座 PAT.P



注意 WBH镗头自身允许最高切削速度为1200m/min，但实际加工时还与基础柄的长度、机器及工件的刚性等周边条件有关。请再容许范围内选择最合适的加工条件。

型号	形状图	对应镗头	型号	形状图	对应镗头	型号	形状图	对应镗头
WBH1-1	[Diagram]	WBH20-36	WBH4-1	[Diagram]	WBH41-74	WBH1-1E	[Diagram]	WBH41-74
WBH1-2			WBH4-2			WBH1-2E		
WBH1-3			WBH4-3			WBH1-3E		
WBH2-1	[Diagram]	WBH25-47	WBH5-1	[Diagram]	WBH53-95	WBH2-1E	[Diagram]	WBH53-95
WBH2-2			WBH5-2			WBH2-2E		
WBH2-3			WBH5-3			WBH2-3E		
WBH3-1	[Diagram]	WBH32-60	WBH6-1	[Diagram]	WBH68-150 WBH68-150 WBH100-203 WBH150-253	WBH3-1E	[Diagram]	WBH68-150 WBH68-150 WBH100-203 WBH150-253
WBH3-2			WBH6-2			WBH3-2E		
WBH3-3			WBH6-3			WBH3-3E		

不附带刀片，请另外订购。

CBH微调式精镗刀系列
CBH adjustable fine boring knife

有预平衡设计，可获得稳定的加工精度。
There are pre-balanced design, availability and stability of the machining accuracy.
标准对应反镗工加工，适用范围广，增大附加价值。
Standard corresponding to the anti-boring work processing, using a wide range of increasing added value.

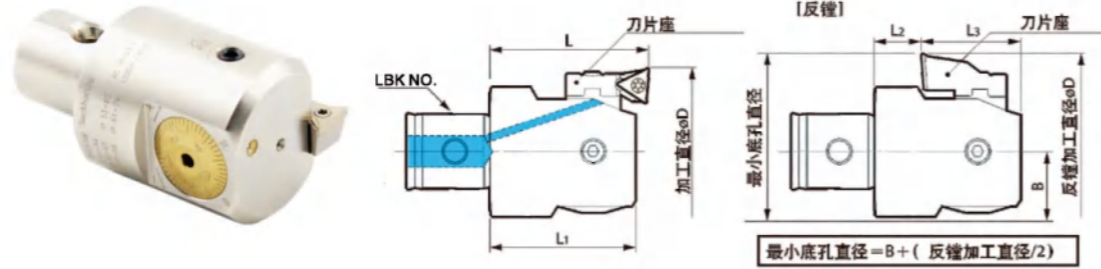

规格 Specifications

型号 Tape	接口型号 LBK NO	刀片座 Blade Block	正镗 Is boring			反镗 Anti-boring				重量 KG	适用刀片 Blade
			加工范围	L	L1	加工范围	L2	L3	B		
CBH20-36 LBK1	LBK1	WBH1-1	20-26	32	29.5	---	10.5	19	10	0.07	TP08/M2.2/T7
			25-31			30-31					
			30-36			30-36					
CBH25-47 LBK2	LBK2	WBH2-1	25-33	32	29.5	---	11.5	21	12.5	0.12	
			32-40			36-40					
			39-47			39-47					
CBH32-60 LBK3	LBK3	WBH3-1	32-42	38	35	---	10	25	16	0.21	
			41-51			46-51					
			50-60			50-60					
CBH41-74 LBK4	LBK4	WBH4-1	41-54	46	43	---	14	29	20	0.40	
			50-63			53-63					
			61-74			61-74					
CBH53-95 LBK5	LBK5	WBH5-1	53-70	56	53	---	19	34	25.5	1.10	
			65-82			65-82					
			78-95			78-95					
CBH68-150 LBK6	LBK6	WBH6-1	68-100	71	67.2	---	22	45.2	32.5	1.74	
			94-126			94-126					
			118-150			118-150					
CBH100-203 LBK6	LBK6	WBH6-1	100-153	78	67.2	---	22	45.2	45.5	2.46	
			126-179			126-179					
			150-203			150-203					
CBH150-253 LBK6	LBK6	WBH6-1	150-203	88	67.2	---	22	45.2	70.5	4.20	
			176-229			162-203					
			200-253			176-229					

刀片座 PAT.P

型号	形状图	对应镗头	型号	形状图	对应镗头	型号	形状图	对应镗头
WBH1-1		WBH20-36	WBH4-1		WBH41-74	WBH1-1E		WBH41-74
WBH1-2			WBH4-2			WBH1-2E		
WBH1-3			WBH4-3			WBH1-3E		
WBH2-1		WBH25-47	WBH5-1		WBH53-95	WBH2-1E		WBH53-95
WBH2-2			WBH5-2			WBH2-2E		
WBH2-3			WBH5-3			WBH2-3E		
WBH3-1		WBH32-60	WBH6-1		WBH68-150 WBH68-150 WBH100-203 WBH150-253	WBH3-1E		WBH68-150 WBH68-150 WBH100-203 WBH150-253
WBH3-2			WBH6-2			WBH3-2E		
WBH3-3			WBH6-3			WBH3-3E		

注意 WBH镗头自身允许最高切削速度为1200m/min，但实际加工时还与基础柄的长度、机器及工件的刚性等周边条件有关。请再容许范围内选择最合适的加工条件。

不附带刀片，请另外订购。

了解具体库存情况请致电厂家 详情请登陆网站www.hnsant.com

WBH(CBH) 微调式精镗刀组合系列
WBH(CBH) adjustable fine boring knife

型号 Tape	样式 Fig.	有效长 Z	组合内容 Tool Connection		接口型号 LBK No	全长 L	刀杆长 L1	刀杆外径 D1	重量 KG		
			LBK刀杆 LBK shank	WBH刀头 WBH boring head							
BT30-WBH20-105	2	75	BT30-LBK1-70	WBH20	1	100	70	19	0.6		
BT30-WBH25-120		90	BT30-LBK2-80	WBH25	2	115	80	24	0.8		
BT30-WBH32-120		BT30-LBK3-80	WBH32	3	31		1.0				
BT30-WBH41-120		BT30-LBK4-70	WBH41	4	70		39	1.3			
BT30-WBH53-120		BT30-LBK5-60	WBH53	5	60		50	1.8			
BT30-WBH68-130		BT30-LBK6-60	WBH68	6	125		64	3.0			
BT40-WBH20-110	2	75	BT40-LBK1-75	WBH20	1		105	75	19	1.1	
BT40-WBH20-140		105	BT40-LBK1-105	WBH25	2	135	105	24	1.3		
BT40-WBH25-125		90	BT40-LBK2-85		120	85	24	1.3			
BT40-WBH25-155		120	BT40-LBK2-115		150	115	24	1.6			
BT40-WBH32-135		100	BT40-LBK3-95		130	95	31	1.5			
BT40-WBH32-165		130	BT40-LBK3-125		160	125	31	1.8			
BT40-WBH32-195		160	BT40-LBK3-155		190	155	31	2.0			
BT40-WBH41-135		100	BT40-LBK4-85	WBH41	4	130	85	39	1.8		
BT40-WBH41-180		145	BT40-LBK4-130		175	130	39	2.4			
BT40-WBH41-225		190	BT40-LBK4-175		220	175	39	2.7			
BT40-WBH53-135		100	BT40-LBK5-75		130	75	50	2.3			
BT40-WBH53-185		150	BT40-LBK5-125	180	125	50	3.3				
BT40-WBH53-235	200	BT40-LBK5-175	230	175	50	4.0					
BT40-WBH68-135	100	BT40-LBK6-65	WBH68	6	130	65	64	3.3			
BT40-WBH68-185	150	BT40-LBK6-115			180	115	64	4.7			
BT40-WBH68-235	200	BT40-LBK6-165			230	165	64	5.9			
BT40-WBH100-135	100	BT40-LBK6-65	WBH100		5	130	65	64	4.2		
BT40-WBH100-185	150	BT40-LBK6-115				180	115	64	5.6		
BT40-WBH100-235	200	BT40-LBK6-165				230	165	64	6.8		
BT50-WBH20-150	1	75		BT50-LBK1-115		WBH20	1	145	115	31/19	4.1
BT50-WBH20-180		105	BT50-LBK1-145	175		145	31/19	4.2			
BT50-WBH25-150		105	BT50-LBK2-110	WBH25		2	145	110	24	4.1	
BT50-WBH25-180		135	BT50-LBK2-140		175	140	24	4.2			
BT50-WBH32-165		120	BT50-LBK3-125	WBH32	3	160	125	31	4.4		
BT50-WBH32-195		150	BT50-LBK3-155		190	155	31	4.5			
BT50-WBH41-165		2	120	BT50-LBK4-115	WBH41	4	160	115	39	4.8	
BT50-WBH41-195			150	BT50-LBK4-145			190	145	39	4.9	
BT50-WBH41-225			180	BT50-LBK4-175			220	175	39	5.3	
BT50-WBH41-255			210	BT50-LBK4-205			220	205	39	5.4	
BT50-WBH53-165			120	BT50-LBK5-105	WBH53		5	160	108	50	5.5
BT50-WBH53-240			195	BT50-LBK5-180				235	180	50	6.5
BT50-WBH53-300	255	BT50-LBK5-240	295	240		50		7.2			
BT50-WBH53-360	1	255	BT50-LBK5-300	355	300	64/50		8.6			
BT50-WBH68-165	2	120	BT50-LBK6-95	WBH68	6	160		95	64	6.5	
BT50-WBH68-240		195	BT50-LBK6-170			235		170	64	8.3	
BT50-WBH68-300	255	BT50-LBK6-230	295			230	64	9.6			
BT50-WBH68-360	315	BT50-LBK6-290	355			290	64	11.0			
BT50-WBH68-420	1	375	BT50-LBK6-350			415	350	90/64	15.5		
IBT50-WBH68-420	2	375	IBT50-LBK6-350			415	350	64	13.2		
BT50-WBH100-165	2	120	BT50-LBK6-95	WBH100		6	160	95	64	7.4	
BT50-WBH100-240		195	BT50-LBK6-170				235	170	64	9.2	
BT50-WBH100-300		255	BT50-LBK6-230				295	230	64	10.5	
BT50-WBH100-360		315	BT50-LBK6-290				355	290	64	11.9	
BT50-WBH100-420		1	375				BT50-LBK6-350	415	350	90/64	16.4
IBT50-WBH100-420		2	375				IBT50-LBK6-350	415	350	64	14.1
BT50-WBH150-165	2	120	BT50-LBK150-165	WBH150	6		165	95	64	8.7	
BT50-WBH150-240		195	BT50-LBK150-240				240	170	64	10.5	
BT50-WBH150-300		255	BT50-LBK150-300				300	230	64	11.8	
BT50-WBH150-360		315	BT50-LBK150-360				360	290	64	13.2	
BT50-WBH150-420		1	375				BT50-LBK150-420	420	350	90/64	17.7
IBT50-WBH150-420		2	375				IBT50-LBK150-420	420	350	64	15.4

了解具体库存情况请致电厂家 详情请登陆网站www.hnsant.com

φ200以上WBH大孔径微调精镗刀+BST刀柄 (MAS 403BT)

WBH Large Diameter Modular Finish Boring Head+BST Shank(MAS 403BT)

《镗孔范围 φ200-φ1250mm》

《Boring Range from φ200-φ1250mm》

镗头型号 Boring Head Type	接合型号 LBK No.	镗孔范围 φ Dmm Boring Range	镗头长度 L2 mm	刀片规格/螺丝/扳手 Insert/ Clamp Screw/ Wrench	重量 KG	
					合金钢 Alloy Steel	铝合金 Aluminum Alloy
WBH200	BST系列 BST series	200~310	130	TC11/M2.5/T8	9.7	7.0
WBH300		300~410			11.7	7.8
WBH400		400~510			13.7	8.6
WBH500		500~610			15.7	9.4
WBH600	FMA-47.625	600~910	150	TP11/M3.0/T8	33.0	15.8
WBH900		900~1250			43.0	20.5

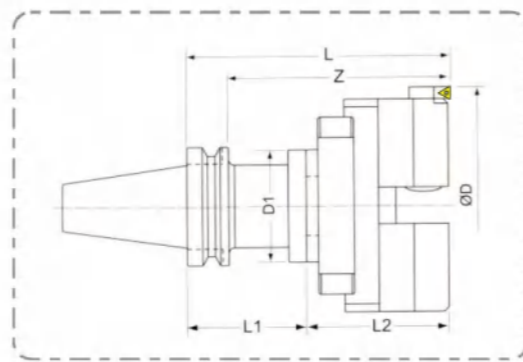

规格 Specifications

型号 Tape	镗孔范围 φ (Dmm)	有效长 Z	组合内容 Tool Connection		接合型号 LBK No.	全长 L	刀杆长 L1	刀杆外径 D1	重量 KG			
			LBK刀杆 LBK shank	WBH刀头 WBH boring head					合金钢 Alloy Steel	铝合金 Aluminum Alloy		
BT50-WBH200-230	200~310	185	BT50-BST-100	WBH200	BST	230	100	95	14.8	12.1		
BT50-WBH200-280		235	BT50-BST-150			280	150		16.5	13.8		
BT50-WBH200-330		285	BT50-BST-200			330	200		19.2	16.5		
BT50-WBH200-380		335	BT50-BST-250			380	250		21.2	18.5		
BT50-WBH200-430		385	BT50-BST-300			430	300		23.2	20.5		
BT50-WBH200-480		435	BT50-BST-350			480	350		25.2	22.5		
BT50-WBH200-530		485	BT50-BST-400			530	400		27.2	24.5		
BT50-WBH300-230		300~410	185			BT50-BST-100	WBH300		230	100	16.8	12.9
BT50-WBH300-280			235			BT50-BST-150			280	150	18.5	14.6
BT50-WBH300-330			285			BT50-BST-200			330	200	21.2	17.3
BT50-WBH300-380	335		BT50-BST-250	380	250	23.2		19.3				
BT50-WBH300-430	385		BT50-BST-300	430	300	25.2		21.3				
BT50-WBH300-480	435		BT50-BST-350	480	350	27.2		23.3				
BT50-WBH300-530	485	BT50-BST-400	530	400	29.2	25.3						
BT50-WBH400-230	400~510	185	BT50-BST-100	WBH400	230	100	18.8	13.7				
BT50-WBH400-280		235	BT50-BST-150		280	150	20.5	15.4				
BT50-WBH400-330		285	BT50-BST-200		330	200	23.2	18.1				
BT50-WBH400-380		335	BT50-BST-250		380	250	25.2	20.1				
BT50-WBH400-430		385	BT50-BST-300		430	300	27.2	22.1				
BT50-WBH400-480		435	BT50-BST-350		480	350	29.2	24.1				
BT50-WBH400-530		485	BT50-BST-400		530	400	31.5	26.1				
BT50-WBH500-230		500~610	185		BT50-BST-100	WBH500	230	100	20.8	14.5		
BT50-WBH500-280	235		BT50-BST-150	280	150		22.5	16.2				
BT50-WBH500-330	285		BT50-BST-200	330	200		25.2	18.9				
BT50-WBH500-380	335		BT50-BST-250	380	250		27.2	20.9				
BT50-WBH500-430	385		BT50-BST-300	430	300		29.2	22.9				
BT50-WBH500-480	435		BT50-BST-350	480	350		31.2	24.9				
BT50-WBH500-530	485	BT50-BST-400	530	400	33.2	26.9						
BT50-WBH600-230	600~910	185	BT50-	WBH600	FMA	230	75	128	40.0	22.8		
BT50-WBH900-230	900~1250	185	FMA47.625-75	WBH900	47.625	230	75	128	50.0	27.5		

WBJ16 微调精镗孔系统

WBJ16 Fine-tune the Precision Boring System



规格 Specifications

型号 Cat. No	镗孔范围 Boring Range	调整精度 Tuning precision	调整行程 Stroke	重量 Weight (KG)
WBJ 16	φ6~φ51	φ0.01mm/格	6.0mm	1.2

型号 Cat. No	镗孔范围 Boring Range	D	DM	L	适用刀片 Applicable inserts	螺钉 Clamp screw	扳手 spanner	重量 Weight (KG)
SBJ1606-24 (选配)	6~9	16	24	73	WBGT0601..L	M2X4	T6	0.014
SBJ1608-32	8~11		32	80	TBGT0601..L	M2X5		0.077
SBJ1610-40	10~13		40	87				0.082
SBJ1612-53	12~15		53	98	TPGH0902..L	M2.5X6	T8	0.095
SBJ1616-68	16~21		68	110				0.143
SBJ1620-83	20~26		83	125	TPGH1103..L	M3.0X7	T8	0.203
SBJ1625-90	25~31		90	128				0.275
SBJ1630-90	30~41		90	128				0.275
SBJ1640-90	40~51		90	128				0.286

WBJ16 微调精镗孔系统 (含8只镗杆)

WBJ16 Fine-tune the Precision Boring System (8PCS)



规格 Specifications

型号 Cat. No	镗孔范围 Boring Range	主轴柄规格 Spindle handle models	镗头型号 Head NO	镗刀杆 Bar keep out	重量 Weight (KG)
BT40-WBJ16-8P	6~51	BT40-LBK6-55	WBJ16	WBJ-16..	9.1
BT50-WBJ16-8P	6~51	BT50-LBK6-65		WBJ-16..	11.7
NT40-WBJ16-8P	6~51	NT40-LBK6-55		WBJ-16..	8.5
NT50-WBJ16-8P	6~51	NT50-LBK6-65		WBJ-16..	10.3
SK40-WBJ16-8P	6~51	SK40-LBK6-55		WBJ-16..	8.9
SK50-WBJ16-8P	6~51	SK50-LBK6-65		WBJ-16..	10.5

NBH2084 微调精镗孔系统

NBH2084 Fine-tune the Precision Boring System

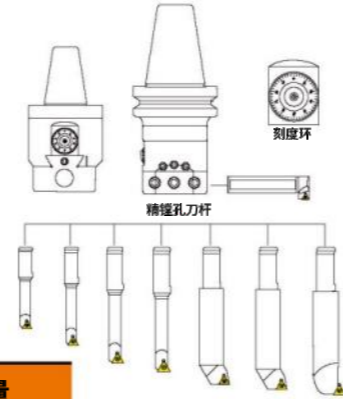

规格 Specifications

型号 Cat. No	镗孔范围 Boring Range	调整精度 Tuning precision	调整行程 Stroke	重量 Weight (KG)
NBH2084	Φ8 ~ Φ280	Φ0.01mm/格	28.0mm	3.0

型号 Cat. No	镗孔范围 Boring Range	D	L1	L	适用刀片 Applicable inserts	螺钉 Clamp screw	扳手 spanner	重量 Weight (KG)
SBJ2008-32	8 ~ 11	20	32	80	TBGT0601..L	M2.0X5	T6	0.095
SBJ2010-40	10 ~ 13		40	87	TPGH0902..L	M2.5X6	T8	0.095
SBJ2012-53	12 ~ 17		53	98				0.12
SBJ2016-68	16 ~ 21		68	110	TPGH1103..L	M3.0X7	T8	0.16
SBJ2020-83	20 ~ 130		83	123				0.22
SBJ2025-96	25 ~ 135		96	137				0.34
SBJ2030-115	30 ~ 140		115	152				0.54
SBJ20-L20-100	120 ~ 280		84+BTL1	100				0.23

NBH2084 微调精镗孔系统 (套装)

NBH2084 Fine-tune the Precision Boring System(Set)



规格 Specifications

型号 Cat. No	镗孔范围 Boring Range	主轴柄规格 Spinde handle models	镗头型号 Head NO	镗刀杆 Bar keep out	重量 Weight (KG)
BT40-NBH2084-8P	08 ~ 280	BT40-NBH-50	NBH2084	WBJ-20..	9.5
BT50-NBH2084-8P	08 ~ 280	BT50-NBH-55			12.0
NT40-NBH2084-8P	08 ~ 280	NT40-NBH-50			9.3
NT50-NBH2084-8P	08 ~ 280	NT50-NBH-55			10.8
SK40-NBH2084-8P	08 ~ 280	SK40-NBH-50			9.5
SK50-NBH2084-8P	08 ~ 280	SK50-NBH-55			12.0
R8-NBH2084-8P	08 ~ 280	R8-NBH-50			10.0

可接受以下各种组合非标刀具定制

侧固式



2° 侧固



7:24接口

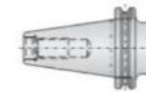

TMG21接口

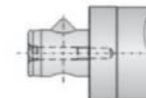

KB接口

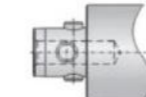

HSK

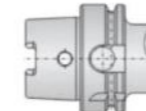

面铣刀接口

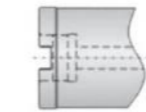

XME接口

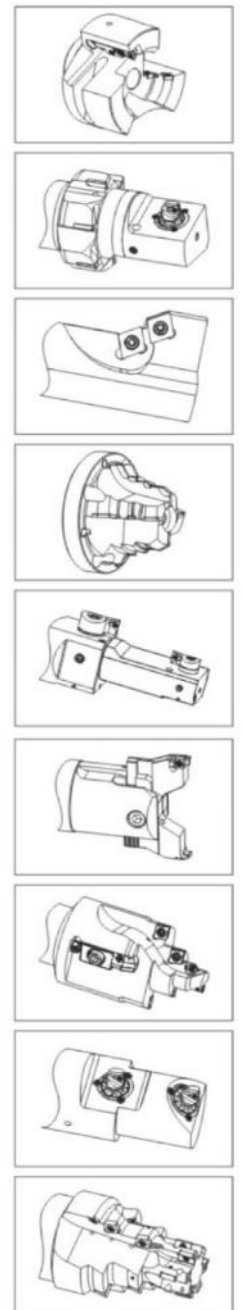
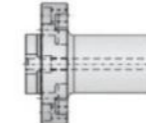

非标镗刀技术特点:

- 任意组合
各部分在一定范围内可以进行任意组合, 形成组合镗削刀具。
- 多种工序
多种工序可组合在一把刀具内, 并且可在一次进给内完成。
- 灵活件
镗削单元可由刀片、小刀夹、精镗单元等切削单元根据需要任意组合成组合镗刀。

微调刀座

Mini Adjustable Cartridge

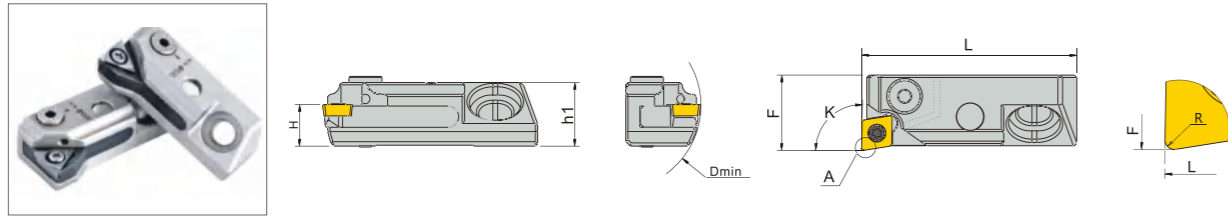

★ 刀具规格型号 Type of milling tools

型号 Type		基本尺寸 (mm) Dimension							适用刀片 Suitable Insert
右手型号 Right hand	左手型号 Left hand	K	H	F	L	h1	Dmin	R	
STR90 F16.CC06	STL90 F16.CC06	90	8.8	16	45.6	13.5	28	0.4	CC.0602..
STR95 F16.CC06	STL95 F16.CC06	95	8.8	16	45.6	13.5	28	0.4	CC.0602..
STR90 F16.TP09	STL90 F16.TP09	90	8.8	16	45.6	13.5	28	0.4	TP.0902..
STR95 F16.TP09	STL95 F16.TP09	95	8.8	16	45.6	13.5	28	0.4	TP.0902..
STR90 F20.TC11	STL90 F20.TC11	90	8.8	20	45.6	13.5	36	0.4	TC..1102..
STR95 F20.TC11	STL95 F20.TC11	95	8.8	20	45.6	13.5	36	0.4	TC..1102..
STR90 F20.TP11	STL90 F20.TP11	90	8.8	20	45.6	13.5	36	0.4	TP..1103..
STR95 F20.TP11	STL95 F20.TP11	95	8.8	20	45.6	13.5	36	0.4	TP..1103..
STR30 F16.DC07	STL30 F16.DC07	120	8.8	16	48.5	13.5	28	0.4	DC..0702..

- 刀片请根据不同材料单独订购。 Inserts with different materials should be ordered separately
- 常备库存有左手和右手型号。 There are right and left hand specifications available in stock.
- 微调精度直径 0.01mm、半径 0.005mm。 The adjustment: 0.01 mm on diameter and 0.005mm on radius.
- 径向最大调整量直径 0.6mm, 轴向调整量 1mm。 The adjustment range: 0.6mm on diameter by radial direction, 1 mm on diameter by axial direction.

备件

Spare Parts



刀片型号 Insert	刀片锁紧螺钉 Clamping screw insert	轴向调整螺钉 Axial adjusting screw	刀座锁紧螺钉 Clamping screw for cartridge	轴向调整环 Axial adjusting ring	刀片锁紧扳手 Allen key for clamping screw	径向调整扳手 Allen key for radial adjusting	压紧扳手 Allen key for clamping	径向调整扳手 Allen key for radial adjusting
CC..0602..	SR21 M2.5x5.3	SR57 M5X16	SR55 M5x20	HFX.3	KEY02 T7	KEY01 M2.5	KEY01 M4	KEY01 M3
TP..0902..	SR22 M2.5x6	SR57 M5X16	SR55 M5x20	HFX.3	KEY02 T8	KEY01 M2.5	KEY01 M4	KEY01 M3
TC..1102..	SR21 M2.5x5.3	SR57 M5X16	SR55 M5x20	HFX.3	KEY02 T7	KEY01 M2.5	KEY01 M4	KEY01 M3
TP..1103..	SR22 M3x6	SR57 M5X16	SR55 M5x20	HFX.3	KEY02 T8	KEY01 M2.5	KEY01 M4	KEY01 M3

微调刀座安装尺寸

Assembly Instruction for Mini Adjustable Cartridge

图示按照右手 R.H 刀座的方向设置。 The figure is for the right hand specification.

使用左手 L.H 刀座时请按照镜像的方式设置。 For the left hand specification, please refer to the opposite figure. Setting Instruction

刀座安装尺寸

Assembly Instruction

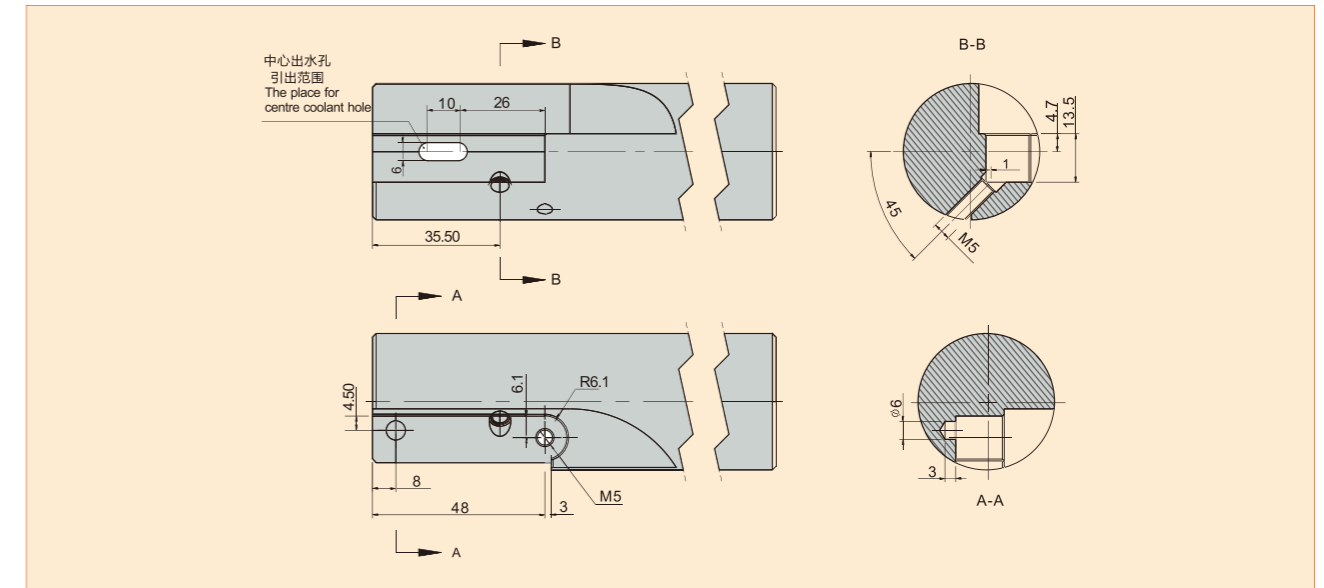

刀座调节方法

Adjustment Instruction

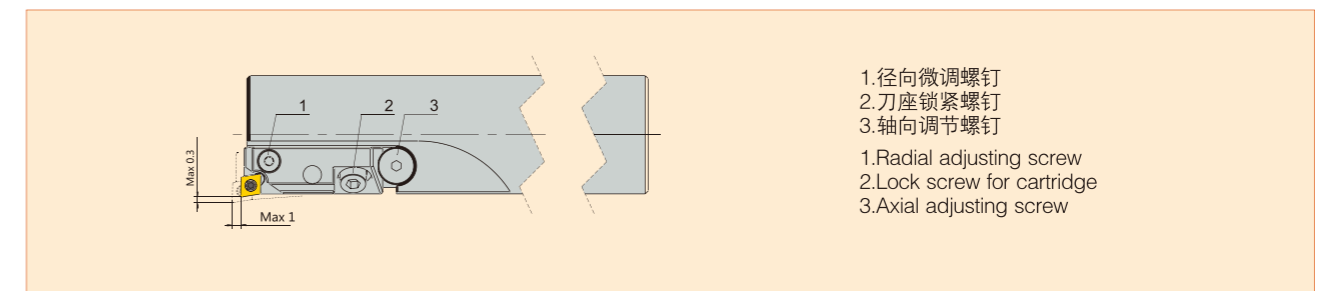

轴向调节方法

Adjusting on axial direction

- 稍微松开刀座锁紧螺钉 2。
- 顺时针旋转轴向调节螺钉 3, 刀座向前移动至需要的尺寸。
- 夹紧刀座锁紧螺钉 2。
- Loosening the 2# lock screw lightly.
- Rotating the 3# axial adjusting screw on the anticlockwise direction, so that the cartridge can be moved forward to the required size.
- Tightening the 2# lock screw firmly.

注意: 如果刀座需要向后调节, 应当松开刀座锁紧螺钉, 并把刀座移动到后面, 然后逐渐向前调节直到需要的尺寸。

Note: If the cartridge should be moved backward, please loosen the lock screw, and then move the cartridge to the back, finally adjust the cartridge to forward little by little to meet the required size.

刀具直径调节方法

Adjusting on radial direction

- 顺时针方向旋转径向调节螺钉 1, 刀具直径逐渐变大。
- 逆时针方向旋转径向调节螺钉 1, 刀具直径逐渐变小。
- 径向微调螺钉调节是每旋转一个刻度, 刀具直径变化 0.01mm。
- Rotating the 1# radial adjusting screw on the clockwise direction, so that the diameter of tool will be larger and larger.
- Rotating the 1# radial adjusting screw on the anticlockwise direction, so that the diameter of tool will be smaller and smaller.
- The adjustment on diameter: 0.01mm as per dial.

R/L 148C 精镗单元

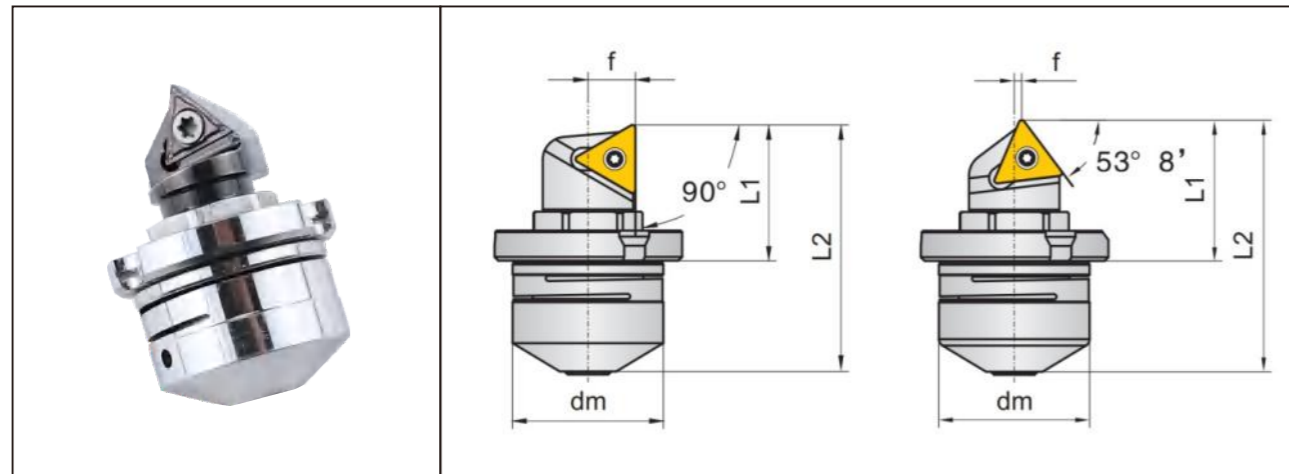

★ 调节量 (尺寸): 0.02mm/格

左手刀图例

型号 Type	基本尺寸 (mm) Dimension						刀片 Insert	螺钉 Screw	扳手 Wrench
	dm	l1	l2min	f	Dmin	Rmax			
L148C-11-0602	16	10.1	24.1	5.1	27.6	2.5	CC..060204	L60 M2.5X5.2	T8
L148C-12-0902	20	14.3	32.9	6.3	37.1	3.5	TC..090204	L60 M2.2X5.0	T6
L148C-13-1102	22	17.1	44.3	7.2	49.1	6	TC..110204	L60 M2.5X5.2	T8
L148C-14-16T3	32	25.7	62.7	10.3	69	10	TC..16T308	L60 M4X8	T15
L148C-31-0602	16	11.3	25.15	0.45	25.9	2	CC..060204	L60 M2.5X5.2	T8
L148C-32-0902	20	15.3	33.7	0.9	33.1	2.8	TC..090204	L60 M2.2X5.0	T6
L148C-33-1102	22	18	45.3	1.1	42.6	4.8	TC..110204	L60 M2.5X5.2	T8
L148C-34-16T3	32	27	62.3	1.2	60	8	TC..16T308	L60 M4X8	T15

· L2 系刀尖圆弧为r=0 时尺寸
· 定货示例: 1件L148C-11-0602

R/L 148C 精镗单元

特点:

- 能加工盲孔
- 从前端调整
- 镗头具有自锁性, 即在调整前不需解锁, 调整后不需锁紧。

注意:

- 调整倾斜安装精镗单元时, 调整刀具径向尺寸时, 刀具轴向位移量=径向位移量/tan 53° 8'
- 不要将精镗单元调出相应精镗单元的最大调整范围, 如果超出调整范围, 精镗单元可能因此而损坏。



精镗单元安装尺寸

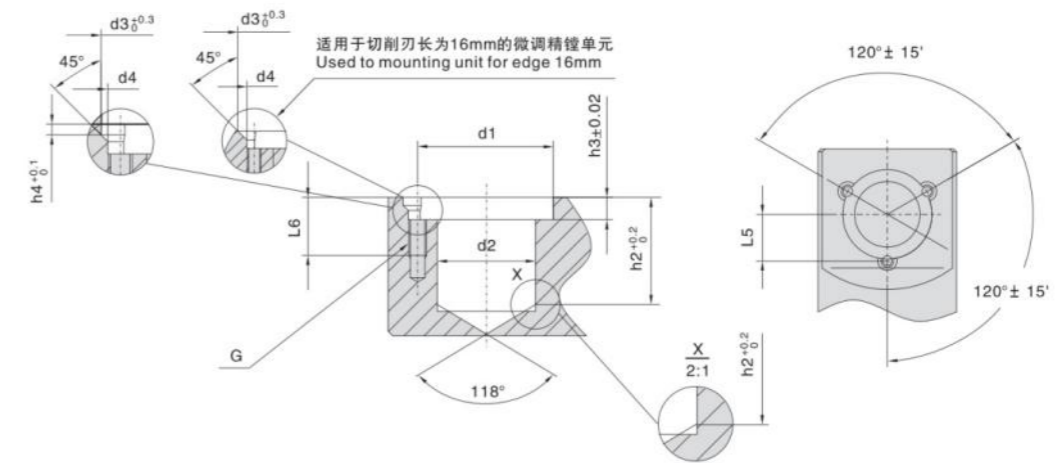

型号	h2	h3	h4	d1	d2	d3	d4	G	l6	l5
L148C-xx-0602	11.5	2.8	1.9	19	16	4.6	3.2	M3	9	9.8±0.02
L148C-xx-0902	15.5	4.0	1.6	25	20	4.6	3.2	M3	9	12.5±0.02
L148C-xx-1102	24.0	5.0	1.8	30	22	6.5	4.3	M4	13	15.4±0.02
L148C-xx-16T3	33.0	6.3	-	46	32	11.9	5.4	M5	16	23.0±0.02

BT-BSB 90° 直角粗镗刀
BT-BSB 90° angle Rough Boring Tool

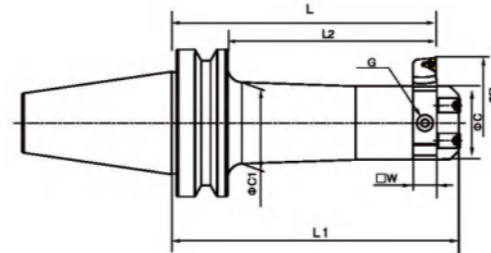

型号 Cat. No	范围 ϕD		L	L1	L2	L3	ϕC	$\phi C1$	W	G	净重 KG
	min	max									
BT40-BSB 25-135	25	52	135	150	105	50	20	22	8	M8	1.5
BT40-BSB 38-165	38	70	165	180	135	70	30	33	10	M10	2.0
BT40-BSB 50-165	50	90	165	180	135	85	40	44	13	M10	2.8
BT40-BSB 50-210	50	90	210	225	180	85	40	44	13	M10	3.3
BT40-BSB 62-165	62	115	165	180	135	—	50	—	16	M10	4.0
BT40-BSB 62-225	62	115	225	240	195	95	50	56	16	M10	5.0
BT40-BSB 72-165	72	135	165	180	135	—	60	—	19	M10	4.8
BT40-BSB 72-225	72	135	225	240	195	—	60	—	19	M10	6.1
BT40-BSB 90-165	90	150	165	180	135	60	75	—	19	M12	7.1
BT40-BSB 90-210	90	150	210	225	180	60	75	—	19	M12	9.0
BT50-BSB 25-135	25	52	135	150	92	50	20	22	8	M8	4.3
BT50-BSB 38-180	38	70	180	195	137	70	30	32	10	M10	4.9
BT50-BSB 50-180	50	90	180	195	137	85	40	44	13	M10	5.5
BT50-BSB 50-240	50	90	240	255	197	85	40	44	13	M10	5.8
BT50-BSB 62-195	62	115	195	210	152	95	50	56	16	M10	6.4
BT50-BSB 62-270	62	115	270	285	227	95	50	56	16	M10	7.8
BT50-BSB 72-195	72	135	195	210	152	110	60	66	19	M10	7.3
BT50-BSB 72-285	72	135	285	300	242	110	60	66	19	M10	9.6
BT50-BSB 90-210	90	150	210	225	167	130	75	80	19	M12	9.7
BT50-BSB 90-300	90	150	300	315	257	130	75	80	19	M12	12.8
BT50-BSB105-195	105	190	195	210	152	—	90	—	25	M12	11.4
BT50-BSB105-285	105	190	285	300	242	150	90	94	25	M12	15.7

粗镗刀适于通孔，也可用来反镗
 Boring Bar for rough cutting best suiting through-hole boring. Also app^o cable to counter bore spot facing.

BT-BSA 45° 斜角粗镗刀
BT-BSA 45° oblique angle rough boring tool

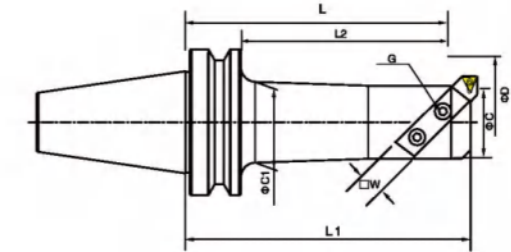

型号 Cat. No	范围 ϕD		L	L1	L2	L3	ϕC	$\phi C1$	W	G	净重 KG
	min	max									
BT30-BSA25-120	25	38	120	92	—	1	20	—	8	M6	0.8
BT30-BSA30-150	30	42	150	121	—	1.6	24	—	8	M6	1.0
BT30-BSA38-165	38	52	165	135	—	2.6	30	—	10	M8	1.4
BT30-BSA42-165	42	56	165	138	—	2	34	—	10	M8	1.7
BT40-BSA25-135	25	38	135	105	35	1	20	22	8	M6	1.4
BT40-BSA30-135	30	42	135	105	40	1.6	24	26	8	M6	1.6
BT40-BSA 38-165	38	52	165	133	50	2.6	30	33	10	M8	2.9
BT40-BSA42-180	42	56	180	148	60	2	34	37	10	M8	2.4
BT40-BSA50-165	50	65	165	133	65	3	40	44	13	M10	3.7
BT40-BSA50-210	50	65	210	178	65	3	40	44	13	M10	3.2
BT40-BSA62-165	62	90	165	133	—	2	50	—	16	M10	4.9
BT40-BSA62-225	62	90	225	193	80	2	50	56	16	M10	4.8
BT40-BSA72-165	72	110	165	—	—	2.4	60	—	19	M10	5.5
BT40-BSA72-225	72	110	225	—	—	2.4	60	—	19	M10	6.8
BT40-BSA90-165	90	125	165	133	60	4	75	—	19	M12	10.2
BT50-BSA25-135	25	38	135	92	35	1	20	22	8	M6	4.2
BT50-BSA30-165	30	42	165	122	40	1.6	24	26	8	M6	4.4
BT50-BSA38-180	38	52	180	137	50	2.6	30	33	10	M8	4.8
BT50-BSA42-210	42	56	210	167	60	2	34	37	10	M8	5
BT50-BSA50-180	50	65	180	137	65	3	40	44	13	M10	5.4
BT50-BSA50-240	50	65	240	197	65	3	40	44	13	M10	5.7
BT50-BSA62-195	62	90	195	152	80	2	50	56	16	M10	6.2
BT50-BSA62-270	62	90	270	227	80	2	50	56	16	M10	7.6
BT50-BSA72-195	72	110	195	152	95	2.4	60	66	19	M10	7
BT50-BSA72-285	72	110	285	242	95	2.4	60	66	19	M10	9.3
BT50-BSA90-210	90	125	210	167	110	4	75	80	19	M12	9.2
BT50-BSA90-300	90	125	300	257	110	4	75	80	19	M12	12.3
BT50-BSA105-195	105	160	195	—	—	3	90	—	25	M12	10.7
BT50-BSA105-285	105	160	285	—	130	3	90	94	25	M12	15

粗镗刀、适于通孔及盲孔加工
 滑槽与刀刃平行
 镗刀头单独订购
 注意D的最小尺寸与L、L1、L2

Boring Bar rough cutting beart suiting through-hole and blind hole borings
 • The same location of drive key and cunina edae.
 • Please order boring bite separately.
 • Dimensjon of L, L1, L2 criteria, when D is minimum dimension.

BSA 斜角型镗头
BSA bevel-type sugar head

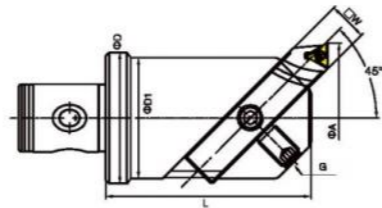

型号 Cat. No	镗孔范围 Boring Range		尺寸 Size					
	ΦA min	ΦA max	ΦD	$\Phi D1$	L	E	W	G
BSA30-LBK2	$\Phi 30$	$\Phi 42$	24	24	40	1.6	8	M6x1.00P
BSA38-LBK3	$\Phi 38$	$\Phi 52$	31	60	60	2.6	10	M8x1.25P
BSA50-LBK4	$\Phi 50$	$\Phi 65$	42	40	70	3	13	M10x1.50P
BSA62-LBK5	$\Phi 62$	$\Phi 90$	55	50	85	2	16	M12x1.75P
BSA72-LBK6	$\Phi 72$	$\Phi 110$	63	60	98	2.4	19	M12x1.75P

BSB 斜角型镗头
BSB bevel-type sugar head

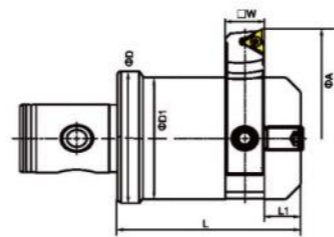

型号 Cat. No	镗孔范围 Boring Range		尺寸 Size					
	ΦA min	ΦA max	ΦD	$\Phi D1$	L	L1	W	G
BSB25-LBK2	$\Phi 26$	$\Phi 52$	24	20	45	10	8	M6x1.00P
BSB38-LBK3	$\Phi 38$	$\Phi 70$	31	30	55	10	10	M8x1.25P
BSB50-LBK4	$\Phi 50$	$\Phi 90$	42	40	60	10	13	M10x1.50P
BSB62-LBK5	$\Phi 62$	$\Phi 115$	55	50	70	12	16	M12x1.75P
BSB72-LBK6	$\Phi 72$	$\Phi 135$	63	60	85	12	19	M12x1.75P

CBS 刀夹
CBS turner

适用于BSA、BSB粗镗刀，适合重切削加工
For BSA, BSB coarse sugar cutter, suitable for heavy machining

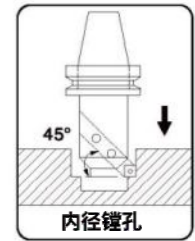
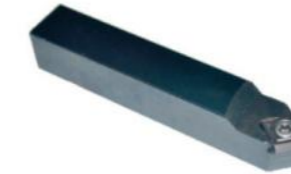

型号 Cat. No	D	L	角度 Angle	刀片规格 Insert	螺丝 Clamp Screw	扳手 Wrench
CBS-408	8	50	45°	CCMT0602	M2.5-6.0-3.5-60	T9
CBS-410	10	60		CCMT09T3	M4-10-5.7-60	T15
CBS-413	13	70				
CBS-416	16	100				
CBS-419	19	150				
CBS-425	25	150				
CBS-908	8	50	90°	CCMT0602	M2.5-6.0-3.5-60	T9
CBS-910	10	60		CCMT09T3	M4-10-5.7-60	T15
CBS-913	13	70				
CBS-916	16	100				
CBS-919	19	150				
CBS-925	25	150				

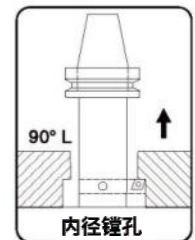
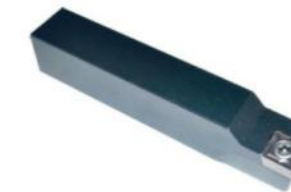
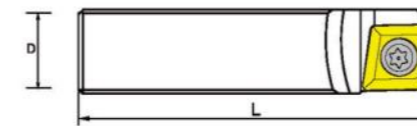

型号 Cat. No	D	L	角度 Angle	刀片规格 Insert	螺丝 Clamp Screw	扳手 Wrench
CBS908L	8	50	90°	CCMT0602	M2.5-6.0-3.5-60	T9
CBS910L	10	60		CCMT09T3	M4-10-5.7-60	T15
CBS913L	13	70				
CBS916L	16	100				
CBS919L	19	150				

SCF◇R/L

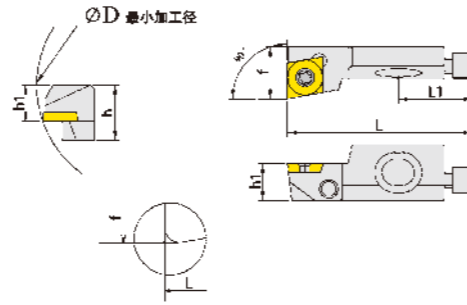

型号 Model		∅D	h	f	L	L1	h1	螺丝 Screw	螺丝GD Screw GD	螺丝TJLS Screw TJLS	螺丝DJ Screw DJ	扳手 Wrench
SCFPR/L 06CA-05	CP□□050204	20	8.5	8	25	12	6	M2.2*5	03510	03009	03006	T6
SCFCR/L 08CA-06	CC□□060204	25	10	10	32	17	8	M2.5*6	04016	04012	04008	T8
SCFCR/L 10CA-09	CC□□09T308	40	15	14	50	20	10	M3.5*8	06020			T15

SCG◇R/L

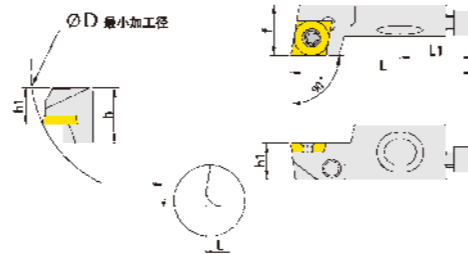

型号 Model		∅D	h	f	L	L1	h1	螺丝 Screw	螺丝GD Screw GD	螺丝TJLS Screw TJLS	螺丝DJ Screw DJ	扳手 Wrench
SCGPR/L 06CA-05	CP□□050204	20	8.5	8	25	12	6	M2.2*5	03510	03009	03006	T6
SCGCR/L 08CA-06	CC□□060204	25	10	10	32	17	8	M2.5*6	04016	04012	04008	T8
SCGCR/L 10CA-09	CC□□09T308	40	15	14	50	20	10	M3.5*8	06020	04012	04008	T15

SCL◇R/L

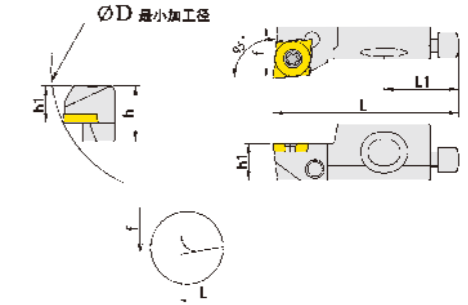

型号 Model		∅D	h	f	L	L1	h1	螺丝 Screw	螺丝GD Screw GD	螺丝TJLS Screw TJLS	螺丝DJ Screw DJ	扳手 Wrench
SCLPR/L 06CA-05	CP□□050204	20	8.5	8	25	12	6	M2.2*5	03510	03009	03006	T6
SCLCR/L 08CA-06	CC□□060204	25	10	10	32	17	8	M2.5*6	04016	04012	04008	T8
SCLCR/L 10CA-09	CC□□09T308	40	15	14	50	20	10	M3.5*8	06020			T15
SCLCR/L 12CA-12	CC□□120408	50	20	20	55	20	12	M5*12	06025	05014	04012	T20

S◇S◇R/L

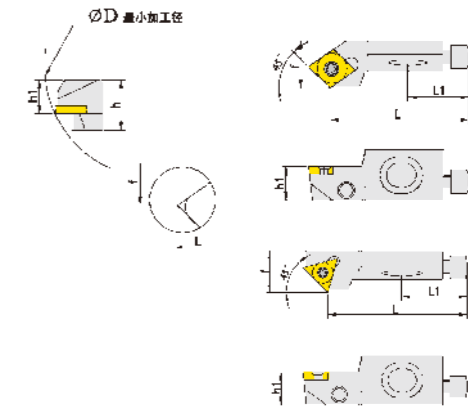

型号 Model		∅D	h	f	L	L1	h1	螺丝 Screw	螺丝GD Screw GD	螺丝TJLS Screw TJLS	螺丝DJ Screw DJ	扳手 Wrench
SCSPR/L 06CA-05	CP□□050204	20	8.5	8	21.4	12	6	M2.2*5	03510	03009	03006	T6
SCSCR/L 08CA-06	CC□□060204	25	10	10	28	17	8	M2.5*6	04016	04012	04008	T8
SCSCR/L 10CA-09	CC□□09T308	40	15	14	44	20	10	M3.5*8	06020	04012	04008	T15
STSCR/L 08CA-09	TC□□090204	25	10	10	33.5	17	8	M2.2*6	04016	04012	03006	T6
STSCR/L 10CA-11	TC□□110204	40	15	14	44	20	10	M2.5*6	06020	04012	04008	T8
STSCR/L 12CA-16	TC□□120408	50	20	20	47	20	12	M3.5*8	06025	05014	04012	T15
STSCR/L 16CA-16	TC□□16T308	55	21	25	53	25	16	M3.5*8	08030	06019	04012	T15

S◇KCR/L

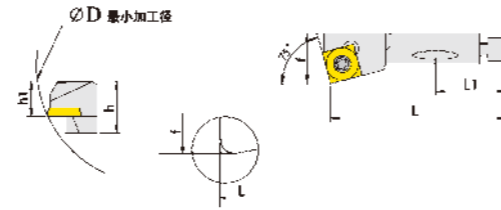

型号 Model		φD	h	f	L	L1	h1	螺丝 Screw	螺丝GD Screw GD	螺丝TJLS Screw TJLS	螺丝DJ Screw DJ	扳手 Wrench
SCKCR/L 08CA-06	CC□□060204	25	10	10	32	17	8	M2.5*6	04016	04012	03006	T8
SSKCR/L 10CA-09	SC□□09T308	40	15	14	50	20	10	M3.5*8	06020	04012	04008	T15
SSKCR/L 12CA-12	SC□□120408	50	20	20	55	20	12	M5*12	06025	05014	04012	T20
SSKCR/L 16CA-12	SC□□16T308	55	21	25	63	25	16	M5*12	08030	06019	04012	T20

SCW◇R/L

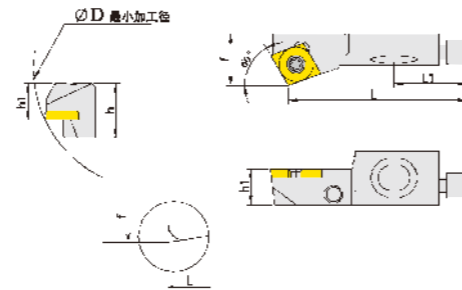

型号 Model		φD	h	f	L	L1	h1	螺丝 Screw	螺丝GD Screw GD	螺丝TJLS Screw TJLS	螺丝DJ Screw DJ	扳手 Wrench
SCWPR/L 06CA-05	CP□□050204	20	8.5	8	22.7	12	6	M2.2*5	03510	03009	03006	T6
SCWCR/L 08CA-06	CC□□060204	25	10	10	29	17	8	M2.5*6	04016	04012	03006	T8

STFCR/L

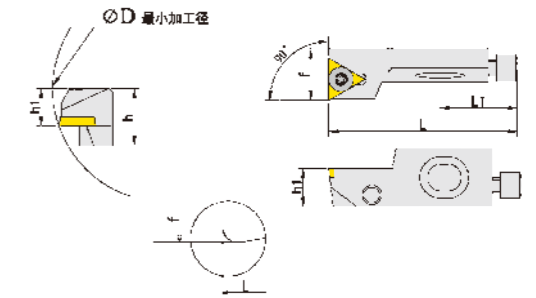

型号 Model		φD	h	f	L	L1	h1	螺丝 Screw	螺丝GD Screw GD	螺丝TJLS Screw TJLS	螺丝DJ Screw DJ	扳手 Wrench
STFCR/L 08CA-09	TC□□090204	25	10	10	32	17	8	M2.5*6	04016	04012	03006	T8
STFCR/L 10CA-11	TC□□110204	40	15	14	50	20	10	M2.5*6	06020	04012	04008	T8
STFCR/L 12CA-16	TC□□120408	50	20	20	55	20	12	M3.5*8	06025	05014	04012	T15
STFCR/L 16CA-16	TC□□16T308	55	21	25	63	25	16	M3.5*8	08030	06019	04012	T15

STGCR/L

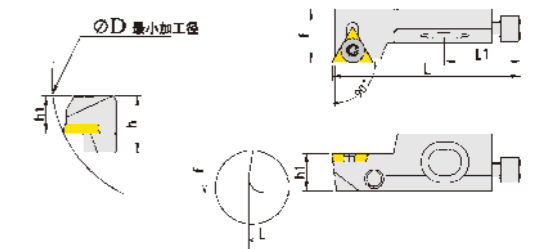

型号 Model		φD	h	f	L	L1	h1	螺丝 Screw	螺丝GD Screw GD	螺丝TJLS Screw TJLS	螺丝DJ Screw DJ	扳手 Wrench
STGCR/L 08CA-09	TC□□090204	25	10	10	32	17	8	M2.5*6	04016	04012	03006	T8
STGCR/L 10CA-11	TC□□110204	40	15	14	50	20	10	M2.5*6	06020	04012	04008	T8
STGCR/L 12CA-16	TC□□120408	50	20	20	55	20	12	M3.5*8	06025	05014	04012	T15
STGCR/L 16CA-16	TC□□16T308	55	21	25	63	25	16	M3.5*8	08030	06019	04012	T15

镗削刀具 | BORING TOOLS



模块式镗刀 Modular Boring Tool

STTCR/L

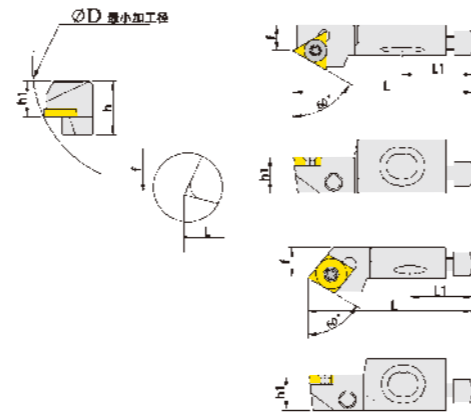

型号 Model		∅D	h	f	L	L1	h1	螺丝 Screw	螺丝GD Screw GD	螺丝TJLS Screw TJLS	螺丝DJ Screw DJ	扳手 Wrench
STTCR/L 10CA-11	TC□□110204	40	15	9	50	20	10	M2.5*6	06020	04012	04008	T8
STTCR/L 12CA-16	TC□□16T308	50	20	13	55	20	12	M3.5*8	06025	05014	04012	T15
STTCR/L 16CA-16	TC□□16T308	55	21	15	63	25	16	M3.5*8	08030	06019	04012	T15
SCTPR/L 06CA-05	CP□□050204	20	8.5	5.5	25	12	6	M2.2*5	03510	03009	03006	T6
SCTCR/L 08CA-06	CC□□060204	25	10	6	32	17	8	M2.5*6	04016	04012	03006	T8

STWCR/L

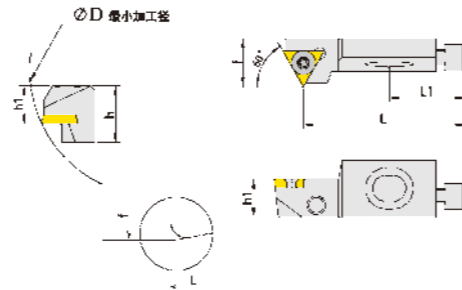

型号 Model		∅D	h	f	L	L1	h1	螺丝 Screw	螺丝GD Screw GD	螺丝TJLS Screw TJLS	螺丝DJ Screw DJ	扳手 Wrench
STWCR/L 10CA-11	TC□□110204	40	15	14	44	20	10	M2.5*6	06020	04012	04008	T8
STWCR/L 12CA-16	TC□□16T308	50	20	20	47	20	12	M3.5*8	06025	05014	04012	T15
STWCR/L 16CA-16	TC□□16T308	55	21	25	53	25	16	M3.5*8	08030	06019	04012	T15

目录 (四) CONTENTS

工具系统 页码提示

弹簧夹头刀柄 COLLET CHUCK ARBORS	P280~P285
接长杆 EXTENSION BAR	P286
强力铣夹头刀柄 POWER MILLING CHUCK ARBORS	P287~P288
侧固式刀柄 SIDE LOCK END MILL CHUCK	P289~P291
套式铣刀柄 SHELL END MILL ARBORS	P292~P296
有扁尾莫氏锥柄 MORSE TAPER WITH TANG	P297~P298
无扁尾莫氏锥柄 MORSE TAPER WITHOUT TANG	P299~P300
三面刃铣刀柄 TOOL SHANK FOR SIDE AND FACE MILLING CUTTER	P301~P302
工具系统附件 TOOL SYSTEM ACCESSORIES	P303~P309
工具系统技术信息 TOOL SYSTEM TECHNICAL INFORMATION	P310~P316

