

APPLICATIONS

Suitable for illumination of ports, shipyards, stadiums, airports, railways and other indoor or outdoor locations.



NTC9280A LED SPOTLIGHT



- LED light source featuring high luminous efficacy and energy saving
- Four types of light distributions, fulfilling requirements of different locations
- Suitable for seat mount, wall mount, ceiling mount and pendant mount, etc.
- Degree of protection: IP 65

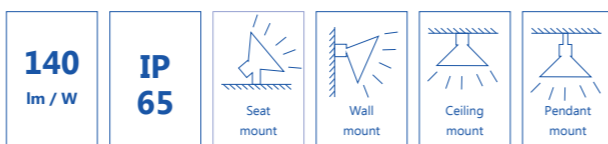

DIMENSION DRAWINGS

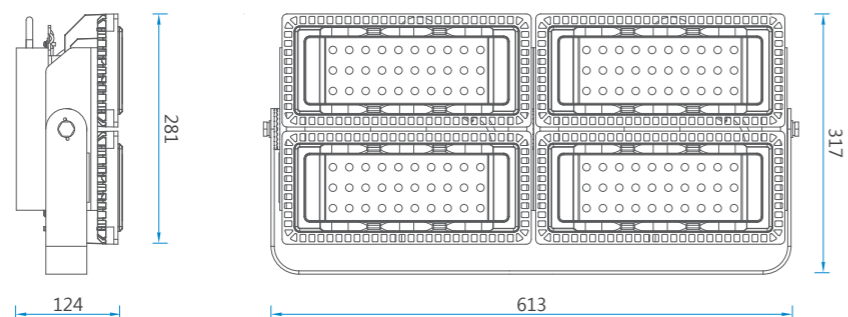

*all dimensions in mm

TECHNICAL DATA

Certification	
International approvals	SASO, CCC
Conformity to standards	IEC60598
Material	
Body material	Aluminum alloy with epoxy powder coating
Diffuser	Polycarbonate
Light source	
Brand	CREE
Wattage	410 W
Type	LED
Luminous flux	140 lm / W
Life	100000 h
Rated voltage	220 V - 240 V AC 50 Hz / 60 Hz
Class of insulation	Class I
Cable entry	G3/4
Operating temperature	-20 °C to +40 °C
Degree of protection	IP 65
Corrosion-proof class	WF2

PHOTOMETRIC DATA

NTC9280 LED 410 W photometric data
The data from CREE lamp
Luminous intensity distribution cd / 1000 lm

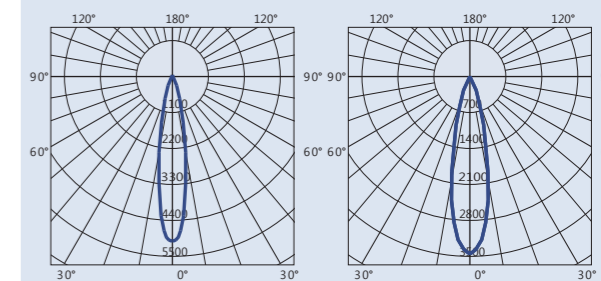

cd / 1000 lm Ratio of distance to height: 0.31
A1: 15° beam

cd / 1000 lm Ratio of distance to height: 0.39
A2: 25° beam

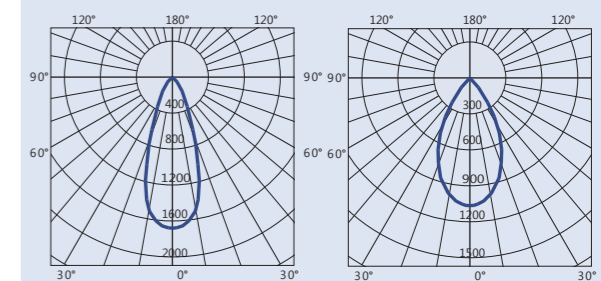

cd / 1000 lm Ratio of distance to height: 0.59
A3: 40° beam

cd / 1000 lm Ratio of distance to height: 0.75
A4: 60° beam

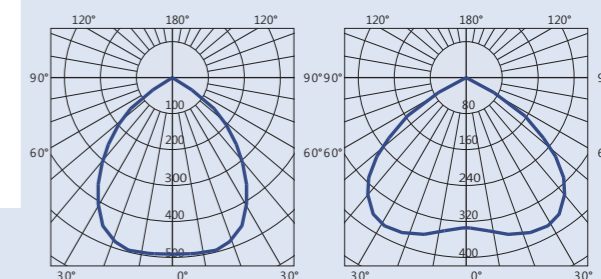

cd / 1000 lm Ratio of distance to height: 1.22
A5: 90° beam

cd / 1000 lm Ratio of distance to height: 1.55
A6: 110° beam

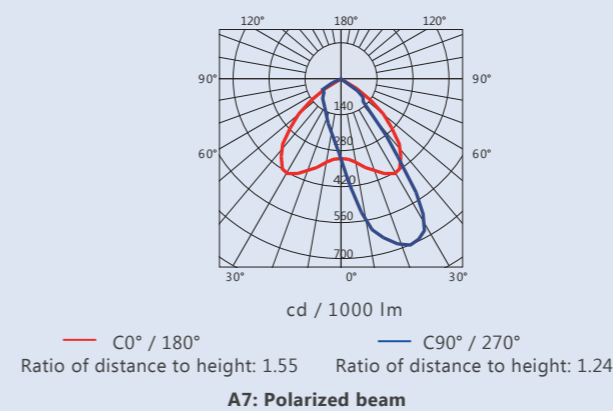

We can provide lighting design and data by professional lighting software based upon simulated site situation on request.

SELECTION TABLE

Model	Lamp power (W)	Lamp type (W)	Operating current (A)	Color temperature (K)	Weight (kg)
NTC9280A/410/LED	410	LED	0.35	5000 - 6500	16.8

MOUNTING TYPE

*all dimensions in mm

Seat mount

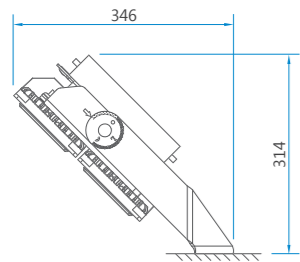

Wall mount

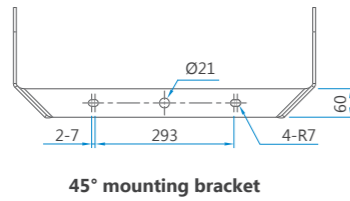
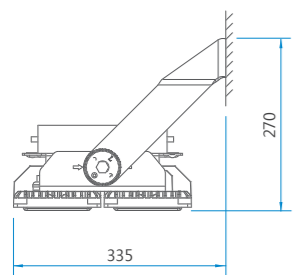

Accessories for seat mount and wall mount				
No.	Name	Spec.	Qty.	Remark
1	Expansion bolt (with nut, flat washer and spring washer)	M14 × 100	2	Provided by user
2	Accessory package for indoor mounting use		1	Accessories should be ordered separately.
3	45° mounting bracket for indoor mounting use		1	
4	U bracket for indoor mounting use		1	
5	Accessory package for outdoor mounting use		1	Accessories should be ordered separately.
6	45° mounting bracket for outdoor mounting use		1	
7	U bracket for outdoor mounting use		1	

Ceiling mount

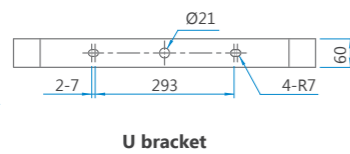
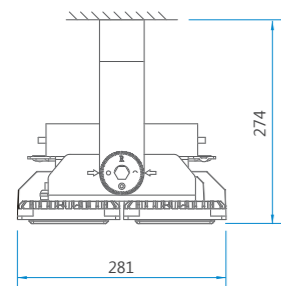

Accessories				
No.	Name	Spec.	Qty.	Remark
1	Expansion bolt (with nut, flat washer and spring washer)	M14 × 100	2	Provided by user
2	Accessory package for indoor mounting use		1	Accessories should be ordered separately.
3	U bracket for indoor mounting use		1	
4	Accessory package for outdoor mounting use		1	
5	U-bracket for outdoor mounting use		1	Accessories should be ordered separately.

Pendant mount

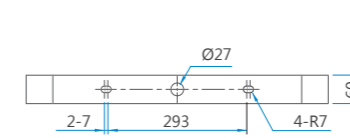
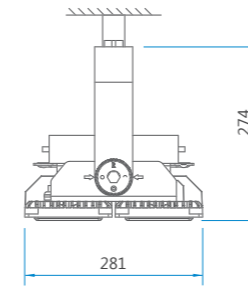

Pendant mounting bracket

Accessories				
No.	Name	Spec.	Qty.	Remark
1	Pipe	Ø26	2	Provided by user
2	Accessory package for indoor mounting use		1	Accessories should be ordered separately.
3	Pendant bracket for indoor mounting use		1	

SPARE PARTS

Name	Picture	Ordering code	Weight (KG)
Light source - 410 W		1305010062	0.114
LED driver		1311010366	0.752