

## ■ 外形尺寸图 (mm)

### PKCH直通接头

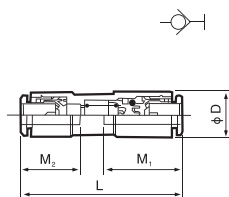

适用外径	型号	ΦD	L	M1	M2
Φ4	PKCH04-00	10.4	42.1	18	16
Φ6	PKCH06-00	12.8	45.8	19	17
Φ8	PKCH08-00	15.2	52.8	21.5	18.5
Φ10	PKCH10-00	18.5	59.8	24	21
Φ12	PKCH12-00	20.9	63.5	25.5	22

### PKCJ直通插管接头

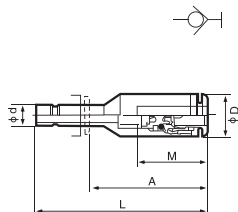

适用外径 mm	型号	Φd	ΦD	L	A	M
Φ4	PKCJ04-99	4	9.8	49.5	33.5	18
Φ6	PKCJ06-99	6	11.8	54	37	19
Φ8	PKCJ08-99	8	14	61	42.5	21.5
Φ10	PKCJ10-99	10	17	70.4	49.4	24
Φ12	PKCJ12-99	12	19	74.4	52.4	25.5

### PKCE隔板接头

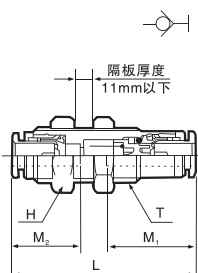

适用外径 mm	型号	T 外螺纹	H 六用对边	L	隔板安装孔	M1	M2
Φ4	PKCE04-00	M12X1	14	42	13	18	16
Φ6	PKCE06-00	M14X1	17	45.5	15	19	17
Φ8	PKCE08-00	M16X1	19	52.5	17	21.5	18.5
Φ10	PKCE10-00	M20X1	24	59.5	21	24	21
Φ12	PKCE12-00	M22X1	27	63.2	23	25.5	22

### PKCE内螺纹隔板接头

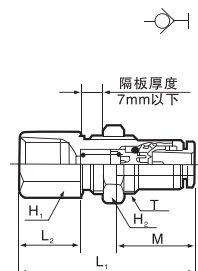

适用外径 mm	型号	螺纹	T (外螺纹)	H1 六用对边	H2 六用对边	L1	L2	隔板安装孔	M
Φ4	PKCE04-02	Rc1/4	M12X1	17	14	40.5	14.7	13	18
Φ6	PKCE06-02	Rc1/4	M14X1	17	17	42.7	14.7	15	19
Φ8	PKCE08-03	Rc3/8	M16X1	19	19	49.4	15	17	21.5
Φ10	PKCE10-03	Rc3/8	M20X1	22	24	53.9	14.2	21	24
Φ12	PKCE12-03	Rc3/8	M22X1	24	27	56.1	13.7	23	25.5

### PKCR插管接头

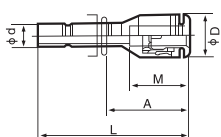

适用外径 mm	型号	Φd	ΦD	L	A	M
Φ4	PKCR04-99	4	9.8	40.6	22.6	16
Φ6	PKCR06-99	6	11.8	43.1	24.1	17
Φ8	PKCR08-99	8	14	46.7	25.2	18.5
Φ10	PKCR10-99	10	17	52.6	28.6	21
Φ12	PKCR12-99	12	19	84.9	29.4	22