

TP3100T100.00

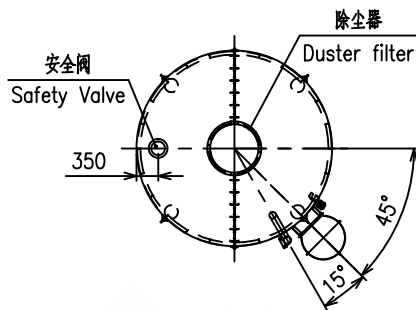

仓盖布置示意图
Layout of silo cover

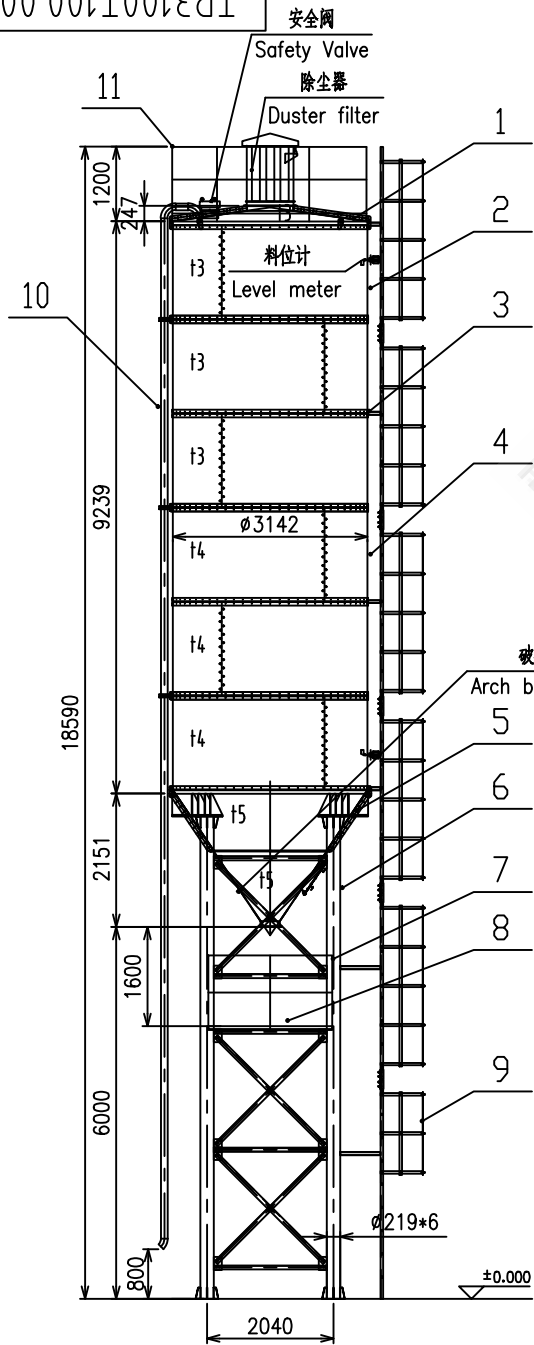
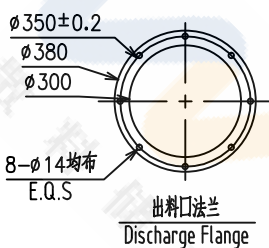

出料口法兰
Discharge Flange

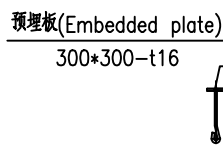

预埋板(Embedded plate)
300*300-t16
基础示意图(客户提供)
foundation(Provide by Customer)

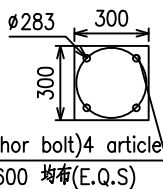

地脚螺栓(Anchor bolt)4 article
φ20,L=600 均布(E.Q.S)
埋板示意图(客户提供)
Embedded plate sketch drawing(Provide by Customer)

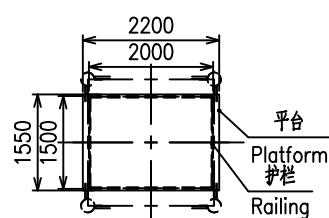

平台布置示意图
Layout of platform

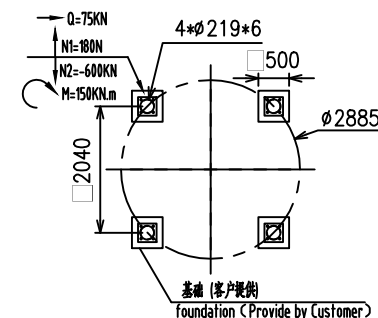

支腿布置示意图
Layout of leg

技术参数(Technical Parameter):

- 筒仓容量100T, 扣除500高料位装载95T, 装载效率94.9%, 密度按1.3t/m³计;
(Capacity 100T, Actual Capacity 95T, Volume Ratio 94.9%, Density 1.3t/m³);
- 底漆: 铁红环氧防锈底漆, 面漆: 丙烯酸面漆, 颜色业主定;
(Primer: Iron red epoxy antirust primer, Finish paint: pioner topcoat, Customer specified color);
- 使用条件: 压力<5KPa, 风压: 0.8KN/m².
(Use conditions: Pressure<5KPa, Wind pressure: 0.8KN/m².)

| 11 | TP3100T100.11 | 顶护栏(Silo top railing) | 1 | Q235B | | | | |
|-----------|---------------|---------------------------|-------------|----------------|--------------------------|-------------|------------|--|
| 10 | TP3100T100.10 | 进灰管(Feed pipe) | 1 | Q235B | | | | |
| 9 | TP3100T100.09 | 直爬梯(Straight ladder) | 1 | Q235B | | | | |
| 8 | TP3100T100.08 | 平台(Platform) | 1 | Q235B | | | | |
| 7 | TP3100T100.07 | 平台护栏(Platform railing) | 1 | Q235B | | | | |
| 6 | TP3100T100.06 | 支腿架(Leg assembly drawing) | 1 | Q235B | | | | |
| 5 | TP3100T100.05 | 锥体(Cone) | 1 | Q235B | | | | |
| 4 | TP3100T100.04 | 仓板2(Silo body plate1) | 6 | Q235B | | | | |
| 3 | TP3100T100.03 | T钢法兰(T type steel flange) | 5 | Q235B | | | | |
| 2 | TP3100T100.02 | 仓板1(body plate) | 6 | Q235B | | | | |
| 1 | TP3100T100.01 | 仓盖(Silo Cover) | 1 | Q235B | | | | |
| 序号 NO. | 代号 CODE | 名称/NAME | 数量 Q.T.Y | 材料 MATERIAL | 单重 S-WEIGHT 重量 WEIGHT | 总重 T-WEIGHT | 备注 MARK | |

方案图(Plan drawing)

厦门陆威工程机械有限公司
Xiamen Luwei Construction Equipment Co., Ltd.

TPφ3100-100T-H6000

| | | | | | | | |
|------------------------|---------|----|----|--------------|----|-----------|----------|
| 设计 Designer | 更改文件号 | 签字 | 日期 | 图样标记 | 版本 | 重量/Weight | 比例/Scale |
| 标准化 Standardization | | | | | | 0 | 1:80 |
| 标准化 Standardization | | | | Total Pages共 | 页 | Pages第 | 页 |
| 标准化 Standardization | 日期/Date | | | | | | |

借通用件登记

描图

B
校描

旧底图总号

签字

日期

A

B