

WP5700T400.0

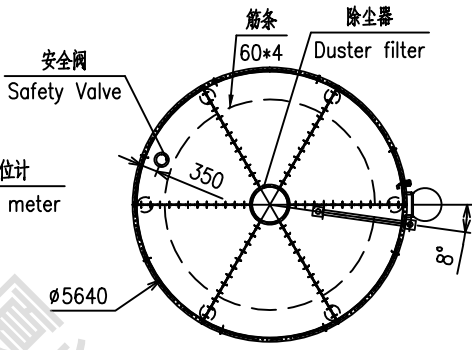

仓盖布置示意图
Layout of silo cover

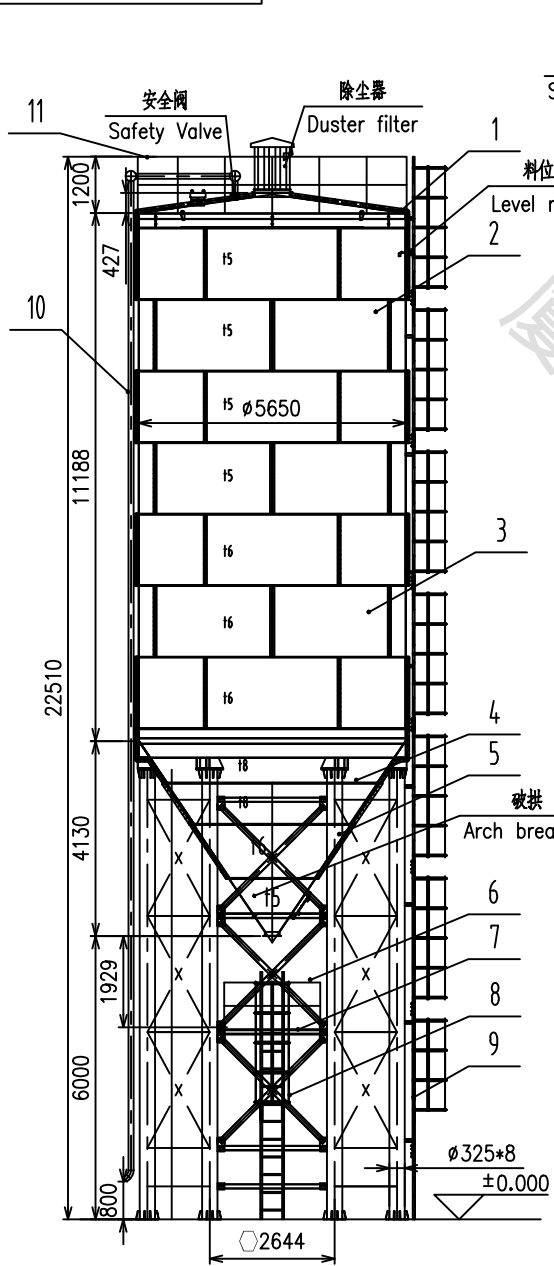
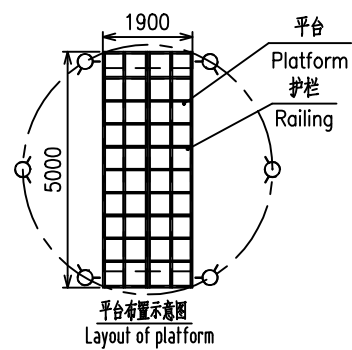

平台布置示意图
Layout of platform

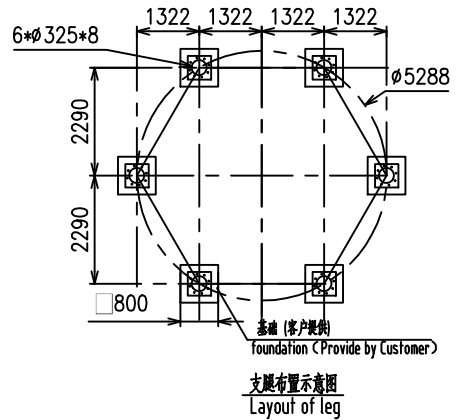

支腿布置示意图
Layout of leg

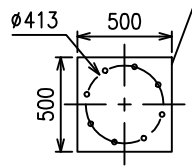
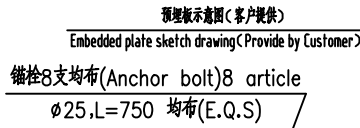
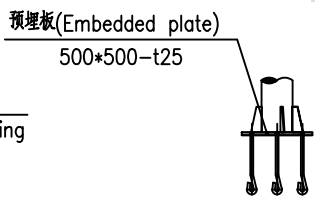
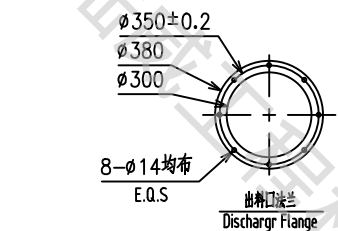

技术参数(Technical Parameter):

- 筒仓容量410T(315m³), 扣除500高料位装载393T(302m³), 装载效率96.0%, 密度按1.3t/m³计; (Capacity 410T(315m³), Actual Capacity 393T(302m³), Volume Ratio 96.0%, Density 1.3t/m³);
- 底漆: 铁红环氧防锈底漆, 面漆: 丙烯酸面漆, 颜色业主定; (Primer: Iron red epoxy antirust primer, Finish paint: pionic topcoat, Customer specified color);
- 使用条件: 压力<5KPa, 风压: 0.8KN/m². (Use conditions: Pressure<5KPa, Wind pressure: 0.8KN/m².)

11	WP5700T400.11	顶护栏(Silo top railing)	1	Q235B			
10	WP5700T400.10	进灰管(Feed pipe)	1	Q235B			
9	WP5700T400.9	仓顶爬梯(Top Straight ladeer)	1	Q235B			
8	WP5700T400.8	平台爬梯(Platform Straight ladeer)	1	Q235B			
7	WP5700T400.7	平台(Platform railing)	1	Q235B			
6	WP5700T400.6	平台扶手(Platform railing)	1	Q235B			
5	WP5700T400.5	支腿架(Leg assembly drawing)	1	Q235B			
4	WP5700T400.4	锥体(Cone)	1	Q235B			
3	WP5700T400.3	仓板2(Silo body plate 2)	12	Q235B			
2	WP5700T400.2	仓板1(Silo body plate 1)	16	Q235B			
1	WP5700T400.1	仓盖(Silo cover)	1	Q235B			
序号 NO.	代号 CODE	名称/NAME	数量 Q.T.Y	材料 MATERIAL	单重 S-WEIGHT 重量 WEIGHT	总重 T-WEIGHT	备注 MARK

方案图(Plan drawing) 厦门陆威工程机械有限公司
Xiamen Luwei Construction Equipment Co., Ltd.

WPφ5700-400T-H6000

WP5700T400.0

设计 Designer	标准化 Standardization	图样标记	版本	重量/Weight	比例/Scale
标准化 Standardization	标准化 Standardization			0	1:105
日期/Date		Total Pages共	页	Pages第	页

借通用件登记
描图
B校描
旧底图总号
签字
日期