

FJ12 SERIES

PRODUCT FEATURES

»

- Compact design, easy to be mounted side by side
- Fingertip-operated, single axis, spring return
- Non-cintacting hall effect technology, high reliability, long service life
- Supply voltage 5V or 9-32Vdc

MARKET FOCUS

»

- Control panel of various construction machinery
- Control panel and armrest box of material handling machinery
- Industrial remote controller



Single axis fingertip joystick

TECHNICAL SPECIFICATIONS

» » » » » » » » » »

Mechanical data

Travel angle: $\pm 30^\circ$
 Mechanical life: >500 million cycles
 Operating force: 2-5N
 Maximum allowable force: 140N
 Weight: Appr. 35g

Electrical data

Supply voltage: 5.0 ± 0.5 Vdc or 9~32Vdc
 Power current consumption: <11mA (per channel)
 Center voltage: 2.5 ± 0.1 V
 Output linearity tolerance: $\pm 3\%$
 Maximum overload voltage: 20Vdc
 Maximum Reverse voltage: -10Vdc
 Load resistance: >10K Ω
 Insulation resistance: >1000M Ω
 EMC: 100V/m

Environmental data

Operating temperature -20°C ~ +70°C	Storage temperature -40°C ~ +85°C	Protection class (IP) IP65 (above the panel)
--	--------------------------------------	--

SHAPE DIMENSIONS

» » » » » » » » » »

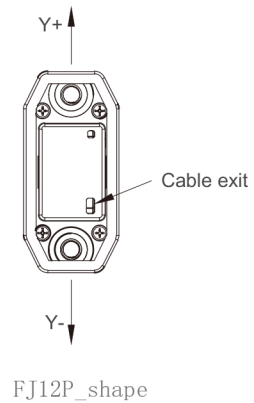
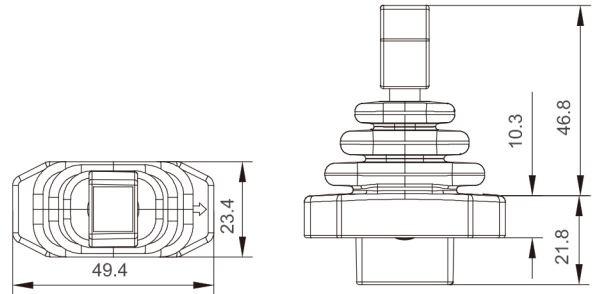

ORDERING CODES

» » » » » » » » » »

FJ12 -① -②

① Output signal

- H11 Supply voltage 5Vdc, 0.5~4.5V ratiometer output
- H21 Supply voltage 5Vdc, 0.5~4.5V and 4.5~0.5V redundant ratiometer output
- W11 Supply voltage 9~32Vdc, 0.5~4.5V ratiometer output
- W21 Supply voltage 9~32Vdc, 0.5~4.5V and 4.5~0.5V redundant ratiometer output

② Wiring

- L Cable wiring (AF200, 28#, length 300mm)

FJ12

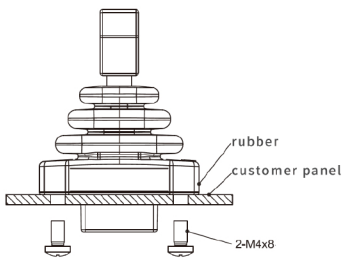

Installation diagram

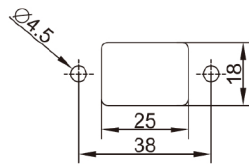

panel cut-out



FJ12P_installation

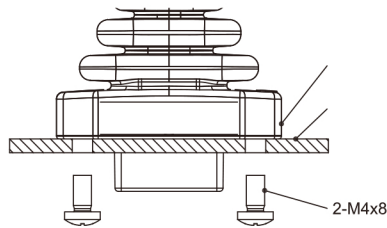

Installation diagram

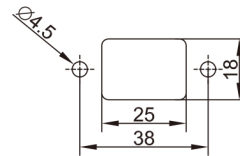

Panel cut-out

Note: it is recommended that the thickness of the client's panel be $\leq 3\text{mm}$

ELECTRICAL CONNECTIONS » » » » » » » » » »

Function description		
Color	Hall Effect	Redundant hall effect
Red	5Vdc	9~32Vdc
Black	0Vdc	0Vdc
Purple	---	5Vdc
Yellow	A-out	A-out
Green	---	B-out

OUTPUT SIGNAL CURVE » » » » » » » » » »

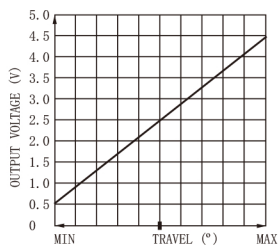

H11/W11

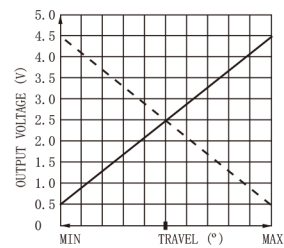

H21/W21