

Specification RHEA I.893A

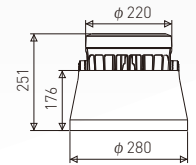

Features

- I.893A is an ultra-high power LED in-ground light;
- The irradiation height can reach more than 30 meters;
- Optional beam angles: 6.5°, 10°, 15°, 25°, 40°, 60°;
- 2 or 3 kinds of lenses are arranged inside the lamp body to make the illumination effect more uniform, the different light emitting color is available, such as single color, single color brightness changing, double color, RGB and so on;
- After installed, it can be rotated 360° horizontally and ±15° vertically by adjusting the external dial without disassembly;
- Applicable for parks, community squares, hilly landscapes and other occasions.

Technical Data

Model	I.893A.10.0045.006	I.893A.10.0068.010	I.893A.10.0068.015	I.893A.10.0068.025	I.893A.10.0068.040	I.893A.10.0068.060
Rated Power	45W	68W	68W	68W	68W	68W
LED Source	OSRAM 3535	OSRAM 3535	OSRAM 3535	OSRAM 3535	OSRAM 3535	OSRAM 3535
LED QTY	18	30	30	30	30	60
Beam Angle	6.5°	10°	15°	25°	40°	60°
Control Mode	single color ON/OFF, single color changing, RGB					
CRI	CRI 70					
Dimension	Ø300*247mm					
Weight	6.0KG					
Input Voltage	AC176~265V 50/60Hz					
Material	Die-casting Aluminum					
Lifespan	50000H					
Ambient Temperature	-20°C~+40°C					
Ambient humidity	10%~95%RH					
Security Level	CLASS I					
Ingress Protection	IP67					

Model	Emitting Color			Emitting Color			RGB
	3000K (Single Color ON/OFF)	4000K (Single Color ON/OFF)	5000K (Single Color ON/OFF)	3000K (Single Color Changing)	4000K (Single Color Changing)	5000K (Single Color Changing)	
I.893A.10.0045.006	3232	3998	4225	2974	3678	3887	1748
I.893A.10.0068.010	4279	5292	5592	3937	4869	5145	2060
I.893A.10.0068.015	3045	3766	3980	2801	3465	3662	1453
I.893A.10.0068.025	4222	5222	5518	3884	4804	5077	2034
I.893A.10.0068.040	3603	4456	4709	3315	4100	4332	2509
I.893A.10.0068.060	4471	5530	5844	4113	5088	5376	2140

I.893A.10.0045.006.W4.02			
H(m)	D(m)	Eav(lx)	Ecen(lx)
8.0	0.78	2641	2621
16.0	1.56	660	665
24.0	2.34	293	296
32.0	3.12	165	167
40.0	3.90	105	106
48.0	4.68	74	77

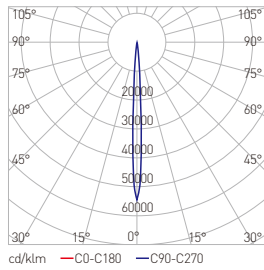

I.893A.10.0068.010.W4.02			
H(m)	D(m)	Eav(lx)	Ecen(lx)
4.0	0.63	3346	4289
8.0	1.26	836	1073
12.0	1.89	371	477
16.0	2.52	209	268
20.0	3.15	133	172
24.0	3.78	93	119

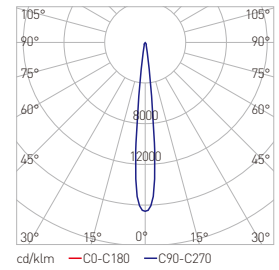

I.893A.10.0068.015.W4.02			
H(m)	D(m)	Eav(lx)	Ecen(lx)
4.0	0.9	2393	3358
8.0	1.8	598	840
12.0	2.7	266	373
16.0	3.6	150	210
20.0	4.5	93	134
24.0	5.4	66	94

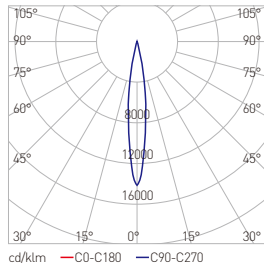

I.893A.10.0068.025.W4.02			
H(m)	D(m)	Eav(lx)	Ecen(lx)
4.0	1.7	722	989
8.0	3.4	180	247
12.0	5.1	80	110
16.0	6.8	45	62
20.0	8.5	29	40
24.0	10.2	20	27

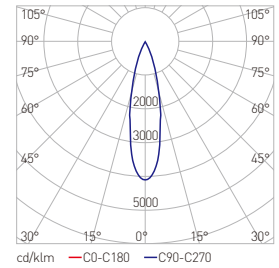

I.893A.10.0068.040.W4.02			
H(m)	D(m)	Eav(lx)	Ecen(lx)
4.0	2.14	595	873
8.0	4.28	149	218
12.0	6.42	66	97
16.0	8.56	37	54
20.0	10.70	24	35
24.0	12.84	16	25

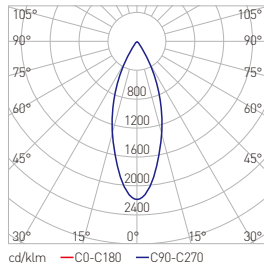

I.893A.10.0068.060.W4.02			
H(m)	D(m)	Eav(lx)	Ecen(lx)
4.0	4.08	207	383
8.0	8.16	52	96
12.0	12.24	23	43
16.0	14.28	17	31
20.0	20.40	9	15
24.0	24.48	6	11

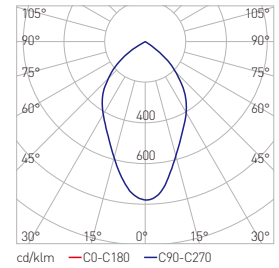

Encoding Rule Example: I.893A.10.0045.006.W3.02

Product Type	Product Code	Classification	Light Source	Rated Power	Beam Angle	Emitting Color	Input Voltage
I: In-ground Light	893	A	10: LED	0045: 45W 0068: 68W	006: 6.5° 010: 10° 015: 15° 025: 25° 040: 40° 060: 60°	W3: 3000K W4: 4000K W5: 5000K RGB	02: AC176V~265V

Accessories (buy separately)



angled hood

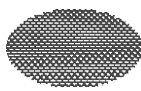

honeycomb

Optional light color:

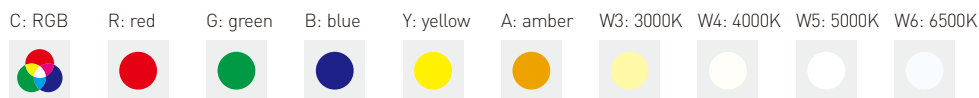

Changzhou Green Lighting Co., Ltd.

No.269 Fumin Rd, Economic Development Zone, Changzhou, China
 Tel: +86 519 88406000 88411399
 Fax: +86 519 88406100
 Email: green@china-greenlighting.com