

## Product features

- DORIS L.528Fseries wall washer lights are small ,compact and easy to hide, which is suitable for building facades, bridges and other lighting applications;
- Brand LED chip design, stable highlight, low energy consumption, low light decay, uniform light output;
- Multiple beam angle and colors optional;
- 6063 aluminum alloy body, high-pressure die-casting aluminum end caps, with 500 hours anti-salt spray corrosion spraying treatment ,which can effectively resist UV and harsh environment corrosion;
- 2 different installation brackets are suitable for wall installation ,facade installation and other installation conditions, convenient for site installation, adjustment and maintenance;
- The Angle of the mounting bracket can be rotated freely, which can easily fill the light and meet different needs of lighting;
- Metal waterproof solid joint, strong and durable, which is convenient for the connection of on-site lamps, adopting seamless splicing design, lamps are connected without dark area;
- Ingress Protection is up to IP66.



## The light shield

The light shield is optional , which can effectively prevent the overflow of light, With uniform light and itavoid glare.

## Durable

6063 aluminum alloy profile, surface 500 hours salt spray corrosion resistance spraying process;

Equipped with metal cable gland, with tight rubber ring inside, safe and waterproof,which extend the whole life of the lamp.



Model	L.528F.10.0009	L.528F.10.0012	L.528F.10.0018	L.528F.10.0024
Rated Power	9W	12W	18W	24W
LED Type	3030	3030	3030	3030
LED QTY	9	12	18	24
CRI	CRI ≥70	CRI ≥70	CRI ≥70	CRI ≥70
PF	≥0.9	≥0.9	≥0.9	≥0.9
CCT	3000K/4000K/5000K	3000K/4000K/5000K	3000K/4000K/5000K	3000K/4000K/5000K
Beam Angle	20°/20°*40°	20°/20°*40°	20°/20°*40°	20°/20°*40°
Dimension	L500*W47*H37mm	L500*W47*H37mm	L1000*W47*H37mm	L1000*W47*H37mm
Weight	0.8KG	0.8KG	1.6KG	1.6KG
Input Voltage	DC24V			
Control Mode	Single color ON/OFF			
Material	6063 Aluminum alloy			
Lifespan	50000H			
Ambient Temperature	-20°C~40°C			
Ambient humidity	10%-95%RH			
Security Level	CLASS III			
Ingress Protection	IP66			

Light Color Model	3000K (Single color ON/OFF)	4000K (Single color ON/OFF)	5000K (Single color ON/OFF)
L.528F.10.0009.020.01.050	705	705	757
L.528F.10.0009.2040.01.050	705	705	757
L.528F.10.0012.020.01.050	940	940	1009
L.528F.10.0012.2040.01.050	940	940	1009
L.528F.10.0018.020.01.100	1409	1409	1514
L.528F.10.0018.2040.01.100	1409	1409	1514
L.528F.10.0024.020.01.100	1879	1879	2018
L.528F.10.0024.2040.01.100	1879	1879	2018

Light Distribution Curve

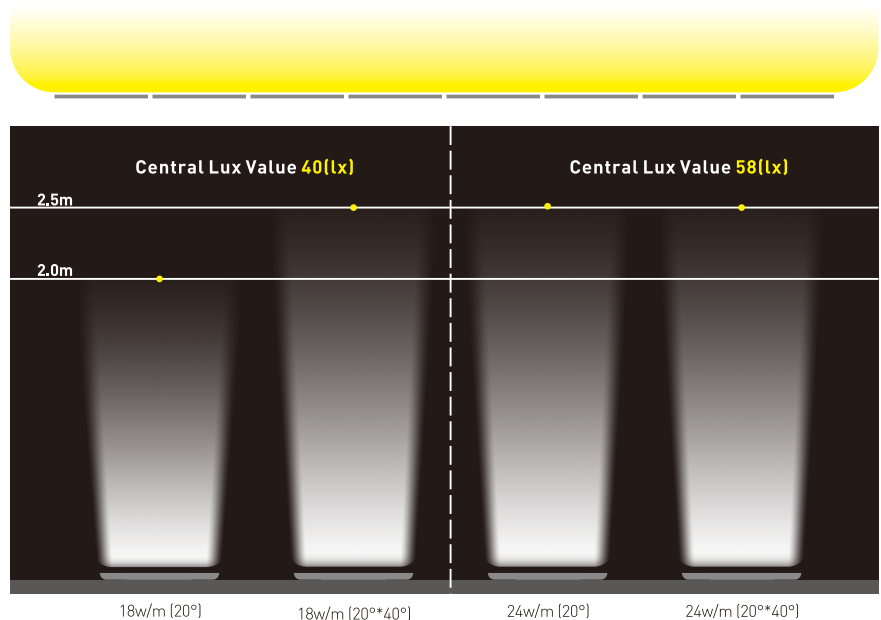
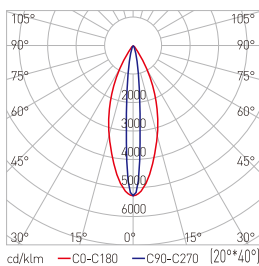
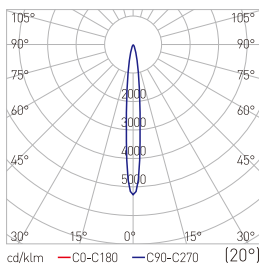

Unit: mm

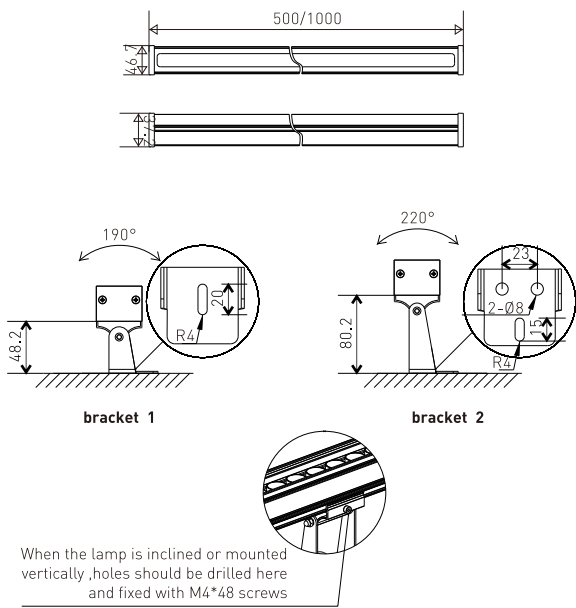

1. Drill three Ø7 holes (bracket 1 only need one hole) onto the mounting surface with a percussion drill, insert the plastic expansion tube, use a screwdriver to tighten the mounting screws (Recommend ST6.3\*32 stainless steel self-tapping screws)

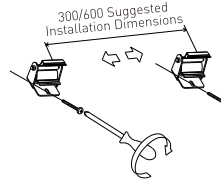

2.a Clap one side of the connecting buckle to the lamp body  
b Press the lamp body along the arrow direction to lock the lamp body into the connecting buckle.

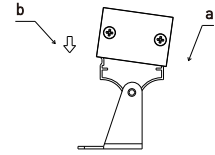

3. Rotate it to the right Angle as required

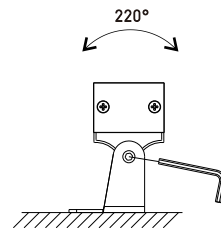

4. Installation is complete

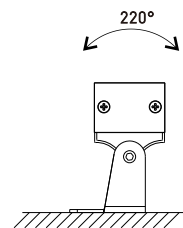

**Encoding Rule** Example: L.528F.10.0024.2040.W3.01.100

Product Type	Product Code	Classification	Light Source	Rated Power	Beam Angle	Emitting Color	Input Voltage
L: Wall Washer	528	F	10: LED	0009: 9W 0012: 12W 0018: 18W 0024: 24W	020: 20° 2040: 20°*40°	W3: 3000K W4: 4000K W5: 5000K	01: DC24V

**Additional instructions:**

1) Wall washer, ".XXX" is added as luminaire length after item 7 number  
100=1000mm, 050=500mm, 025=250mm, and so on.

Example: L.528F.10.0024.2040.W3.01.100 which means: LED wall washer is with 1000mm length/24W/20° \*40° /3000K/24VDC

**Accessories (Sold Separately) :**

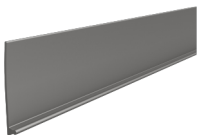

Light Shield

**Color Options:**

C: RGB R: red G: green B: blue Y: yellow A: amber W3: 3000K W4: 4000K W5: 5000K W6: 6500K



**Changzhou Green Lighting Co., Ltd.**

No.269 Fumin Rd, Economic Development Zone, Changzhou, China  
Tel: +86 519 88406000 88411399

Fax: +86 519 88406100

Email: green@china-greenlighting.com